



# STOW POLICE DEPARTMENT

PRIVATE PROPERTY ACCIDENT REPORT/MINOR  
TRAFFIC ACCIDENT REPORT

INCIDENT NUMBER

24-11154

DATE

7/13/2024

TIME

14:34

 Private Property   
  Private Property - Hit/Skip   
  Minor Traffic Accident

LOCATION - ADDRESS

3844 Wyndham Ridge Drive

DRIVER #1 - NAME (Last, First, Middle)

Gata, Kara, Renee

PHONE

330 234 718 0460

ADDRESS

3844 Wyndham Ridge Dr #206 Stow

CITY

STATE

ZIP

OH 44224

SSN

DATE OF BIRTH

11/30/1998

DRIVER'S LICENSE NUMBER

STATE

OH

VEHICLE #1

OWNER #1 - NAME (Last, First, Middle)

 SAME AS DRIVER #1

PHONE

ADDRESS

CITY

STATE

ZIP

SSN

DATE OF BIRTH

DRIVER'S LICENSE NUMBER

STATE

VEHICLE LICENSE#

JVL 3648

STATE

OH

YEAR

2017

MAKE

Toyota

MODEL

Corolla

COLOR

Blue

INSURANCE COMPANY

State Farm

POLICY NUMBER

400 844 3-SFP-35

PARTS OF VEHICLE DAMAGED

Front end damage

CONTRIBUTING CIRCUMSTANCES

None

VEHICLE #2

DRIVER #2 - NAME (Last, First, Middle)

Yousef Nowfal Samkari

PHONE

(330) 391 3240

ADDRESS

3890 Wyndham Ridge Dr #206

CITY

Stow

STATE

OH

ZIP

44224

SSN

DATE OF BIRTH

08/05/2003

DRIVER'S LICENSE NUMBER

STATE

OH

OWNER #2 - NAME (Last, First, Middle)

 SAME AS DRIVER #2

PHONE

ADDRESS

CITY

STATE

ZIP

SSN

DATE OF BIRTH

DRIVER'S LICENSE NUMBER

STATE

VEHICLE LICENSE #

KIN 2918

STATE

OH

YEAR

2001

MAKE

Ford

MODEL

F-150

COLOR

RED

INSURANCE COMPANY

Root Insurance

POLICY NUMBER

4D TK 68

PARTS OF VEHICLE DAMAGED

None

CONTRIBUTING CIRCUMSTANCES

backed into vehicle 1

DESCRIBE WHAT HAPPENED

Vehicle 1 and vehicle 2 were both parked near the curb to take out their trash. vehicle 1 was parked behind vehicle 2. vehicle 2 went to leave and backed into vehicle 1

See Reverse Side for Diagram

SUBMITTED BY:

Lyberger #772

DATE

7/14/2024

APPROVING OFFICER:

j. 76

DATE

7/14/24

# STOW POLICE DEPARTMENT

## FIELD SKETCH (not drawn to scale)

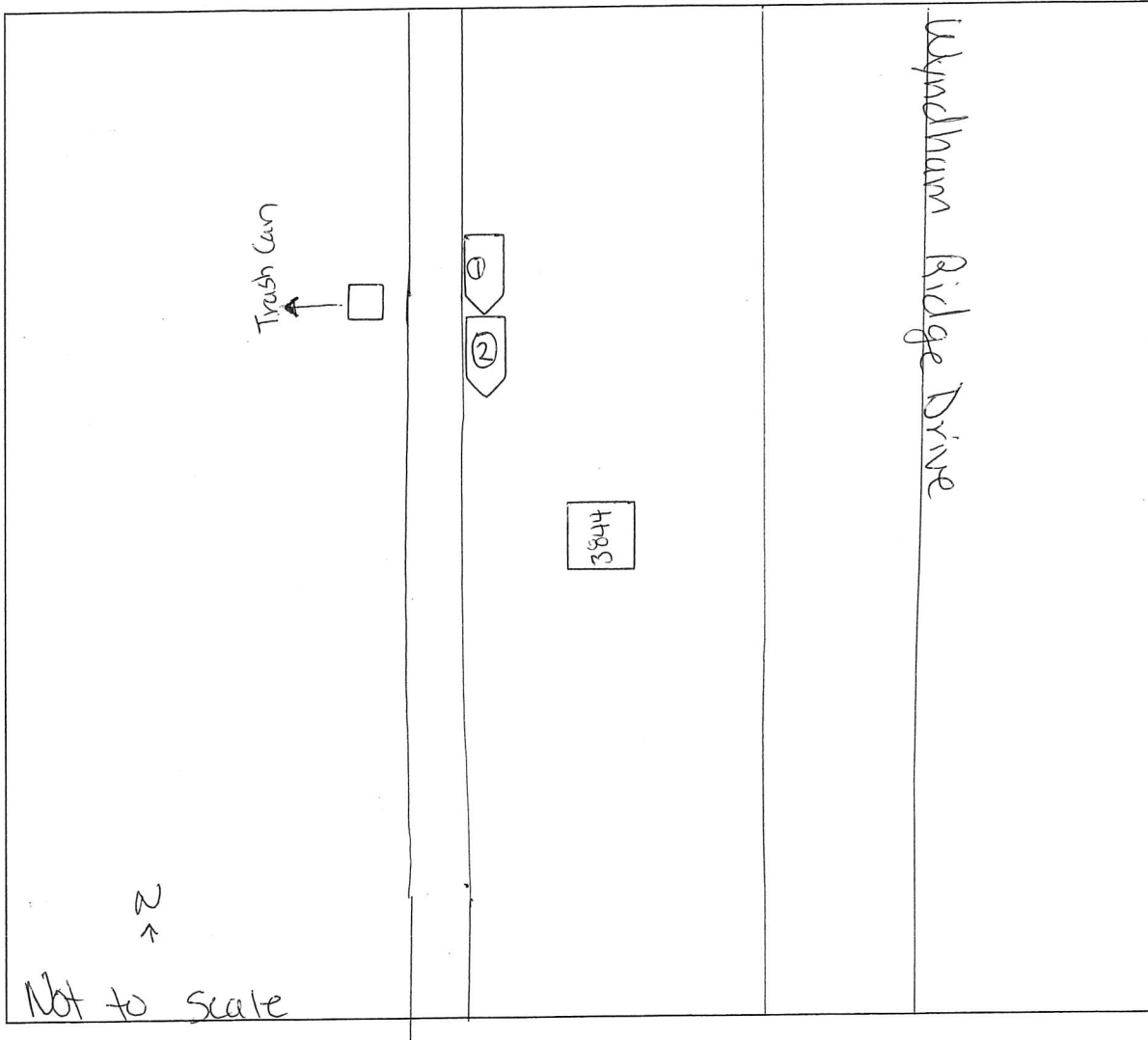

### WEATHER

- CLEAR
- RAIN
- SNOW
- FOG
- OTHER

### LIGHT

- DAYLIGHT
- DAWN
- DUSK
- DARK - LIGHTED ROAD
- DARK - NOT LIGHTED
- DARK - UNK LIGHTING
- UNKNOWN

### SURFACE

- DRY
- WET
- SNOW
- ICE
- OTHER

### ROAD

- CONCRETE
- BLACKTOP
- DIRT
- OTHER



# STOW POLICE DEPARTMENT

PRIVATE PROPERTY ACCIDENT REPORT/MINOR  
TRAFFIC ACCIDENT REPORT

INCIDENT NUMBER

24-11154

DATE

7/13/24

TIME

 Private Property     Private Property - Hit/Skip     Minor Traffic Accident

LOCATION - ADDRESS

DRIVER #1 - NAME (Last, First, Middle)

GATTA, KARA

PHONE

ADDRESS

CITY

STATE

ZIP

SSN

DATE OF BIRTH

DRIVER'S LICENSE NUMBER

STATE

OWNER #1 - NAME (Last, First, Middle)     SAME AS DRIVER #1

PHONE

ADDRESS

CITY

STATE

ZIP

SSN

DATE OF BIRTH

DRIVER'S LICENSE NUMBER

STATE

VEHICLE LICENSE#

STATE

YEAR

MAKE

MODEL

COLOR

INSURANCE COMPANY

POLICY NUMBER

PARTS OF VEHICLE DAMAGED

CONTRIBUTING CIRCUMSTANCES

DRIVER #2 - NAME (Last, First, Middle)

PHONE

ADDRESS

CITY

STATE

ZIP

SSN

DATE OF BIRTH

DRIVER'S LICENSE NUMBER

STATE

OWNER #2 - NAME (Last, First, Middle)     SAME AS DRIVER #2

PHONE

ADDRESS

CITY

STATE

ZIP

SSN

DATE OF BIRTH

DRIVER'S LICENSE NUMBER

STATE

VEHICLE LICENSE #

STATE

YEAR

MAKE

MODEL

COLOR

INSURANCE COMPANY

POLICY NUMBER

PARTS OF VEHICLE DAMAGED

CONTRIBUTING CIRCUMSTANCES

DESCRIBE WHAT HAPPENED

Unit 01 was parked behind Unit 02. Unit 02 began to reverse so he could leave and hit the passenger side back tire on Unit 01.

-Unit 01 updated statement (OH-3 attached)

See Reverse Side for Diagram

SUBMITTED BY:

Lyberger #172

DATE

7/27/24

APPROVING OFFICER:

J.A. #117

DATE

7.27.24

# STOW POLICE DEPARTMENT

FIELD SKETCH (not drawn to scale)

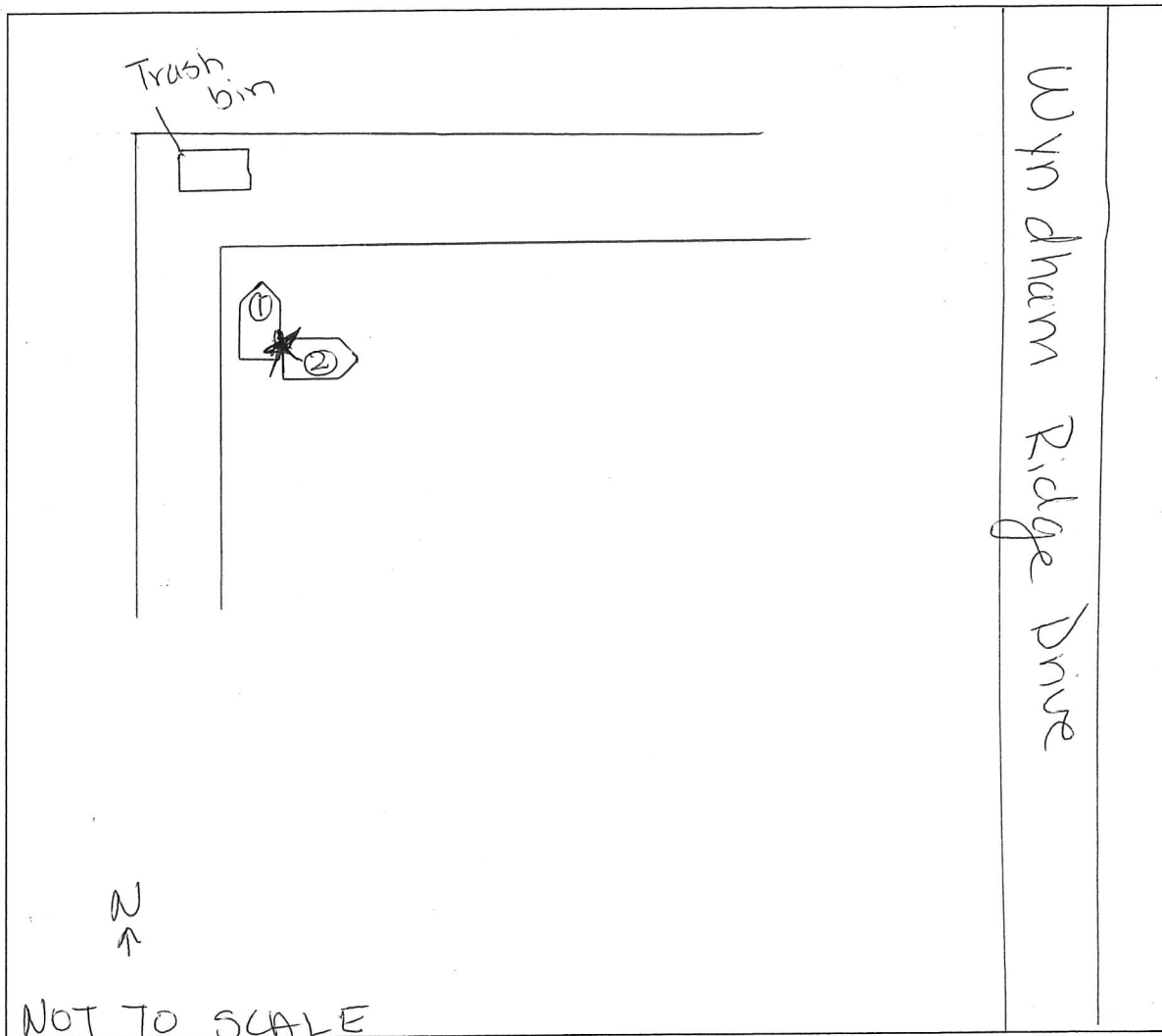

## WEATHER

- CLEAR
- RAIN
- SNOW
- FOG
- OTHER

## LIGHT

- DAYLIGHT
- DAWN
- DUSK
- DARK - LIGHTED ROAD
- DARK - NOT LIGHTED
- DARK - UNK LIGHTING
- UNKNOWN

## SURFACE

- DRY
- WET
- SNOW
- ICE
- OTHER

## ROAD

- CONCRETE
- BLACKTOP
- DIRT
- OTHER



LOCAL REPORT NUMBER 24-11154	REPORTING AGENCY Stow PD	DATE OF CRASH M 7   D 13   Y 24
---------------------------------	-----------------------------	------------------------------------

FOR LOCAL USE ONLY - DO NOT SUBMIT TO THE STATE EXCEPT FOR FATAL CRASHES

I, Kara Gatta HEREBY MAKE THIS VOLUNTARY STATEMENT TO  
PRINTED

AT Stow  
OFFICER'S NAME LOCATION

My fiancé and I were taking out the trash. I parked behind the other person. The other person while leaving backed up without looking and hit the metal area above my passenger side back tire with his truck.

A Drawing of accident is on the back

ADDRESS OF WITNESS 3844 Wyndham Ridge Dr. Apt 208 Stow, Oh 44224

SIGNATURE OF WITNESS X <u>Kara Gatta</u>	OFFICER'S SIGNATURE X <u>Dana Hyberger # 772</u>
---	---

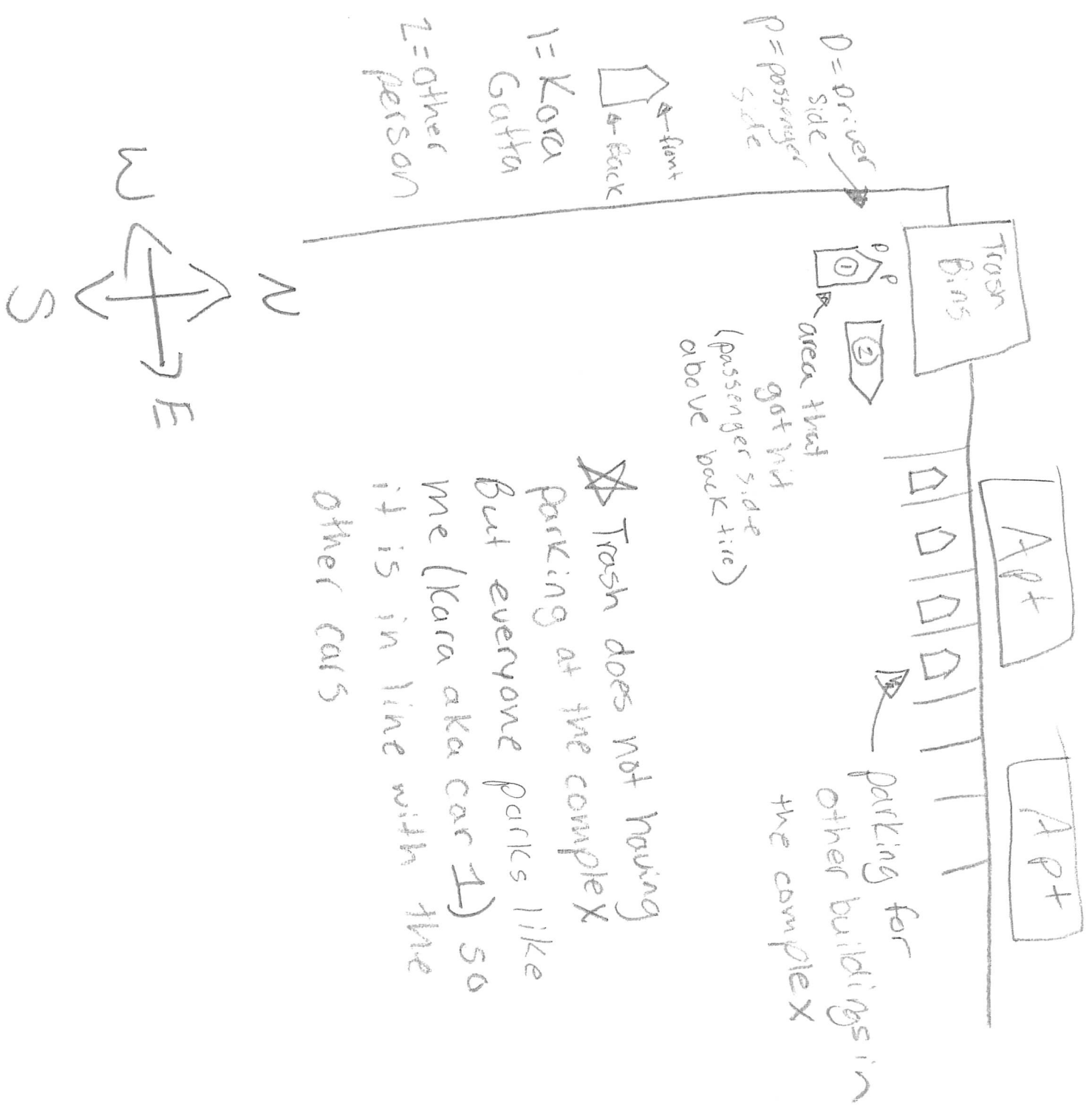

Wynndram Ridge Dr