



STOW POLICE DEPARTMENT

PRIVATE PROPERTY ACCIDENT REPORT/MINOR
TRAFFIC ACCIDENT REPORT

INCIDENT NUMBER
24-8172

DATE
5/23/2024

TIME
1843

Private Property Private Property - Hit/Skip Minor Traffic Accident

LOCATION - ADDRESS
3048 Graham Road

VEHICLE #1

DRIVER #1 - NAME (Last, First, Middle) **Bimshas Kim M.** PHONE [REDACTED]

ADDRESS **4092 Burton Dr** CITY **Stow** STATE **OH** ZIP **44224**

SSN [REDACTED] DATE OF BIRTH **07/16/1963** DRIVER'S LICENSE NUMBER [REDACTED] STATE **OH**

OWNER #1 - NAME (Last, First, Middle) SAME AS DRIVER #1 **Bimshas John Robert** PHONE [REDACTED]

ADDRESS **4092 Burton Dr** CITY **Stow** STATE **OH** ZIP **44224**

SSN [REDACTED] DATE OF BIRTH **11/14/1957** DRIVER'S LICENSE NUMBER [REDACTED] STATE **OH**

VEHICLE LICENSE# **JLC1927** STATE **OH** YEAR **2021** MAKE **Chevrolet** MODEL **Equinox** COLOR **Gray**

INSURANCE COMPANY **State Farm** POLICY NUMBER **2872863-SFP-35**

PARTS OF VEHICLE DAMAGED
Driver side front quarter panel

VEHICLE #2

DRIVER #2 - NAME (Last, First, Middle) **Pelletier Jonathan Hartwell** PHONE [REDACTED]

ADDRESS **6266 Stow Rd** CITY **Hudson** STATE **OH** ZIP **44236**

SSN [REDACTED] DATE OF BIRTH **07/17/1988** DRIVER'S LICENSE NUMBER [REDACTED] STATE **OH**

OWNER #2 - NAME (Last, First, Middle) SAME AS DRIVER #2 PHONE [REDACTED]

ADDRESS [REDACTED] CITY [REDACTED] STATE [REDACTED] ZIP [REDACTED]

SSN [REDACTED] DATE OF BIRTH [REDACTED] DRIVER'S LICENSE NUMBER [REDACTED] STATE [REDACTED]

VEHICLE LICENSE # **KCL6057** STATE **OH** YEAR **2023** MAKE **Ford** MODEL **Escape** COLOR **Blue**

INSURANCE COMPANY **American Select** POLICY NUMBER **WNP225030W**

PARTS OF VEHICLE DAMAGED
Passenger side door

DESCRIBE WHAT HAPPENED
Unit One was pulling into the parking spot when unit One struck Unit Two. Unit One struck unit Two in the passenger side door with Unit One's drive side front quarter panel. There was no injuries. Unit Two was parked in the spot.

See Reverse Side for Diagram

SUBMITTED BY: **[Signature] #771** DATE **05/23/2024**

APPROVING OFFICER: **[Signature]** DATE **5-23-24**

STOW POLICE DEPARTMENT

FIELD SKETCH (not drawn to scale)

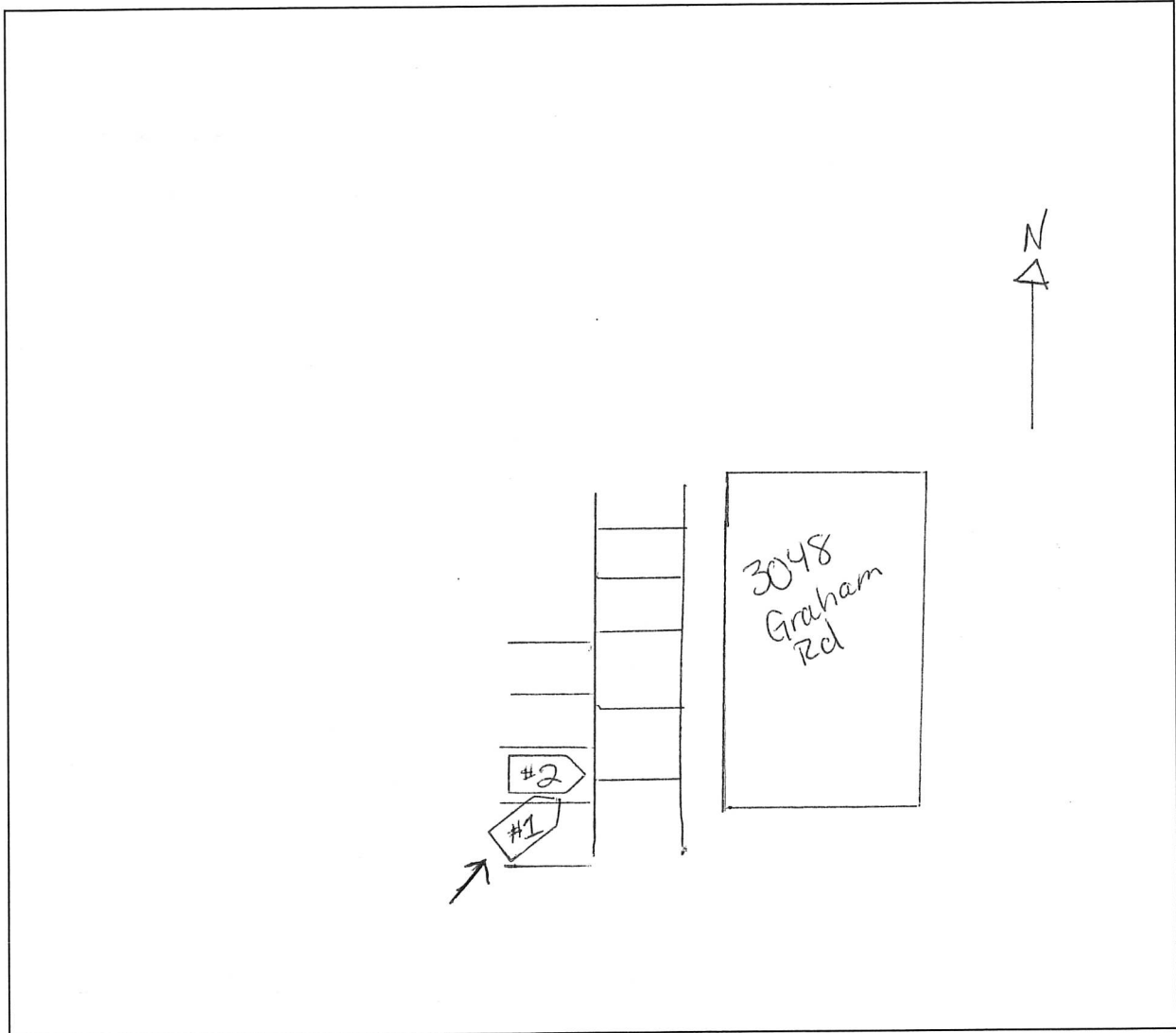

WEATHER

- CLEAR
- RAIN
- SNOW
- FOG

LIGHT

- DAYLIGHT
- DARKNESS
- WITH STREET LIGHTS

SURFACE

- DRY
- WET
- SNOW
- OTHER

ROAD

- CONCRETE
- BLACKTOP
- DIRT
- OTHER