



STOW POLICE DEPARTMENT

PRIVATE PROPERTY ACCIDENT REPORT/MINOR TRAFFIC ACCIDENT REPORT

INCIDENT NUMBER 24-2356
 DATE 2-21-24 TIME 1636

Private Property Private Property - Hit/Skip Minor Traffic Accident

LOCATION - ADDRESS 2086 Graham Rd

DRIVER #1 - NAME (Last, First, Middle) - PHONE -
 ADDRESS - CITY - STATE - ZIP -
 SSN - DATE OF BIRTH - DRIVER'S LICENSE NUMBER - STATE -

VEHICLE #1
 OWNER #1 - NAME (Last, First, Middle) SAME AS DRIVER #1 Beško, David, P PHONE [REDACTED]
 ADDRESS 4819 Garnet Cir CITY Stow STATE OH ZIP 44224
 SSN [REDACTED] DATE OF BIRTH 3-12-70 DRIVER'S LICENSE NUMBER [REDACTED] STATE OH
 VEHICLE LICENSE# HZ55896 STATE OH YEAR 2015 MAKE Toyota MODEL Camry COLOR Black
 INSURANCE COMPANY Geico POLICY NUMBER 4252-22-01-56

PARTS OF VEHICLE DAMAGED Front L fender CONTRIBUTING CIRCUMSTANCES None

DRIVER #2 - NAME (Last, First, Middle) Unknown PHONE -
 ADDRESS - CITY - STATE - ZIP -
 SSN - DATE OF BIRTH - DRIVER'S LICENSE NUMBER - STATE -

VEHICLE #2
 OWNER #2 - NAME (Last, First, Middle) SAME AS DRIVER #2 - PHONE -
 ADDRESS - CITY - STATE - ZIP -
 SSN - DATE OF BIRTH - DRIVER'S LICENSE NUMBER - STATE -
 VEHICLE LICENSE # - STATE - YEAR - MAKE - MODEL - COLOR -
 INSURANCE COMPANY - POLICY NUMBER -

PARTS OF VEHICLE DAMAGED - CONTRIBUTING CIRCUMSTANCES -

DESCRIBE WHAT HAPPENED Unit 1 sustained damage to the front left fender. He is not sure where it occurred. The damage is unlikely to have occurred here with the way the vehicle was parked

See Reverse Side for Diagram

SUBMITTED BY: P.H. C. [Signature] DATE 2-21-24
 APPROVING OFFICER: [Signature] DATE 2-24-24

STOW POLICE DEPARTMENT

FIELD SKETCH (not drawn to scale)

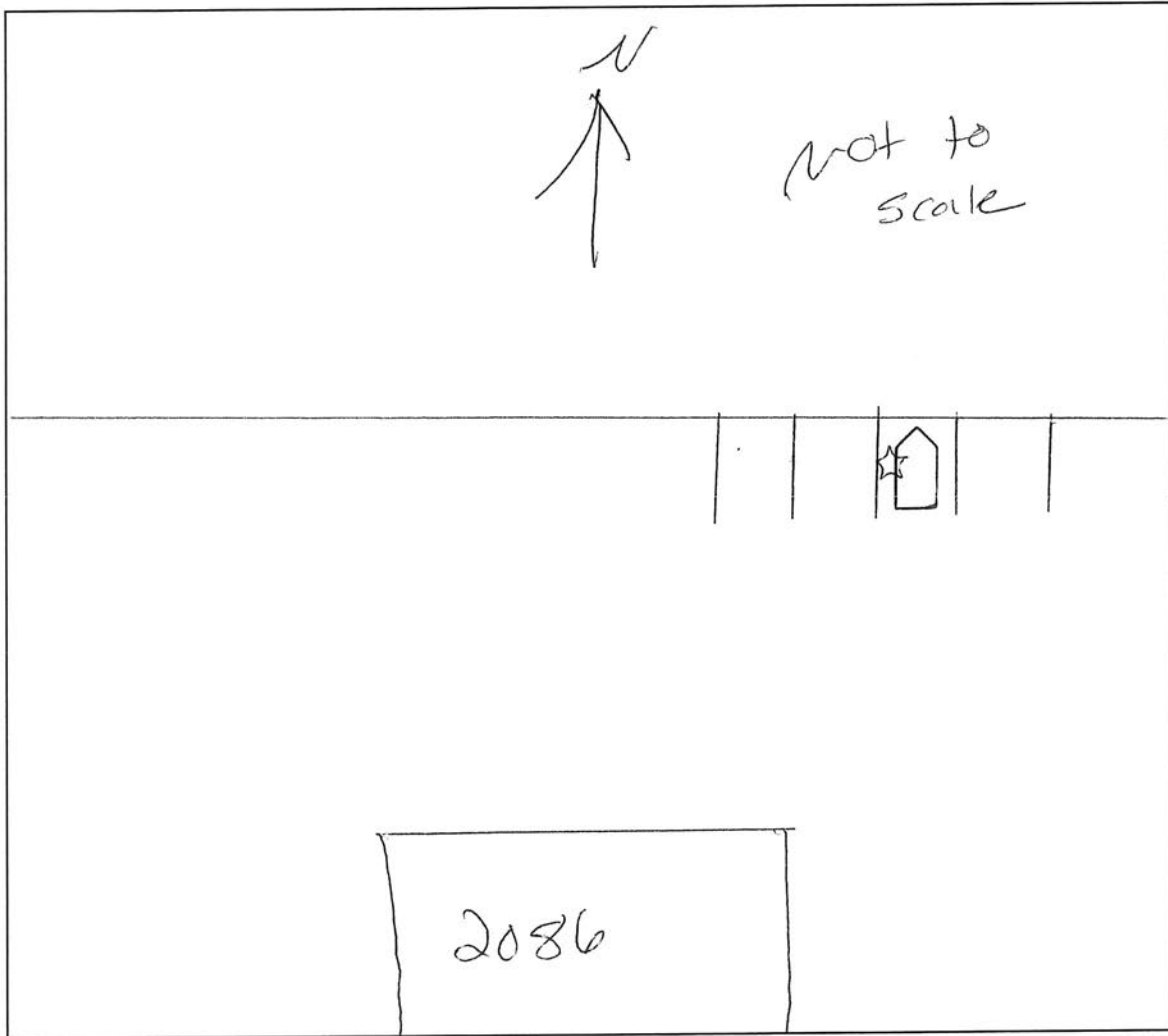

WEATHER

- CLEAR
- RAIN
- SNOW
- FOG
- OTHER

LIGHT

- DAYLIGHT
- DAWN
- DUSK
- DARK - LIGHTED ROAD
- DARK - NOT LIGHTED
- DARK - UNK LIGHTING
- UNKNOWN

SURFACE

- DRY
- WET
- SNOW
- ICE
- OTHER

ROAD

- CONCRETE
- BLACKTOP
- DIRT
- OTHER