



# STOW POLICE DEPARTMENT

PRIVATE PROPERTY ACCIDENT REPORT/MINOR  
TRAFFIC ACCIDENT REPORT

INCIDENT NUMBER  
*24-001762*

DATE  
*2/2/24*

TIME  
*1032*

Private Property  Private Property - Hit/Skip  Minor Traffic Accident

LOCATION - ADDRESS  
*3515 Hudson Drive*

DRIVER #1 - NAME (Last, First, Middle)  
*Hambrecht, Joseph, Charles*

ADDRESS  
*3449 HAAS Road*

CITY  
*Cuyahoga Falls*

STATE  
*OHIO*

ZIP  
*44223*

SSN  
[REDACTED]

DATE OF BIRTH  
*5/17/53*

DRIVER'S LICENSE NUMBER  
[REDACTED]

STATE  
*OHIO*

VEHICLE #1

OWNER #1 - NAME (Last, First, Middle)  SAME AS DRIVER #1

ADDRESS  
CITY  
STATE  
ZIP

SSN  
DATE OF BIRTH  
DRIVER'S LICENSE NUMBER  
STATE

VEHICLE LICENSE#  
*GFL6208*

STATE  
*OH*

YEAR  
*2002*

MAKE  
*Chevy*

MODEL  
*Silverado*

COLOR  
*Silver*

INSURANCE COMPANY  
*Wayne Mutual*

POLICY NUMBER  
*EAP0335538*

PARTS OF VEHICLE DAMAGED  
*front bumper*

CONTRIBUTING CIRCUMSTANCES  
*Struck Unit #2*

DRIVER #2 - NAME (Last, First, Middle)  
*Driverless*

ADDRESS  
CITY  
STATE  
ZIP

SSN  
DATE OF BIRTH  
DRIVER'S LICENSE NUMBER  
STATE

VEHICLE #2

OWNER #2 - NAME (Last, First, Middle)  SAME AS DRIVER #2

ADDRESS  
*100 Keenan Road #H3*

CITY  
*Peninsula*

STATE  
*OHIO*

ZIP  
*44264*

SSN  
[REDACTED]

DATE OF BIRTH  
*11/3/50*

DRIVER'S LICENSE NUMBER  
[REDACTED]

STATE  
*OHIO*

VEHICLE LICENSE #  
*JWY6766*

STATE  
*OHIO*

YEAR  
*2012*

MAKE  
*MAZDA*

MODEL  
*5*

COLOR  
*Red*

INSURANCE COMPANY  
*State Farm*

POLICY NUMBER  
*25098685FA35*

PARTS OF VEHICLE DAMAGED  
*Rear bumper*

CONTRIBUTING CIRCUMSTANCES  
*None*

DESCRIBE WHAT HAPPENED

*Unit #2 was driverless and parked at 3515 Hudson Drive. Unit #7 was parking and struck Unit #2.*

See Reverse Side for Diagram

SUBMITTED BY:  
*Det. R. Frizina #742*

DATE  
*2-2-24*

APPROVING OFFICER:  
*Sgt. Olesinski #713*

DATE  
*2/2/24*

# STOW POLICE DEPARTMENT

## FIELD SKETCH (not drawn to scale)

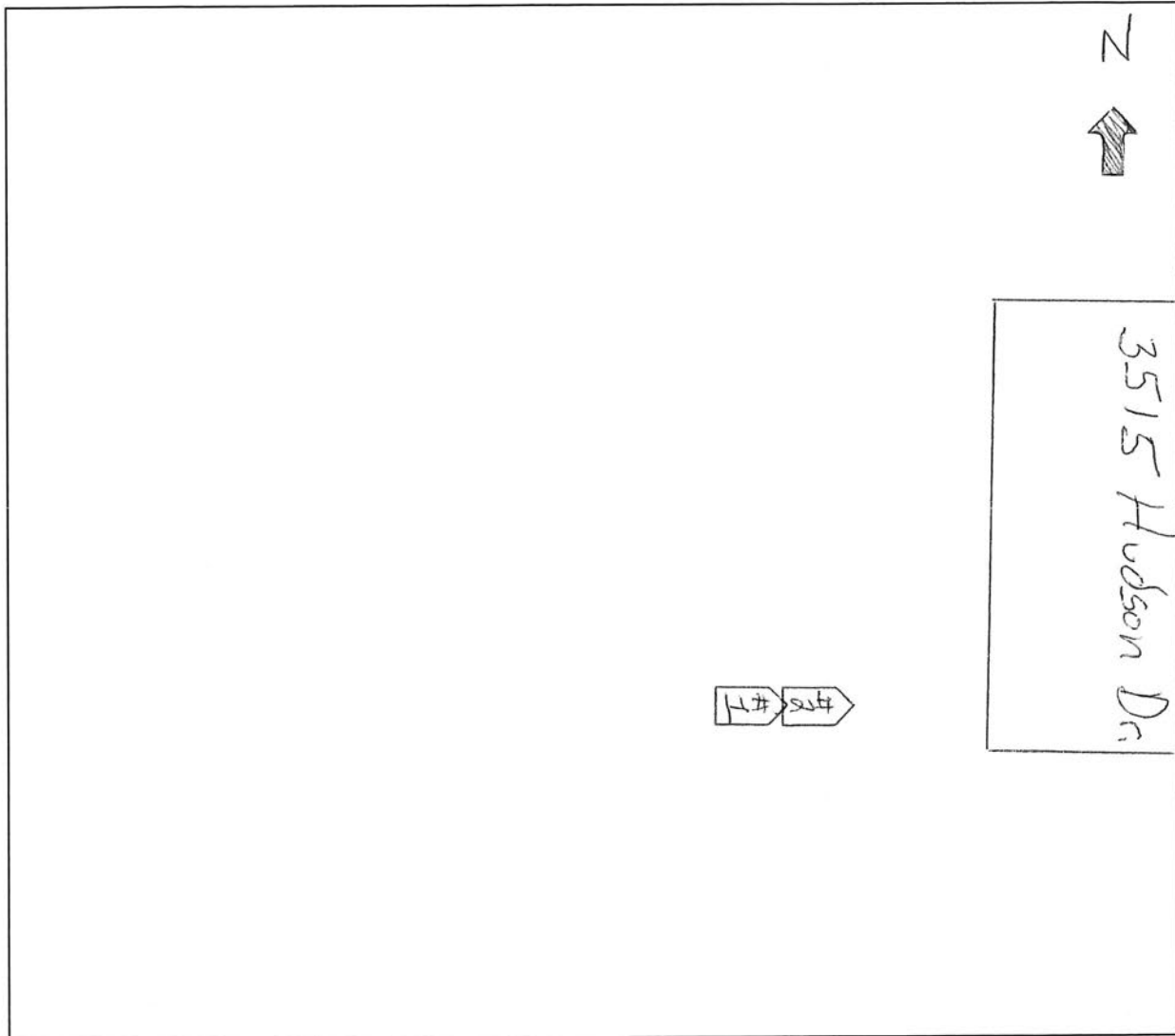

### WEATHER

- CLEAR
- RAIN
- SNOW
- FOG
- OTHER

### LIGHT

- DAYLIGHT
- DAWN
- DUSK
- DARK - LIGHTED ROAD
- DARK - NOT LIGHTED
- DARK - UNK LIGHTING
- UNKNOWN

### SURFACE

- DRY
- WET
- SNOW
- ICE
- OTHER

### ROAD

- CONCRETE
- BLACKTOP
- DIRT
- OTHER