



STOW POLICE DEPARTMENT

PRIVATE PROPERTY ACCIDENT REPORT/MINOR
TRAFFIC ACCIDENT REPORT

INCIDENT NUMBER

2024-00834

DATE

1/15/2024

TIME

1223

 Private Property Private Property - Hit/Skip Minor Traffic Accident

LOCATION - ADDRESS

4200 Kent Rd. - Target Stow, OH 44224

DRIVER #1 - NAME (Last, First, Middle)

Martinez, Abby Lynn

PHONE

ADDRESS

511 Roland Hills Dr.

CITY

Mogadore

STATE

OH

ZIP

44260

SSN

[REDACTED]

DATE OF BIRTH

6/18/2009

DRIVER'S LICENSE NUMBER

[REDACTED]

STATE

OH

VEHICLE #1

OWNER #1 - NAME (Last, First, Middle)

 SAME AS DRIVER #1

PHONE

ADDRESS

CITY

STATE

ZIP

SSN

DATE OF BIRTH

DRIVER'S LICENSE NUMBER

STATE

VEHICLE LICENSE#

KBV 8236

STATE

OH

YEAR

2015

MAKE

Lexus

MODEL

RX 350

COLOR

Black

INSURANCE COMPANY

Progressive

POLICY NUMBER

967820105

PARTS OF VEHICLE DAMAGED

Rear bumper - driver side

CONTRIBUTING CIRCUMSTANCES

See Narrative

VEHICLE #2

DRIVER #2 - NAME (Last, First, Middle)

Rennet, Grace Mae

PHONE

ADDRESS

61 Waldorf Dr.

CITY

Painesville

STATE

OH

ZIP

44077

SSN

[REDACTED]

DATE OF BIRTH

8/30/2001

DRIVER'S LICENSE NUMBER

[REDACTED]

STATE

OH

OWNER #2 - NAME (Last, First, Middle)

 SAME AS DRIVER #2

PHONE

ADDRESS

61 Waldorf Dr.

CITY

Painesville

STATE

OH

ZIP

44077

SSN

[REDACTED]

DATE OF BIRTH

5/25/1971

DRIVER'S LICENSE NUMBER

[REDACTED]

STATE

OH

VEHICLE LICENSE #

HDM 1960

STATE

OH

YEAR

2008

MAKE

GMC

MODEL

ENVY

COLOR

Silver

INSURANCE COMPANY

Hart Ford

POLICY NUMBER

55100278815

PARTS OF VEHICLE DAMAGED

Rear bumper - passenger side

CONTRIBUTING CIRCUMSTANCES

See Narrative

DESCRIBE WHAT HAPPENED

Vehicles were in parking spaces. Both vehicles backed from parking spaces into aisle and hit each other.

See Reverse Side for Diagram

SUBMITTED BY:

Ptl. J. Smith 740

DATE

1/15/2024

APPROVING OFFICER:

[Signature]

DATE

1-16-24

STOW POLICE DEPARTMENT

FIELD SKETCH (not drawn to scale)

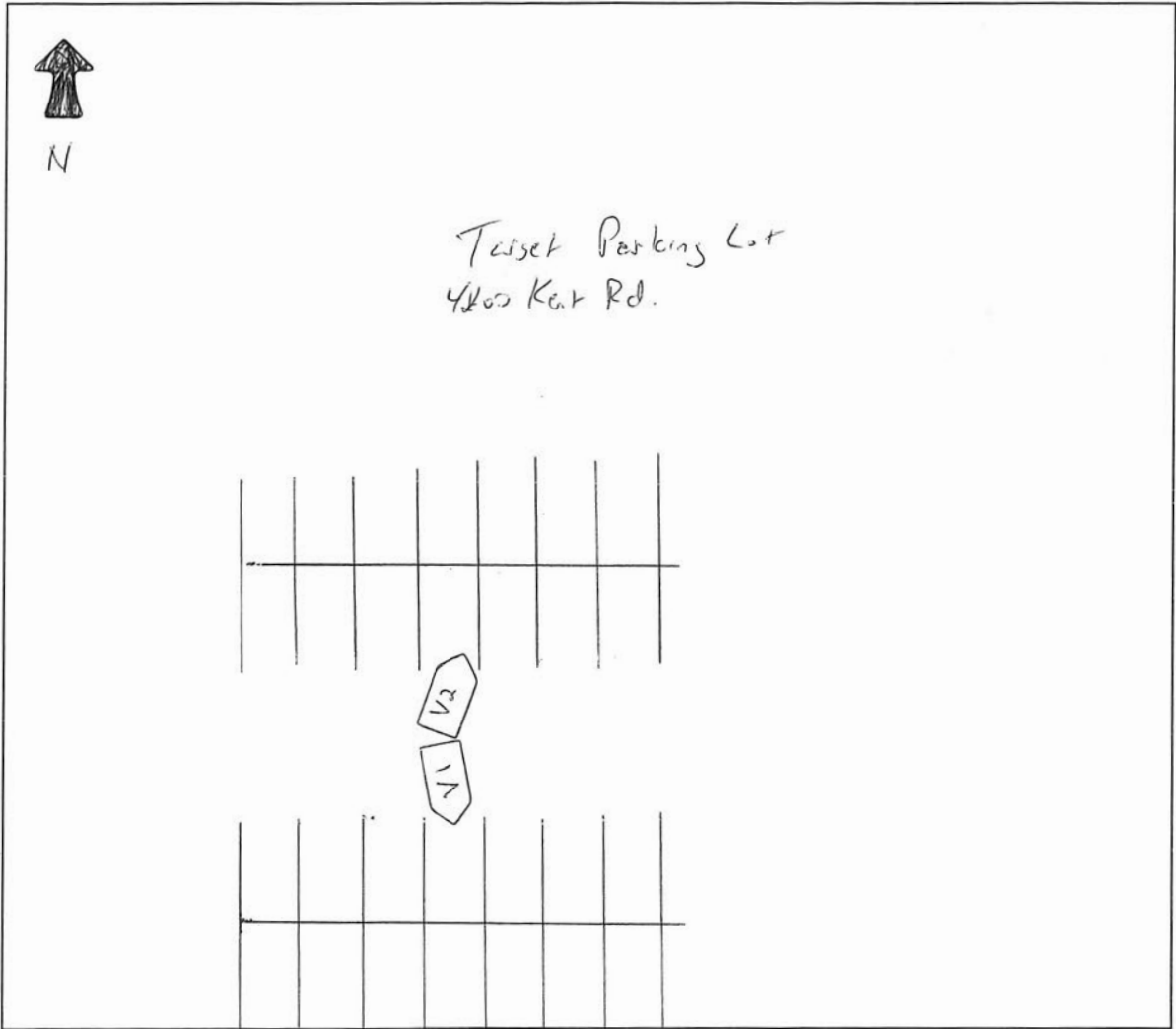

WEATHER

- CLEAR
- RAIN
- SNOW
- FOG
- OTHER

LIGHT

- DAYLIGHT
- DAWN
- DUSK
- DARK - LIGHTED ROAD
- DARK - NOT LIGHTED
- DARK - UNK LIGHTING
- UNKNOWN

SURFACE

- DRY
- WET
- SNOW
- ICE
- OTHER

ROAD

- CONCRETE
- BLACKTOP
- DIRT
- OTHER