



STOW POLICE DEPARTMENT

PRIVATE PROPERTY ACCIDENT REPORT/MINOR
TRAFFIC ACCIDENT REPORT

INCIDENT NUMBER
23-19999

DATE
11-12-23

TIME
1809

Private Property Private Property - Hit/Skip Minor Traffic Accident

LOCATION - ADDRESS
NORTH RIVER / VERNER

VEHICLE #1

DRIVER #1 - NAME (Last, First, Middle) **ZEMISIC, ERIN R.** PHONE [REDACTED]

ADDRESS **709 MARILYN DR.** CITY **KENT** STATE **OH** ZIP **44240**

SSN [REDACTED] DATE OF BIRTH **5-9-82** DRIVER'S LICENSE NUMBER [REDACTED] STATE **OH**

OWNER #1 - NAME (Last, First, Middle) SAME AS DRIVER #1 PHONE

ADDRESS CITY STATE ZIP

SSN DATE OF BIRTH DRIVER'S LICENSE NUMBER STATE

VEHICLE LICENSE# **FN2515** STATE **OH** YEAR **2011** MAKE **HONDA** MODEL **SONATA** COLOR **GRAY**

INSURANCE COMPANY **ALLSTATE** POLICY NUMBER **INC 618 784**

PARTS OF VEHICLE DAMAGED **DRIVER FRONT** CONTRIBUTING CIRCUMSTANCES **NONE**

VEHICLE #2

DRIVER #2 - NAME (Last, First, Middle) PHONE

ADDRESS CITY STATE ZIP

SSN DATE OF BIRTH DRIVER'S LICENSE NUMBER STATE

OWNER #2 - NAME (Last, First, Middle) SAME AS DRIVER #2 PHONE

ADDRESS CITY STATE ZIP

SSN DATE OF BIRTH DRIVER'S LICENSE NUMBER STATE

VEHICLE LICENSE # STATE YEAR MAKE MODEL COLOR

INSURANCE COMPANY POLICY NUMBER

PARTS OF VEHICLE DAMAGED CONTRIBUTING CIRCUMSTANCES

DESCRIBE WHAT HAPPENED

UNIT # 1 WESTBOUND N. RIVER RD. NEAR VERNER

STRUCK DEER

See Reverse Side for Diagram

SUBMITTED BY: **OPC. S. WILLIAMS 780** DATE **11-12-23**

APPROVING OFFICER: **Gintler 715** DATE **11-13-23**

STOW POLICE DEPARTMENT

FIELD SKETCH (not drawn to scale)

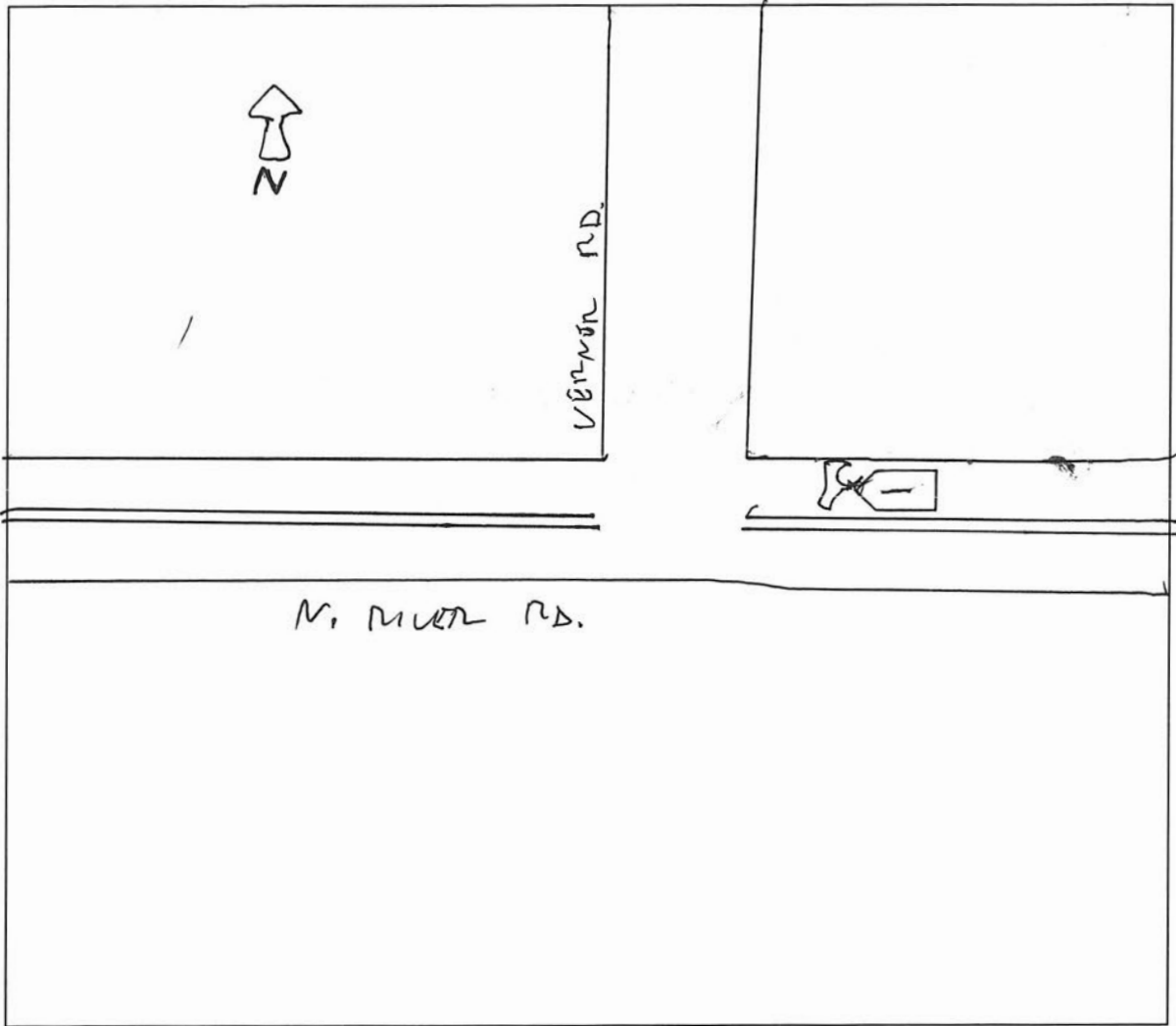

WEATHER

- CLEAR
- RAIN
- SNOW
- FOG
- OTHER

LIGHT

- DAYLIGHT
- DAWN
- DUSK
- DARK - LIGHTED ROAD
- DARK - NOT LIGHTED
- DARK - UNK LIGHTING
- UNKNOWN

SURFACE

- DRY
- WET
- SNOW
- ICE
- OTHER

ROAD

- CONCRETE
- BLACKTOP
- DIRT
- OTHER