



STOW POLICE DEPARTMENT

PRIVATE PROPERTY ACCIDENT REPORT/MINOR TRAFFIC ACCIDENT REPORT

INCIDENT NUMBER

23-17739

DATE

10/3/23

TIME

1110

 Private Property
 Private Property - Hit/Skip
 Minor Traffic Accident

LOCATION - ADDRESS

3570 Hudson Dr, Stow, OH 44224

PHONE

[REDACTED]

DRIVER #1 - NAME (Last, First, Middle)

Dotterer, Douglas

ADDRESS

2369 Harvester Dr

CITY

Stow

STATE

OH

ZIP 44224

SSN

[REDACTED]

DATE OF BIRTH

6/1/55

DRIVER'S LICENSE NUMBER

[REDACTED]

STATE

OH

VEHICLE #1

OWNER #1 - NAME (Last, First, Middle)

 SAME AS DRIVER #1

Geddon, Julie

PHONE

SAME

ADDRESS

SAME

CITY

STATE

-

ZIP

-

SSN

[REDACTED]

DATE OF BIRTH

2/22/59

DRIVER'S LICENSE NUMBER

[REDACTED]

STATE

OH

VEHICLE LICENSE #

FV68891

STATE

YEAR

OH 2016

MAKE

Subaru

MODEL

Crosstrek

COLOR

GRY

INSURANCE COMPANY

State Farm

POLICY NUMBER

2A6245-SFP-35

PARTS OF VEHICLE DAMAGED

Front bumper

CONTRIBUTING CIRCUMSTANCES

None

VEHICLE #2

DRIVER #2 - NAME (Last, First, Middle)

Irvin, Cheryl, A

PHONE

[REDACTED]

ADDRESS

2675 9th St

CITY

Cuyahoga Falls

STATE

OH

ZIP 44221

SSN

[REDACTED]

DATE OF BIRTH

9/27/64

DRIVER'S LICENSE NUMBER

[REDACTED]

STATE

OH

OWNER #2 - NAME (Last, First, Middle)

 SAME AS DRIVER #2

PHONE

ADDRESS

CITY

STATE

-

ZIP

-

SSN

DATE OF BIRTH

DRIVER'S LICENSE NUMBER

STATE

VEHICLE LICENSE #

GED 8025

STATE

YEAR

OH 2013

MAKE

Chrysler

MODEL

300

COLOR

GRY

INSURANCE COMPANY

Progressive

POLICY NUMBER

UNK

PARTS OF VEHICLE DAMAGED

Rear bumper

CONTRIBUTING CIRCUMSTANCES

Improper Backing

DESCRIBE WHAT HAPPENED

Veh#1 was traveling westbound through an aisle at Lowe's. Veh#2 was facing north and backed out of a parking space. Veh#2 backed into the front of Veh#1.

See Reverse Side for Diagram

SUBMITTED BY:

Pc B. Harris #1736

DATE

10/3/23

APPROVING OFFICER:

Sgt. [Signature]

DATE

10/3/23

STOW POLICE DEPARTMENT

FIELD SKETCH (not drawn to scale)

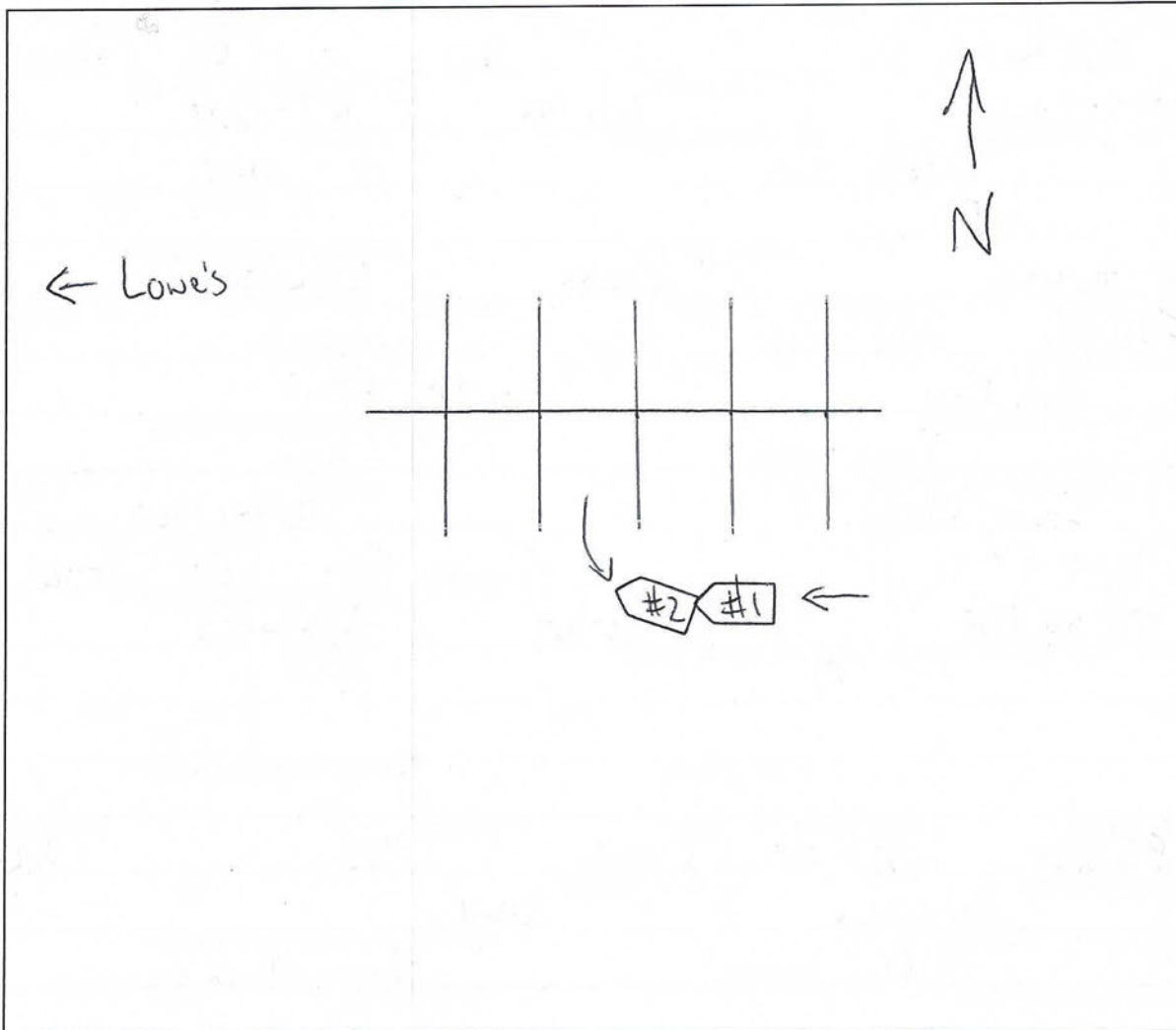

WEATHER

- CLEAR
- RAIN
- SNOW
- FOG
- OTHER

LIGHT

- DAYLIGHT
- DAWN
- DUSK
- DARK - LIGHTED ROAD
- DARK - NOT LIGHTED
- DARK - UNK LIGHTING
- UNKNOWN

SURFACE

- DRY
- WET
- SNOW
- ICE
- OTHER

ROAD

- CONCRETE
- BLACKTOP
- DIRT
- OTHER