



STOW POLICE DEPARTMENT
 PRIVATE PROPERTY ACCIDENT REPORT/MINOR
 TRAFFIC ACCIDENT REPORT

INCIDENT NUMBER
 2022-8446
 DATE
 06/07/2022
 TIME
 1215

Private Property Private Property - Hit/Skip Minor Traffic Accident - Hit/Skip

LOCATION - ADDRESS
 Graham Rd/Baird Rd

VEHICLE #1

DRIVER #1 - NAME (Last, First, Middle) Archer, Thomas
 ADDRESS 3410 26th St NW CITY Canton OH 44708
 SSN [REDACTED] DATE OF BIRTH 11/11/1987 DR [REDACTED] STATE OH
 OWNER #1 - NAME (Last, First, Middle) Republic Services
 ADDRESS 2800 Erie St CITY Massillon OH 44646
 SSN [REDACTED] DATE OF BIRTH [REDACTED] DRIVER'S LICENSE NUMBER [REDACTED] STATE OH
 VEHICLE LICENSE# PJZ 8359 STATE OH YEAR 2018 MAKE MACK MODEL LR 600 COLOR UNK
 INSURANCE COMPANY Ace American POLICY NUMBER ISAH 255 49252

PARTS OF VEHICLE DAMAGED None CONTRIBUTING CIRCUMSTANCES None

VEHICLE #2

DRIVER #2 - NAME (Last, First, Middle) UNKNOWN
 ADDRESS [REDACTED] CITY [REDACTED] STATE [REDACTED] ZIP [REDACTED]
 SSN [REDACTED] DATE OF BIRTH [REDACTED] DRIVER'S LICENSE NUMBER [REDACTED] STATE [REDACTED]
 OWNER #2 - NAME (Last, First, Middle) UNKNOWN
 ADDRESS [REDACTED] CITY [REDACTED] STATE [REDACTED] ZIP [REDACTED]
 SSN [REDACTED] DATE OF BIRTH [REDACTED] DRIVER'S LICENSE NUMBER [REDACTED] STATE [REDACTED]
 VEHICLE LICENSE # UNK STATE OH YEAR [REDACTED] MAKE NISSAN MODEL [REDACTED] COLOR Gray
 INSURANCE COMPANY [REDACTED] POLICY NUMBER [REDACTED]

PARTS OF VEHICLE DAMAGED Passenger side mirror CONTRIBUTING CIRCUMSTANCES Improper passing

DESCRIBE WHAT HAPPENED
 Unit #1 was westbound on Graham Rd in the area of Baird Rd. Unit #1 stopped to pick up trash and unit #2 passed unit #1 westbound and struck unit #1 with its passenger side mirror. The mirror on unit #2 was torn off the vehicle.

See Reverse Side for Diagram

SUBMITTED BY: Sgt Drummond 710 DATE 6/8/22
 APPROVING OFFICER: Sgt [Signature] DATE 6/8/22

STOW POLICE DEPARTMENT

FIELD SKETCH (not drawn to scale)

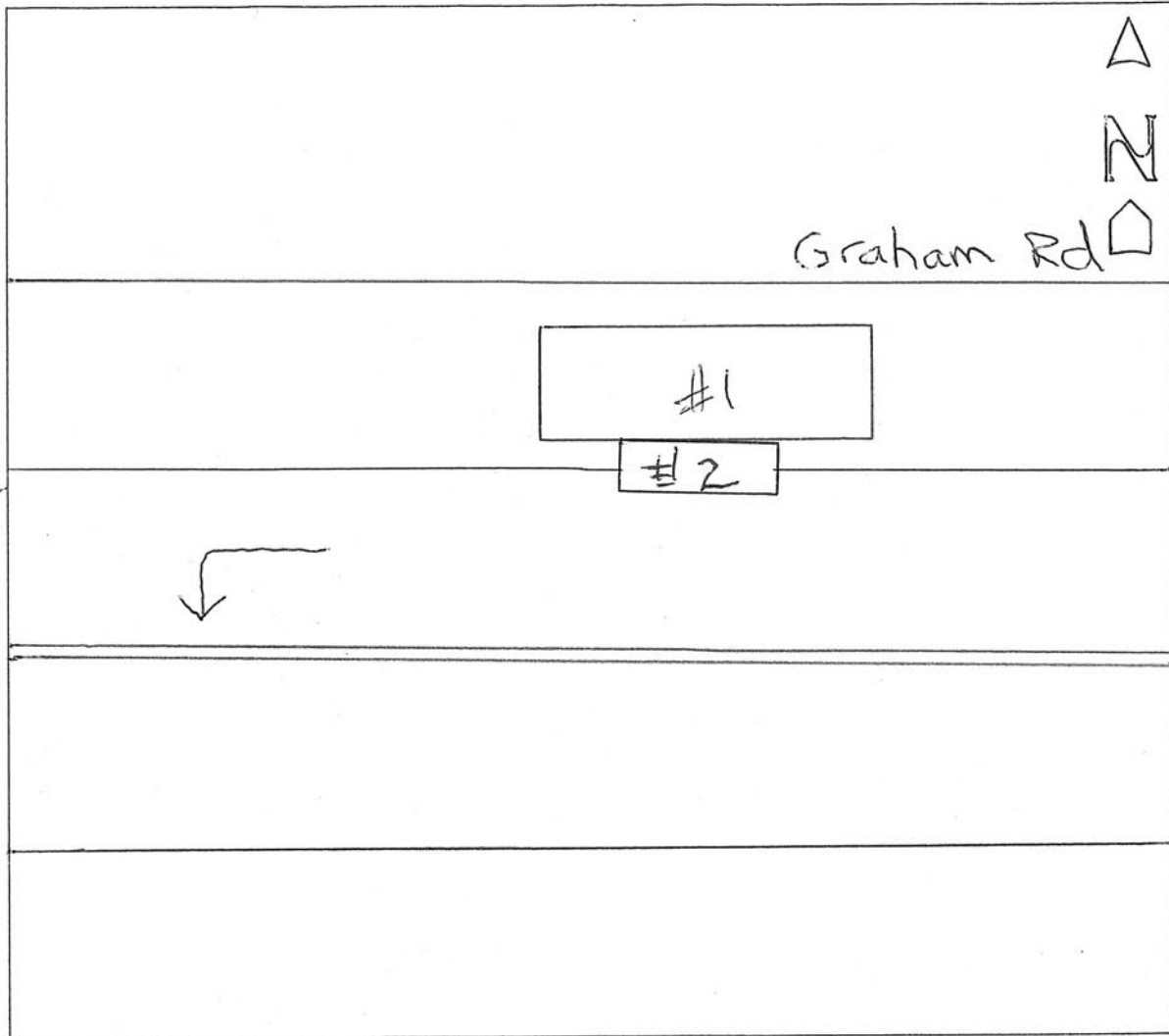

WEATHER

- CLEAR
- RAIN
- SNOW
- FOG
- OTHER

LIGHT

- DAYLIGHT
- DAWN
- DUSK
- DARK - LIGHTED ROAD
- DARK - NOT LIGHTED
- DARK - UNK LIGHTING
- UNKNOWN

SURFACE

- DRY
- WET
- SNOW
- ICE
- OTHER

ROAD

- CONCRETE
- BLACKTOP
- DIRT
- OTHER