



# STOW POLICE DEPARTMENT

PRIVATE PROPERTY ACCIDENT REPORT/MINOR  
TRAFFIC ACCIDENT REPORT

INCIDENT NUMBER **22-08396**  
DATE **6-6-22** TIME **0859**

Private Property    Private Property - Hit/Skip    Minor Traffic Accident

LOCATION - ADDRESS **750 E. Steels Corners Rd**

DRIVER #1 - NAME (Last, First, Middle) **Milojevich, Michael Evan** PH [REDACTED]  
ADDRESS **7377 Meadow Creek Rd** CITY **Sagamore Hills** STATE **OH** ZIP **44067**  
SSI [REDACTED] DATE OF BIRTH **02-08-1985** DRIVER'S LICENSE NUMBER [REDACTED] STATE **OH**

VEHICLE #1  
OWNER #1 - NAME (Last, First, Middle)  SAME AS DRIVER #1 **Milojevich, Michael Evan** PHO [REDACTED]  
ADDRESS **7377 Meadow Creek Rd** CITY **Sagamore Hills** STATE **OH** ZIP **44067**  
S [REDACTED] DATE OF BIRTH **02/08/1985** DRIVER'S LICENSE NUMBER [REDACTED] STATE **OH**

VEHICLE LICENSE# **JFF1813** STATE **OH** YEAR **2011** MAKE **Toyota** MODEL **RAV4** COLOR **black**  
INSURANCE COMPANY **Progressive** POLICY NUMBER **907929474**

PARTS OF VEHICLE DAMAGED **NONE** CONTRIBUTING CIRCUMSTANCES **full time + Attn**

DRIVER #2 - NAME (Last, First, Middle) \_\_\_\_\_ PHONE \_\_\_\_\_  
ADDRESS \_\_\_\_\_ CITY \_\_\_\_\_ STATE \_\_\_\_\_ ZIP \_\_\_\_\_  
SSN \_\_\_\_\_ DATE OF BIRTH \_\_\_\_\_ DRIVER'S LICENSE NUMBER \_\_\_\_\_ STATE \_\_\_\_\_

VEHICLE #2  
OWNER #2 - NAME (Last, First, Middle)  SAME AS DRIVER #2 **Circle K gas** PHO [REDACTED]  
ADDRESS **750 E. Steels Corners** CITY **Stow** STATE **OH** ZIP **44224**  
SSN \_\_\_\_\_ DATE OF BIRTH \_\_\_\_\_ DRIVER'S LICENSE NUMBER \_\_\_\_\_ STATE \_\_\_\_\_

VEHICLE LICENSE # \_\_\_\_\_ STATE \_\_\_\_\_ YEAR \_\_\_\_\_ MAKE \_\_\_\_\_ MODEL \_\_\_\_\_ COLOR \_\_\_\_\_  
INSURANCE COMPANY \_\_\_\_\_ POLICY NUMBER \_\_\_\_\_

PARTS OF VEHICLE DAMAGED \_\_\_\_\_ CONTRIBUTING CIRCUMSTANCES \_\_\_\_\_

DESCRIBE WHAT HAPPENED  
**Circle K gas reports unit 7 accidentally drove off w/a gas nozzle still attached to his vehicle causing the line/nozzle to come off at the pump on 6/01/22 approx. 1000hrs.**

See Reverse Side for Diagram

SUBMITTED BY: **[Signature]** **Molody 734** DATE **6/6/22**  
APPROVING OFFICER: **[Signature]** **Sgt. Quinn 710** DATE **6/6/22**

# STOW POLICE DEPARTMENT

FIELD SKETCH (not drawn to scale)

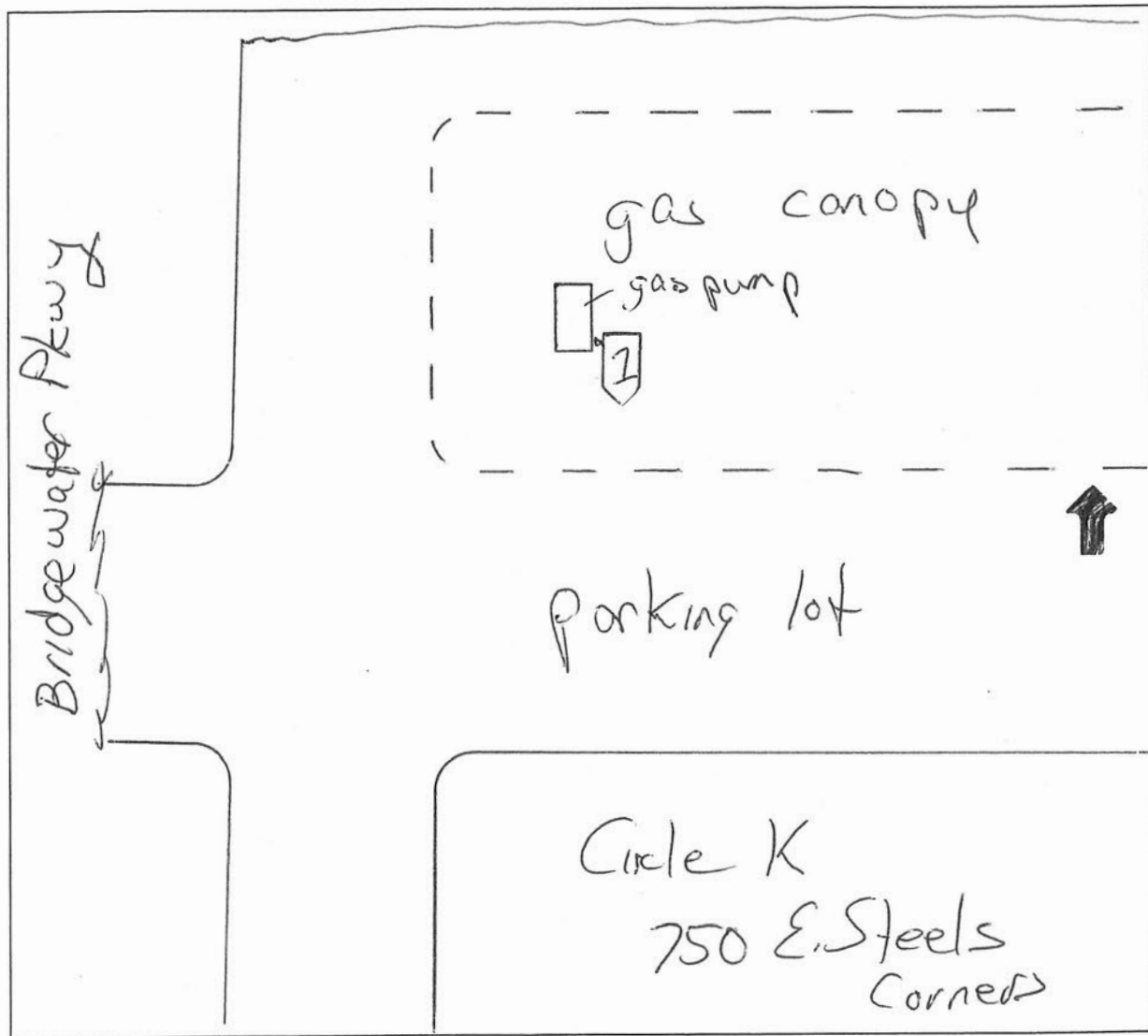

## WEATHER

- CLEAR
- RAIN
- SNOW
- FOG
- OTHER

## LIGHT

- DAYLIGHT
- DAWN
- DUSK
- DARK - LIGHTED ROAD
- DARK - NOT LIGHTED
- DARK - UNK LIGHTING
- UNKNOWN

## SURFACE

- DRY
- WET
- SNOW
- ICE
- OTHER

## ROAD

- CONCRETE
- BLACKTOP
- DIRT
- OTHER