



STOW POLICE DEPARTMENT

PRIVATE PROPERTY ACCIDENT REPORT/MINOR
TRAFFIC ACCIDENT REPORT

INCIDENT NUMBER

23-16363

DATE

9.12.2023

TIME

1409

Private Property Private Property - Hit/Skip Minor Traffic Accident

LOCATION - ADDRESS

3227 Graham Road

DRIVER #1 - NAME (Last, First, Middle)

MEERS, ELIA M

PHONE

[REDACTED]

ADDRESS

3443 Stillwood Blvd

CITY

Stow

STATE

OH

ZIP

44224

SSN

[REDACTED]

DATE OF BIRTH

5.1.2007

DR

[REDACTED]

STATE

OH

OWNER #1 - NAME (Last, First, Middle)

SAME AS DRIVER #1

KAUTSMANN, STEVEN P

PHONE

[REDACTED]

ADDRESS

3443 Stillwood Blvd

CITY

Stow

STATE

OH

ZIP

44224

SSN

[REDACTED]

DATE OF BIRTH

11.15.1975

DR

[REDACTED]

STATE

OH

VEHICLE LICENSE #

KBE 7829

STATE

OH

YEAR

2021

MAKE

Jeep

MODEL

Latitude

COLOR

Silver

INSURANCE COMPANY

USAA

POLICY NUMBER

USAA 012112677 7106

PARTS OF VEHICLE DAMAGED

rear left side

CONTRIBUTING CIRCUMSTANCES

None

DRIVER #2 - NAME (Last, First, Middle)

Spigelmirer, Graham K

PHONE

[REDACTED]

ADDRESS

1400 Housley Road

CITY

Stow

STATE

OH

ZIP

44224

SSN

[REDACTED]

DATE OF BIRTH

7.16.2007

DRIVER'S LICENSE NUMBER

[REDACTED]

STATE

OH

OWNER #2 - NAME (Last, First, Middle)

SAME AS DRIVER #2

Spigelmirer, Gabrielle P

PHONE

[REDACTED]

ADDRESS

1400 Housley Road

CITY

Stow

STATE

OH

ZIP

44224

SSN

[REDACTED]

DATE OF BIRTH

5.2.2003

DRIVER'S LICENSE NUMBER

[REDACTED]

STATE

OH

VEHICLE LICENSE #

JH 1993

STATE

OH

YEAR

2014

MAKE

Jeep

MODEL

Latitude

COLOR

BLACK

INSURANCE COMPANY

Sateco Ins

POLICY NUMBER

K4017583

PARTS OF VEHICLE DAMAGED

Front

CONTRIBUTING CIRCUMSTANCES

Failed to yield

DESCRIBE WHAT HAPPENED

Driver #1 and Driver #2 were in the parking lot of 3227 Graham Road. Driver #1 was driving southbound on the main drive of the parking lot. Driver #2 was westbound on a parking aisle. Driver #2 attempted to turn left (south) onto the main drive. Driver #2 struck Driver #1 at an angle.

See Reverse Side for Diagram

SUBMITTED BY:

B. Smith #1728

DATE

9.12.2023

APPROVING OFFICER:

Sgt. [Signature]

DATE

9/13/23

STOW POLICE DEPARTMENT

FIELD SKETCH (not drawn to scale)

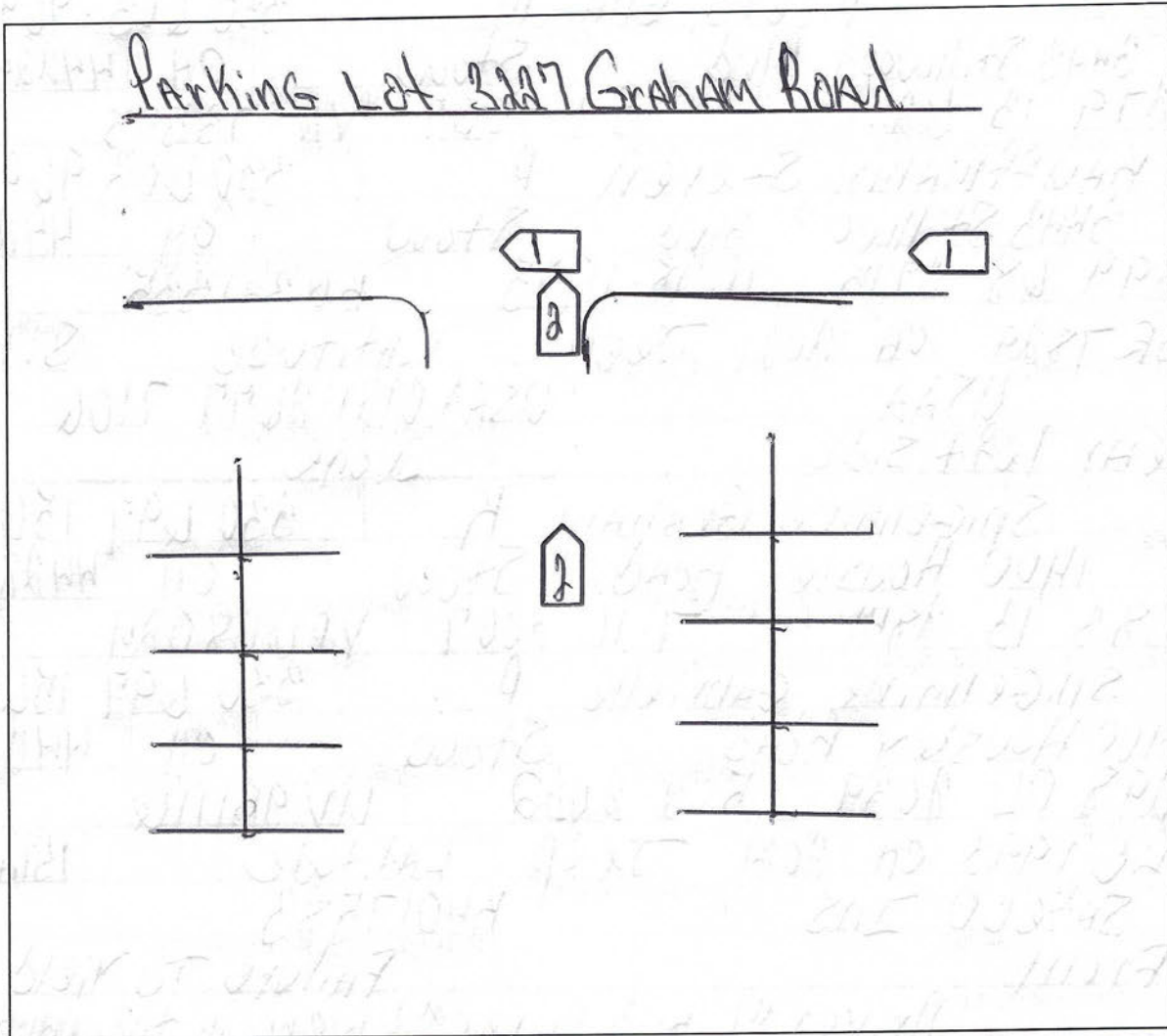

WEATHER

- CLEAR
- RAIN
- SNOW
- FOG
- OTHER

LIGHT

- DAYLIGHT
- DAWN
- DUSK
- DARK - LIGHTED ROAD
- DARK - NOT LIGHTED
- DARK - UNK LIGHTING
- UNKNOWN

SURFACE

- DRY
- WET
- SNOW
- ICE
- OTHER

ROAD

- CONCRETE
- BLACKTOP
- DIRT
- OTHER