



STOW POLICE DEPARTMENT

PRIVATE PROPERTY ACCIDENT REPORT/MINOR TRAFFIC ACCIDENT REPORT

INCIDENT NUMBER

2023-14387

DATE

8-15-2023

TIME

0652

 Private Property Private Property – Hit/Skip Minor Traffic Accident

LOCATION - ADDRESS

1376 Meadowbrook Blvd.

DRIVER #1 - NAME (Last, First, Middle)

Ronald Votchko

PHONE

ADDRESS

1376 Meadowbrook Blvd.

CITY

Stow

STATE

OH

ZIP

44224

SSN	DATE OF BIRTH	DRIVER'S LICENSE NUMBER	STATE
[REDACTED]	7/20/57	[REDACTED]	OH

OWNER #1 - NAME (Last, First, Middle) SAME AS DRIVER #1

PHONE

ADDRESS

CITY

STATE

ZIP

SSN

DATE OF BIRTH

DRIVER'S LICENSE NUMBER

STATE

VEHICLE LICENSE#

ESE1686

STATE

OH

YEAR

2014

MAKE

Hyundai

MODEL

Sonata

COLOR

Red

INSURANCE COMPANY

Unknown

POLICY NUMBER

Unknown

PARTS OF VEHICLE DAMAGED

None

CONTRIBUTING CIRCUMSTANCES

Driver was looking for his dog

DRIVER #2 - NAME (Last, First, Middle)

PHONE

ADDRESS

CITY

STATE

ZIP

SSN

DATE OF BIRTH

DRIVER'S LICENSE NUMBER

STATE

OWNER #2 - NAME (Last, First, Middle) SAME AS DRIVER #2

PHONE

ADDRESS

CITY

STATE

ZIP

SSN

DATE OF BIRTH

DRIVER'S LICENSE NUMBER

STATE

VEHICLE LICENSE #

STATE

YEAR

MAKE

MODEL

COLOR

INSURANCE COMPANY

POLICY NUMBER

PARTS OF VEHICLE DAMAGED

CONTRIBUTING CIRCUMSTANCES

DESCRIBE WHAT HAPPENED

I, along with FTO Smith, identified the owner of the red Hyundai Sonata, as Ronald Votchko. Officers responded to the residence of Ronald to make contact. Ronald stated he was looking for his dog and accidentally drove into the ditch in front of his residence. Ronald had no injuries. According to Ronald, this happened last night at approx. 2200 hours. Ronald was advised to get the vehicle removed as soon as possible.

See Reverse Side for Diagram

SUBMITTED BY:

[Signature] #768

DATE

08/15/2023

APPROVING OFFICER:

[Signature] 710

DATE

8/15/23

STOW POLICE DEPARTMENT

FIELD SKETCH (not drawn to scale)

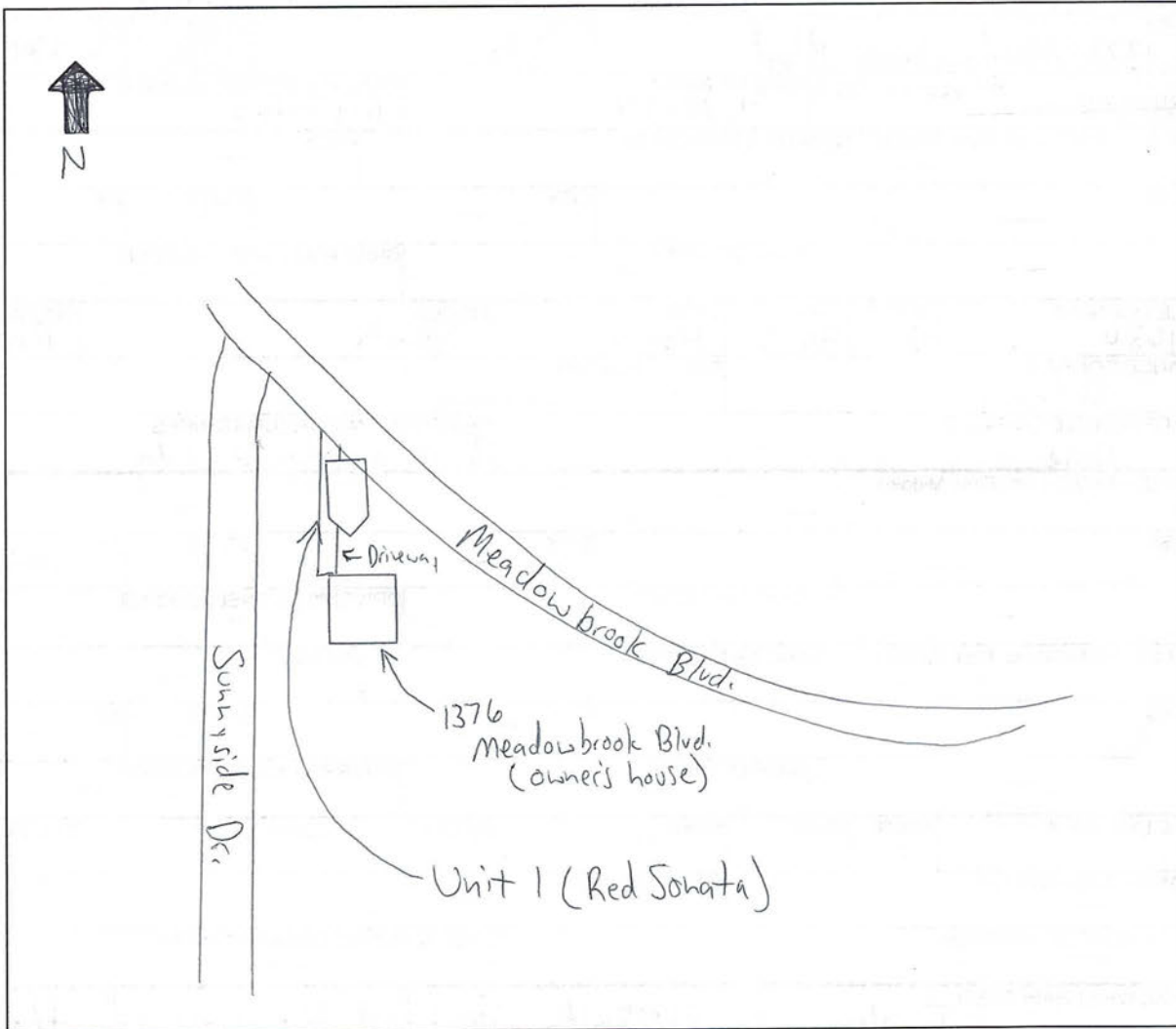

WEATHER

- CLEAR
- RAIN
- SNOW
- FOG
- OTHER

LIGHT

- DAYLIGHT
- DAWN
- DUSK
- DARK - LIGHTED ROAD
- DARK - NOT LIGHTED
- DARK - UNK LIGHTING
- UNKNOWN

SURFACE

- DRY
- WET
- SNOW
- ICE
- OTHER

ROAD

- CONCRETE
- BLACKTOP
- DIRT
- OTHER