



STOW POLICE DEPARTMENT

PRIVATE PROPERTY ACCIDENT REPORT/MINOR
TRAFFIC ACCIDENT REPORT

INCIDENT NUMBER
23 - 8976

DATE
5.20.23

TIME
1619

Private Property Private Property - Hit/Skip Minor Traffic Accident

LOCATION - ADDRESS
4097 BRIDGEWATER PKWY STOW, OH 44224 (HOME 2 SUITES)

VEHICLE #1

DRIVER #1 - NAME (Last, First, Middle) _____ PHONE _____

ADDRESS _____ CITY _____ STATE _____ ZIP _____

SSN _____ DATE OF BIRTH _____ DRIVER'S LICENSE NUMBER _____ STATE _____

OWNER #1 - NAME (Last, First, Middle) SAME AS DRIVER #1
HOME 2 SUITES BY HILTON PHONE _____

ADDRESS 4097 BRIDGEWATER PKWY CITY STOW STATE OH ZIP 44224

SSN _____ DATE OF BIRTH _____ DRIVER'S LICENSE NUMBER _____ STATE _____

VEHICLE LICENSE# _____ STATE _____ YEAR _____ MAKE _____ MODEL _____ COLOR _____

INSURANCE COMPANY _____ POLICY NUMBER _____

PARTS OF VEHICLE DAMAGED EAST SIDE OF AWNING CONTRIBUTING CIRCUMSTANCES _____

VEHICLE #2

DRIVER #2 - NAME (Last, First, Middle)
COLEMAN, AHJAHNA, DINICE PHONE _____

ADDRESS 4478 LONGLEAF RD. CITY CLEVELAND STATE OH ZIP 44128

SSN _____ DATE OF BIRTH 1.13.95 DRIVER'S LICENSE NUMBER _____ STATE OH

OWNER #2 - NAME (Last, First, Middle) SAME AS DRIVER #2
SYSCO LEASING LLC PHONE _____

ADDRESS 4000 W 62ND ST. CITY INDIANAPOLIS STATE OH ZIP 46268

SSN _____ DATE OF BIRTH _____ DRIVER'S LICENSE NUMBER _____ STATE _____

VEHICLE LICENSE # 256 1117 STATE IN YEAR 2018 MAKE VOLVO MODEL VNM COLOR WHITE

INSURANCE COMPANY ZURICH AMERICAN POLICY NUMBER BAP 2347204 13

PARTS OF VEHICLE DAMAGED NONE CONTRIBUTING CIRCUMSTANCES NONE

DESCRIBE WHAT HAPPENED

DRIVER #2 WAS PULLING UP TO THE FRONT DOOR OF THE HOME 2 SUITES TO DROP OFF A DELIVERY. AS THE TRUCK PULLED UNDER THE AWNING THE TOP PART OF THE TRAILER WAS TOO TALL AND SCRAPPED THE AWNING CAUSING DAMAGE. THE TRUCK WAS ABLE TO CLEAR UNDER THE OTHER SIDE OF THE AWNING WITHOUT ISSUE.

*** THE SIDE OF THE AWNING YOU SEE AS YOU PULL INTO THE PARKING LOT HAS A 13'-00" CLEARANCE SIGN WHICH IS THE SIDE THE TRUCK CLEARED. THE OPPOSITE SIDE OF THE AWNING DOES NOT HAVE A CLEARANCE SIGN.

See Reverse Side for Diagram

SUBMITTED BY: CPC. MARONA #755 DATE 5.20.23

APPROVING OFFICER:  #716 DATE 5-20-23

STOW POLICE DEPARTMENT

FIELD SKETCH (not drawn to scale)

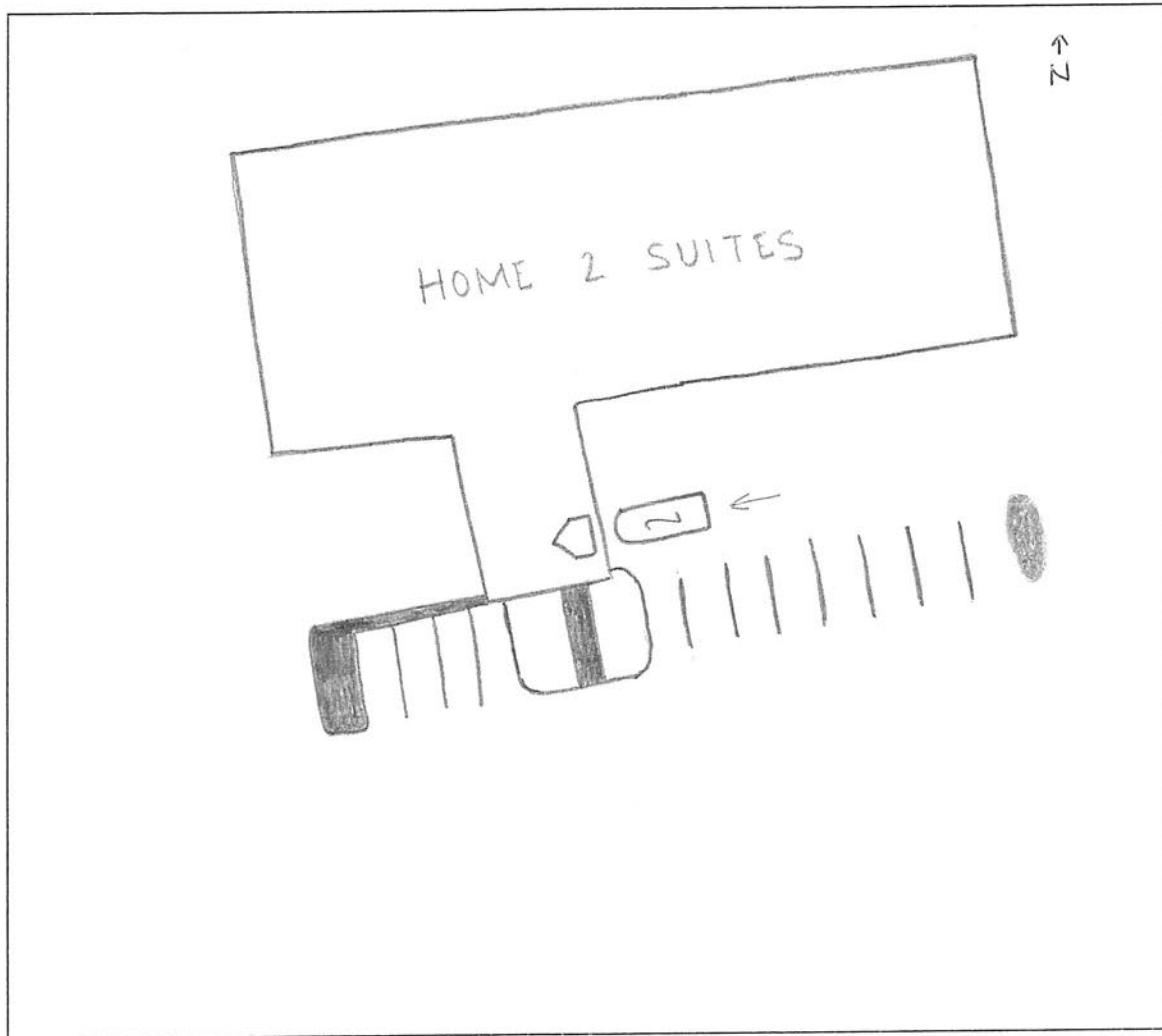

WEATHER

- CLEAR
- RAIN
- SNOW
- FOG
- OTHER

LIGHT

- DAYLIGHT
- DAWN
- DUSK
- DARK - LIGHTED ROAD
- DARK - NOT LIGHTED
- DARK - UNK LIGHTING
- UNKNOWN

SURFACE

- DRY
- WET
- SNOW
- ICE
- OTHER

ROAD

- CONCRETE
- BLACKTOP
- DIRT
- OTHER