



STOW POLICE DEPARTMENT

PRIVATE PROPERTY ACCIDENT REPORT/MINOR TRAFFIC ACCIDENT REPORT

INCIDENT NUMBER

77-6804

DATE

5/9/22

TIME

1406Hrs.

 Private Property
 Private Property - Hit/Skip
 Minor Traffic Accident

LOCATION - ADDRESS

3100 Block of Graham Rd. Stow OH 44224

DRIVER #1 - NAME (Last, First, Middle)

MEADE, SUSAN, C.

PHONE

ADDRESS

3139 Graham Rd.

CITY

STOW

STATE

OH

ZIP

44224

SSN

DATE OF BIRTH

12/16/54 67Yrs.

DRIVER'S LICENSE NUMBER

STATE

OH

VEHICLE #1

OWNER #1 - NAME (Last, First, Middle)

 SAME AS DRIVER #1

PHONE

ADDRESS

CITY

STATE

ZIP

SSN

DATE OF BIRTH

DRIVER'S LICENSE NUMBER

STATE

VEHICLE LICENSE#

FZK-2718

STATE

OH

YEAR

2013

MAKE

CHEVY

MODEL

MALIBU

COLOR

TAUPE

INSURANCE COMPANY

STATE FARM

POLICY NUMBER

C396641A1535B

PARTS OF VEHICLE DAMAGED

REAR CENTER

CONTRIBUTING CIRCUMSTANCES

NONE

DRIVER #2 - NAME (Last, First, Middle)

CASTELLO, ANDREW, P.

PHONE

ADDRESS

4392 N. Norman Dr.

CITY

STOW

STATE

OH

ZIP

44224

SSN

DATE OF BIRTH

4/28/04 18Yrs.

DRIVER'S LICENSE NUMBER

STATE

OH

VEHICLE #2

OWNER #2 - NAME (Last, First, Middle)

 SAME AS DRIVER #2

PHONE

ADDRESS

4392 N. Norman Dr.

CITY

STOW

STATE

OH

ZIP

44224

SSN

DATE OF BIRTH

8/30/70 51Yrs.

DRIVER'S LICENSE NUMBER

STATE

OH

VEHICLE LICENSE #

JBE 5177

STATE

OH

YEAR

2011

MAKE

CHEVY

MODEL

AVEO

COLOR

WHITE

INSURANCE COMPANY

THE GENERAL

POLICY NUMBER

K0H9533954

PARTS OF VEHICLE DAMAGED

FRONT

CONTRIBUTING CIRCUMSTANCES

ACDA

DESCRIBE WHAT HAPPENED

ON 4/27/22 AROUND 1730HRS. UNIT #1 WAS EASTBOUND ON GRAHAM RD. STOPPED AT 3139 TO TOW LEFT. UNIT #2 BEHIND UNIT #1 COLLIDED WITH THE REAR OF UNIT #1. BOTH PARTIES EXCHANGED INFO AND CLEARED THE SCENE.

See Reverse Side for Diagram

SUBMITTED BY

DR. JOE HOPKIN + 725

DATE

5/09/22

APPROVING OFFICER:

DATE

"

STOW POLICE DEPARTMENT

FIELD SKETCH (not drawn to scale)

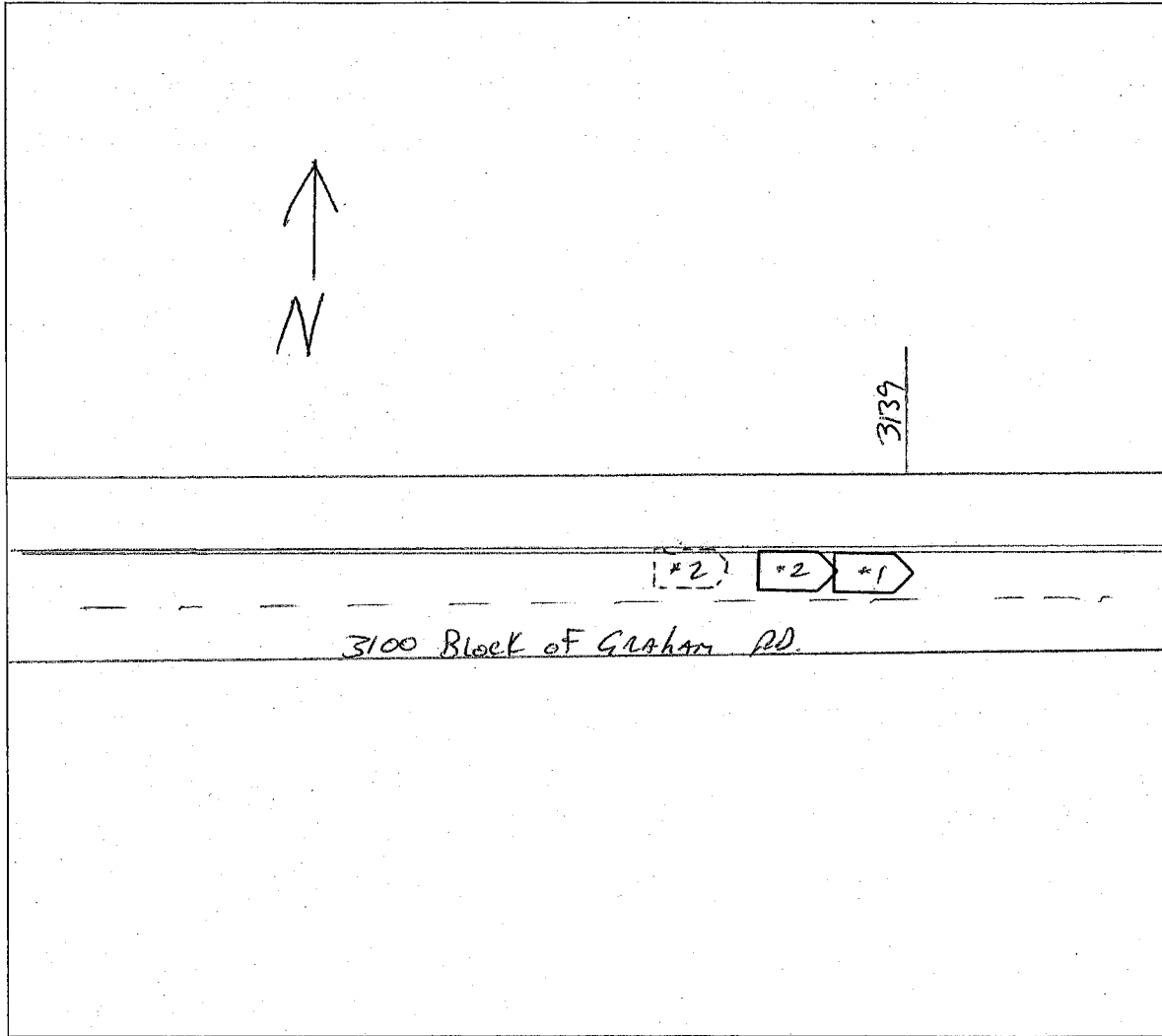

WEATHER

- CLEAR
- RAIN
- SNOW
- FOG
- OTHER

LIGHT

- DAYLIGHT
- DAWN
- DUSK
- DARK - LIGHTED ROAD
- DARK - NOT LIGHTED
- DARK - UNK LIGHTING
- UNKNOWN

SURFACE

- DRY
- WET
- SNOW
- ICE
- OTHER

ROAD

- CONCRETE
- BLACKTOP
- DIRT
- OTHER