



STOW POLICE DEPARTMENT

PRIVATE PROPERTY ACCIDENT REPORT/MINOR
TRAFFIC ACCIDENT REPORT

INCIDENT NUMBER **23-06057**
DATE **4.5.23** TIME **1020**

Private Property Private Property - Hit/Skip Minor Traffic Accident

LOCATION - ADDRESS
Akron General wellness Center, 4300 Allen Rd. Stow, OH 44224

VEHICLE #1

DRIVER #1 - NAME (Last, First, Middle) **N/A** PHONE

ADDRESS CITY STATE ZIP

SSN DATE OF BIRTH DRIVER'S LICENSE NUMBER STATE

OWNER #1 - NAME (Last, First, Middle) SAME AS DRIVER #1 **Bollini, Joseph David** PHONE

ADDRESS **218 North Ave.** CITY **Tallmadge** STATE **OH** ZIP **44278**

SSN DATE OF BIRTH **2-13-84** DRIVER'S LICENSE NUMBER STATE **OH**

VEHICLE LICENSE# **GNT 7610** STATE **OH** YEAR **2019** MAKE **Subaru** MODEL **Outback** COLOR **Tan**

INSURANCE COMPANY **Liberty Mutual** POLICY NUMBER **AOV28184918045**

PARTS OF VEHICLE DAMAGED **Driver-side rear** CONTRIBUTING CIRCUMSTANCES **None (parked/unoccupied)**

VEHICLE #2

DRIVER #2 - NAME (Last, First, Middle) **UNKNOWN** PHONE

ADDRESS CITY STATE ZIP

SSN DATE OF BIRTH DRIVER'S LICENSE NUMBER STATE

OWNER #2 - NAME (Last, First, Middle) SAME AS DRIVER #2 PHONE

ADDRESS CITY STATE ZIP

SSN DATE OF BIRTH DRIVER'S LICENSE NUMBER STATE

VEHICLE LICENSE# STATE YEAR MAKE MODEL COLOR

INSURANCE COMPANY POLICY NUMBER

PARTS OF VEHICLE DAMAGED CONTRIBUTING CIRCUMSTANCES

DESCRIBE WHAT HAPPENED

On 4-5-23, Mr. Bollini called to report damage to his vehicle, which he believes occurred as a result of a hit-skip. He stated he believes his car was hit while it was parked and unoccupied at the Akron General wellness Center yesterday, between 1830 and 1930 hours.

I called and spoke to security regarding surveillance video. I was told their cameras did not capture anything at that time in that area.

See Reverse Side for Diagram

SUBMITTED BY: **Ginther, 715** DATE **4-5-23**

APPROVING OFFICER: **[Signature] 210** DATE **4/5/23**

STOW POLICE DEPARTMENT

FIELD SKETCH (not drawn to scale)

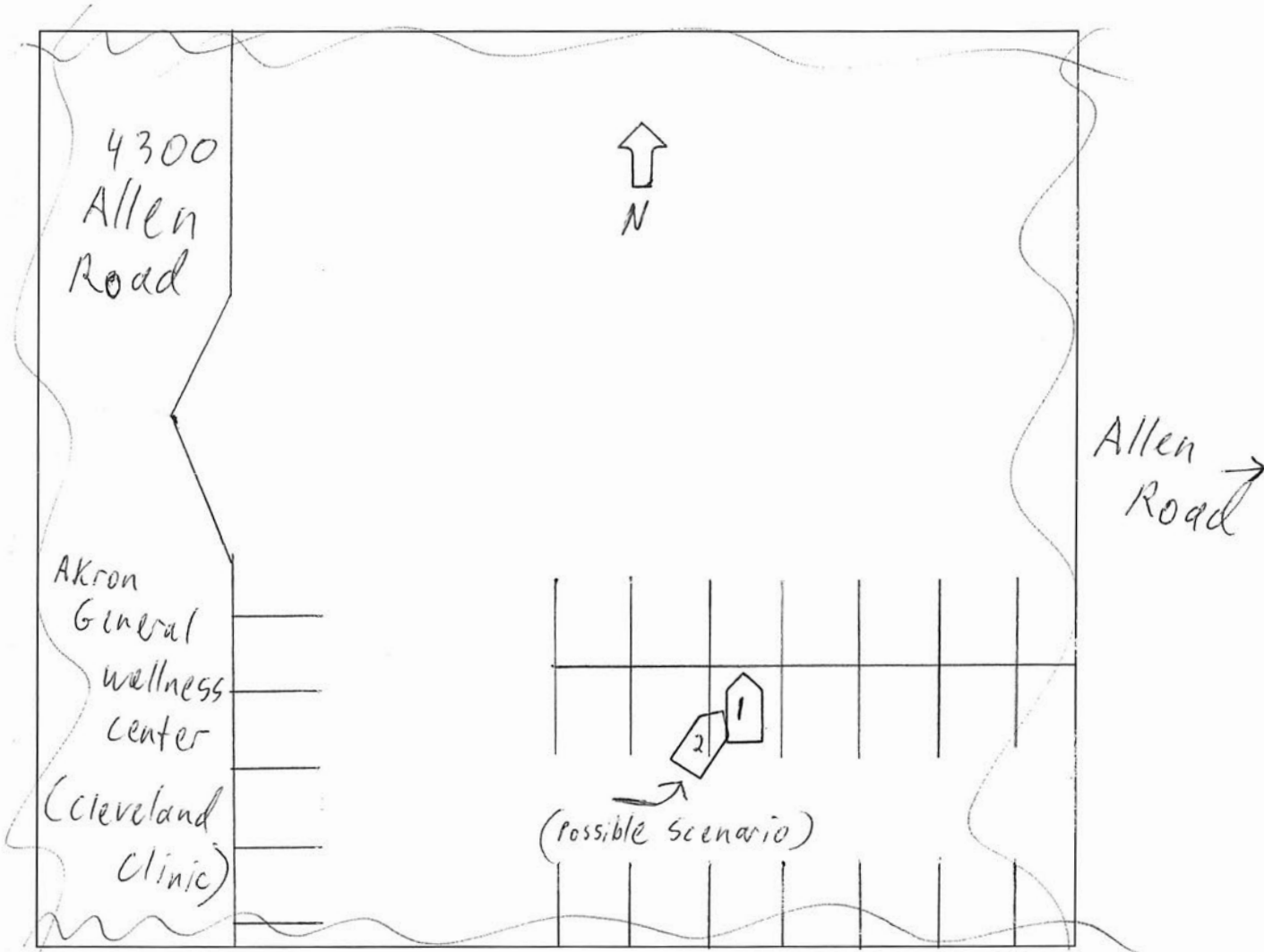

WEATHER

- CLEAR
- RAIN
- SNOW
- FOG
- OTHER

LIGHT

- DAYLIGHT
- DAWN
- DUSK
- DARK - LIGHTED ROAD
- DARK - NOT LIGHTED
- DARK - UNK LIGHTING
- UNKNOWN

SURFACE

- DRY
- WET
- SNOW
- ICE
- OTHER

ROAD

- CONCRETE
- BLACKTOP
- DIRT
- OTHER