



# STOW POLICE DEPARTMENT

PRIVATE PROPERTY ACCIDENT REPORT/MINOR  
TRAFFIC ACCIDENT REPORT

INCIDENT NUMBER **22-06023**  
DATE **4/29/22** TIME **2147**

Private Property  Private Property - Hit/Skip  Minor Traffic Accident

LOCATION - ADDRESS **4300 LAKEPOINT CORPORATE DR.**

DRIVER #1 - NAME (Last, First, Middle) **PARKED UNOCCUPIED** PHONE  
ADDRESS CITY STATE ZIP  
SSN DATE OF BIRTH DRIVER'S LICENSE NUMBER STATE

VEHICLE #1

OWNER #1 - NAME (Last, First, Middle)  SAME AS DRIVER #1 PHONE  
**HELL, JENNIFER ANN**  
ADDRESS **6025 HILLMAN RD.** CITY **AKRON** STATE **OH** ZIP **44312**  
SSN DATE OF BIRTH **2/20/83** DRIVER'S LICENSE NUMBER STATE **OH**  
VEHICLE LICENSE# **OHW4P40** STATE **OH** YEAR **2002** MAKE **CHEVY** MODEL **CAMARO** COLOR **BLACK**  
INSURANCE COMPANY **GRANGE** POLICY NUMBER **476333P**

PARTS OF VEHICLE DAMAGED **LEFT FRONT** CONTRIBUTING CIRCUMSTANCES **NONE**

VEHICLE #2

DRIVER #2 - NAME (Last, First, Middle) **HIT SKIP VEHICLE** PHONE  
ADDRESS CITY STATE ZIP  
SSN DATE OF BIRTH DRIVER'S LICENSE NUMBER STATE

OWNER #2 - NAME (Last, First, Middle)  SAME AS DRIVER #2 PHONE  
ADDRESS CITY STATE ZIP  
SSN DATE OF BIRTH DRIVER'S LICENSE NUMBER STATE  
VEHICLE LICENSE # STATE YEAR MAKE MODEL COLOR  
INSURANCE COMPANY POLICY NUMBER

PARTS OF VEHICLE DAMAGED CONTRIBUTING CIRCUMSTANCES **STARTING & BACKING**

DESCRIBE WHAT HAPPENED  
**UNIT #1 WAS PARKED, UNOCCUPIED IN A PARKING SPACE AT 4300 LAKEPOINT CORPORATE DR. AN UNKNOWN VEHICLE STRUCK UNIT #1 THEN LEFT THE SCENE.**

See Reverse Side for Diagram

SUBMITTED BY: **[Signature] #753** DATE **4/29/22**  
APPROVING OFFICER: **[Signature] 716** DATE **4-29-22**

# STOW POLICE DEPARTMENT

FIELD SKETCH (not drawn to scale)

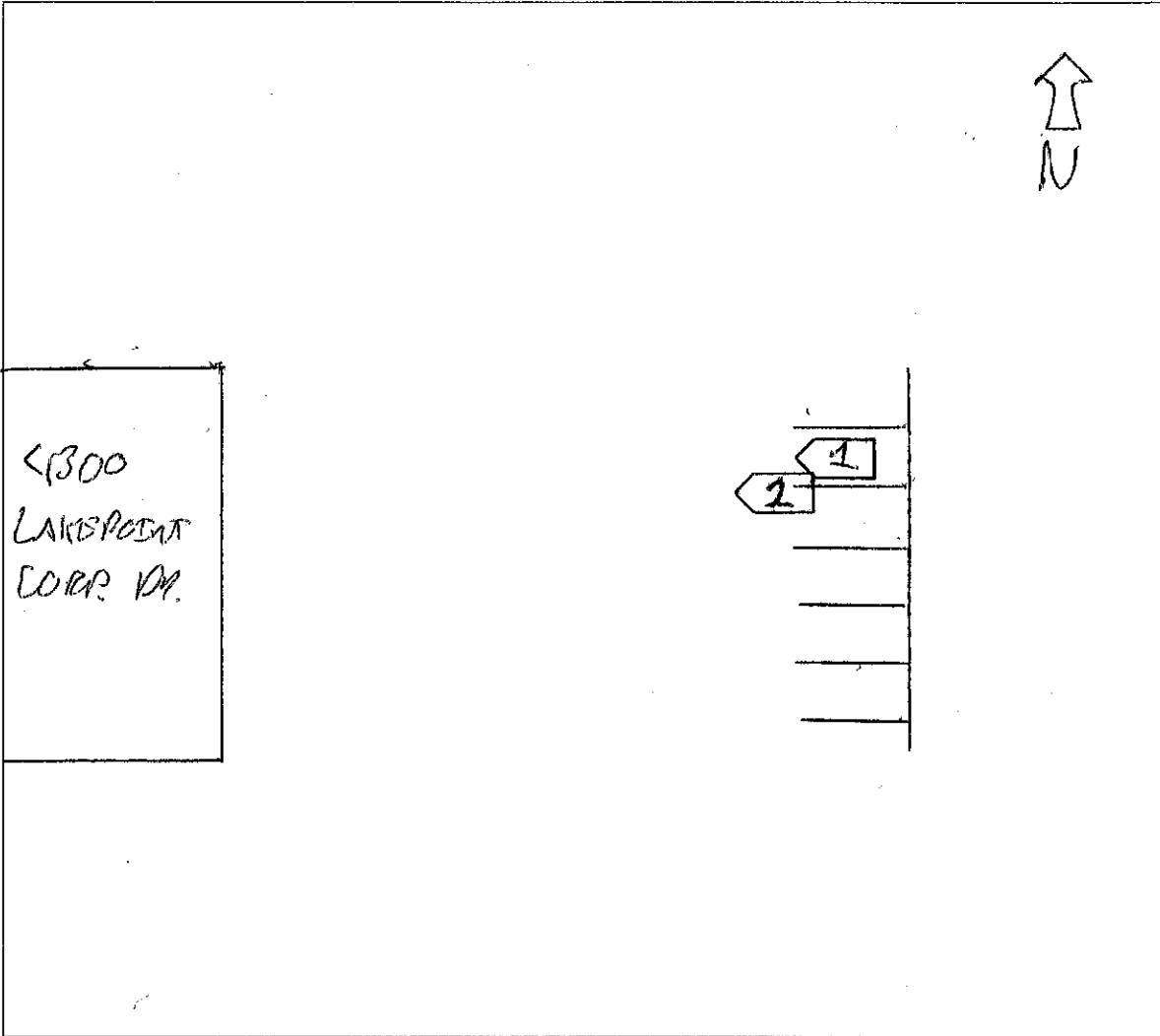

## WEATHER

- CLEAR
- RAIN
- SNOW
- FOG
- OTHER

## LIGHT

- DAYLIGHT
- DAWN
- DUSK
- DARK - LIGHTED ROAD
- DARK - NOT LIGHTED
- DARK - UNK LIGHTING
- UNKNOWN

## SURFACE

- DRY
- WET
- SNOW
- ICE
- OTHER

## ROAD

- CONCRETE
- BLACKTOP
- DIRT
- OTHER