



# STOW POLICE DEPARTMENT

PRIVATE PROPERTY ACCIDENT REPORT/MINOR  
TRAFFIC ACCIDENT REPORT

INCIDENT NUMBER

23-3860

DATE

03/03/23

TIME

1742

Private Property  Private Property - Hit/Skip  Minor Traffic Accident

LOCATION - ADDRESS

750 E Steels Corners Rd, Stow, OH 44224

DRIVER #1 - NAME (Last, First, Middle)

Laenheer, Logan, Thomas

PHONE

[REDACTED]

ADDRESS

1146 McShane Dr

CITY

Cuyahoga Falls

STATE

OH

ZIP

44221

SSN

[REDACTED]

DATE OF BIRTH

07/20/06

DRIVER'S LICENSE NUMBER

[REDACTED]

STATE

OH

VEHICLE #1

OWNER #1 - NAME (Last, First, Middle)  SAME AS DRIVER #1

Laenheer, Thomas Raymond

PHONE

[REDACTED]

ADDRESS

406 Isabella Ct

CITY

Zellianopa

STATE

PA

ZIP

16063

SSN

-

DATE OF BIRTH

-

DRIVER'S LICENSE NUMBER

-

STATE

-

VEHICLE LICENSE#

LK0752

STATE

PA

YEAR

2014

MAKE

Subaru

MODEL

Crosstrek

COLOR

White

INSURANCE COMPANY

Ene Insurance

POLICY NUMBER

Q115608662

PARTS OF VEHICLE DAMAGED

Rear bumper

CONTRIBUTING CIRCUMSTANCES

Improper backing

DRIVER #2 - NAME (Last, First, Middle)

Unknown

PHONE

-

ADDRESS

-

CITY

-

STATE

-

ZIP

-

SSN

-

DATE OF BIRTH

-

DRIVER'S LICENSE NUMBER

-

STATE

-

VEHICLE #2

OWNER #2 - NAME (Last, First, Middle)  SAME AS DRIVER #2

PHONE

-

ADDRESS

-

CITY

-

STATE

-

ZIP

-

SSN

-

DATE OF BIRTH

-

DRIVER'S LICENSE NUMBER

-

STATE

-

VEHICLE LICENSE #

Unknown

STATE

-

YEAR

-

MAKE

-

MODEL

-

COLOR

Blue

INSURANCE COMPANY

-

POLICY NUMBER

-

PARTS OF VEHICLE DAMAGED

Possible front bumper damage

CONTRIBUTING CIRCUMSTANCES

N/A

DESCRIBE WHAT HAPPENED

Unit #1 was backing northbound out of a parking space in the lot of 750 E Steels Corners Rd. Unit #2 was traveling eastbound through the same lot. Unit #1 improperly backed up, causing unit #2 to strike it in the rear.

Both units stopped and exchanged information. However, Unit #2 did not provide identifiable info. Unit #1 reported the incident after the fact. See Reverse Side for Diagram

SUBMITTED BY:

Ofc WILK #761

DATE

03/12/23

APPROVING OFFICER:

[Signature]

DATE

3/12/23

# STOW POLICE DEPARTMENT

## FIELD SKETCH (not drawn to scale)

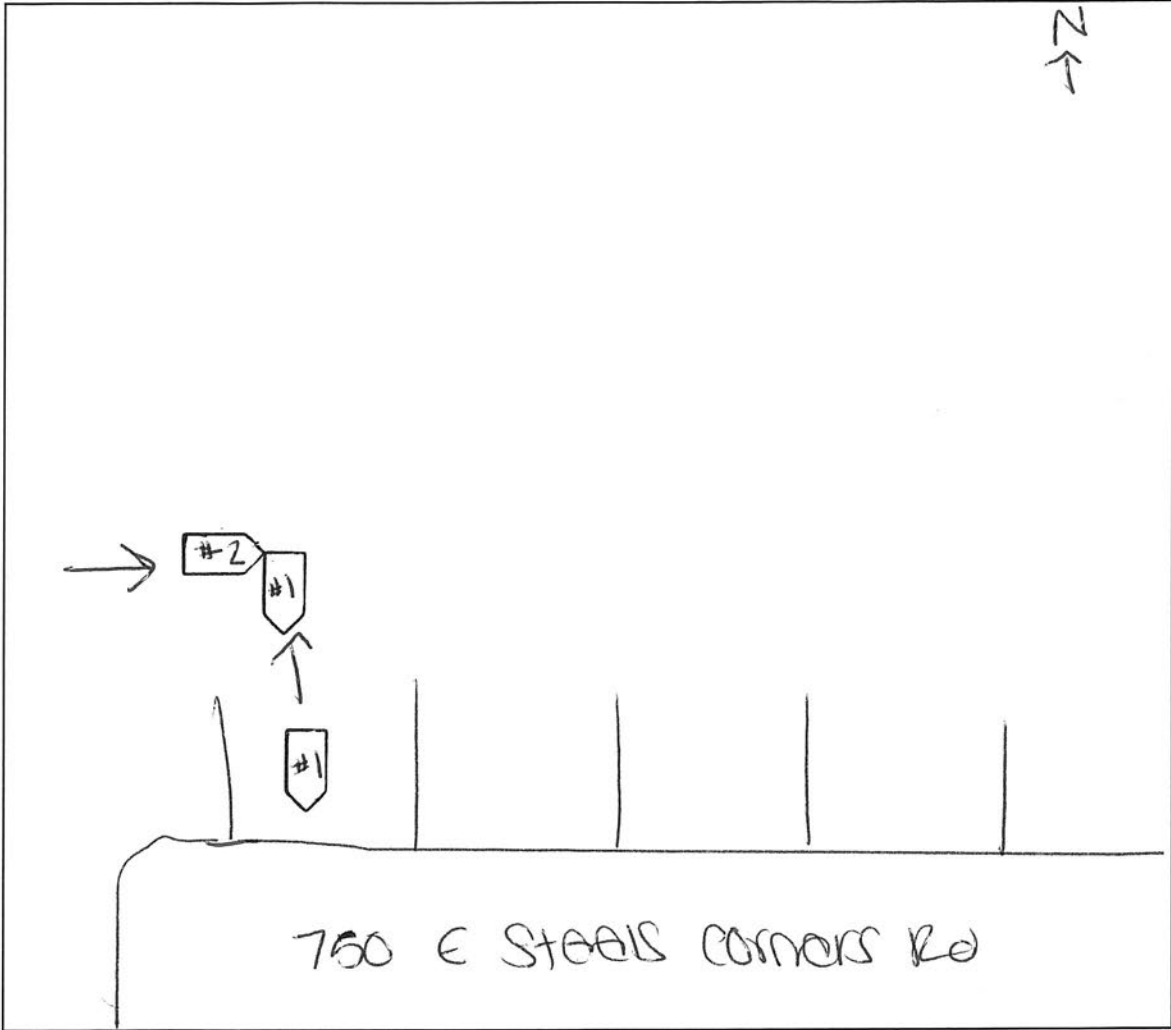

### WEATHER

- CLEAR
- RAIN
- SNOW
- FOG
- OTHER

### LIGHT

- DAYLIGHT
- DAWN
- DUSK
- DARK - LIGHTED ROAD
- DARK - NOT LIGHTED
- DARK - UNK LIGHTING
- UNKNOWN

### SURFACE

- DRY
- WET
- SNOW
- ICE
- OTHER

### ROAD

- CONCRETE
- BLACKTOP
- DIRT
- OTHER