



STOW POLICE DEPARTMENT

PRIVATE PROPERTY ACCIDENT REPORT/MINOR
TRAFFIC ACCIDENT REPORT

INCIDENT NUMBER

23-03704

DATE

3/1/23

TIME

1054

Private Property Private Property - Hit/Skip Minor Traffic Accident

LOCATION - ADDRESS

Fairfield 4170 Steels Pointe Stow, OH 44224

VEHICLE #1

DRIVER #1 - NAME (Last, First, Middle)

McLeod, Ann, H

PHONE

ADDRESS

1520 Raleigh Blvd

CITY

Copley

STATE

OH

ZIP

44321

SSN

[REDACTED]

DATE OF BIRTH

12/16/65

DRIVER'S LICENSE NUMBER

[REDACTED]

STATE

OH

OWNER #1 - NAME (Last, First, Middle)

SAME AS DRIVER #1

PHONE

ADDRESS

CITY

STATE

ZIP

SSN

DATE OF BIRTH

DRIVER'S LICENSE NUMBER

STATE

VEHICLE LICENSE#

GYZ 1450

STATE

OH

YEAR

2015

MAKE

Hyundai

MODEL

Sonata

COLOR

BLK

INSURANCE COMPANY

Allstate

POLICY NUMBER

992 181 736

PARTS OF VEHICLE DAMAGED

Possibly the undercarriage

CONTRIBUTING CIRCUMSTANCES

Failure To Control

VEHICLE #2

DRIVER #2 - NAME (Last, First, Middle)

PHONE

ADDRESS

CITY

STATE

ZIP

SSN

DATE OF BIRTH

DRIVER'S LICENSE NUMBER

STATE

OWNER #2 - NAME (Last, First, Middle)

SAME AS DRIVER #2

PHONE

ADDRESS

CITY

STATE

ZIP

SSN

DATE OF BIRTH

DRIVER'S LICENSE NUMBER

STATE

VEHICLE LICENSE #

STATE

YEAR

MAKE

MODEL

COLOR

INSURANCE COMPANY

POLICY NUMBER

PARTS OF VEHICLE DAMAGED

CONTRIBUTING CIRCUMSTANCES

DESCRIBE WHAT HAPPENED

Veh #1 was eastbound on Steels Pointe and turned right (south) into the driveway to Fairfield, 4170 Steels Pointe. The driver of the vehicle lost control as the vehicle struck a curb and became stuck on a large rock near the entrance.

See Reverse Side for Diagram

SUBMITTED BY:

Pic B Handix 736

DATE

3/1/23

APPROVING OFFICER:

[Signature]

DATE

STOW POLICE DEPARTMENT

FIELD SKETCH (not drawn to scale)

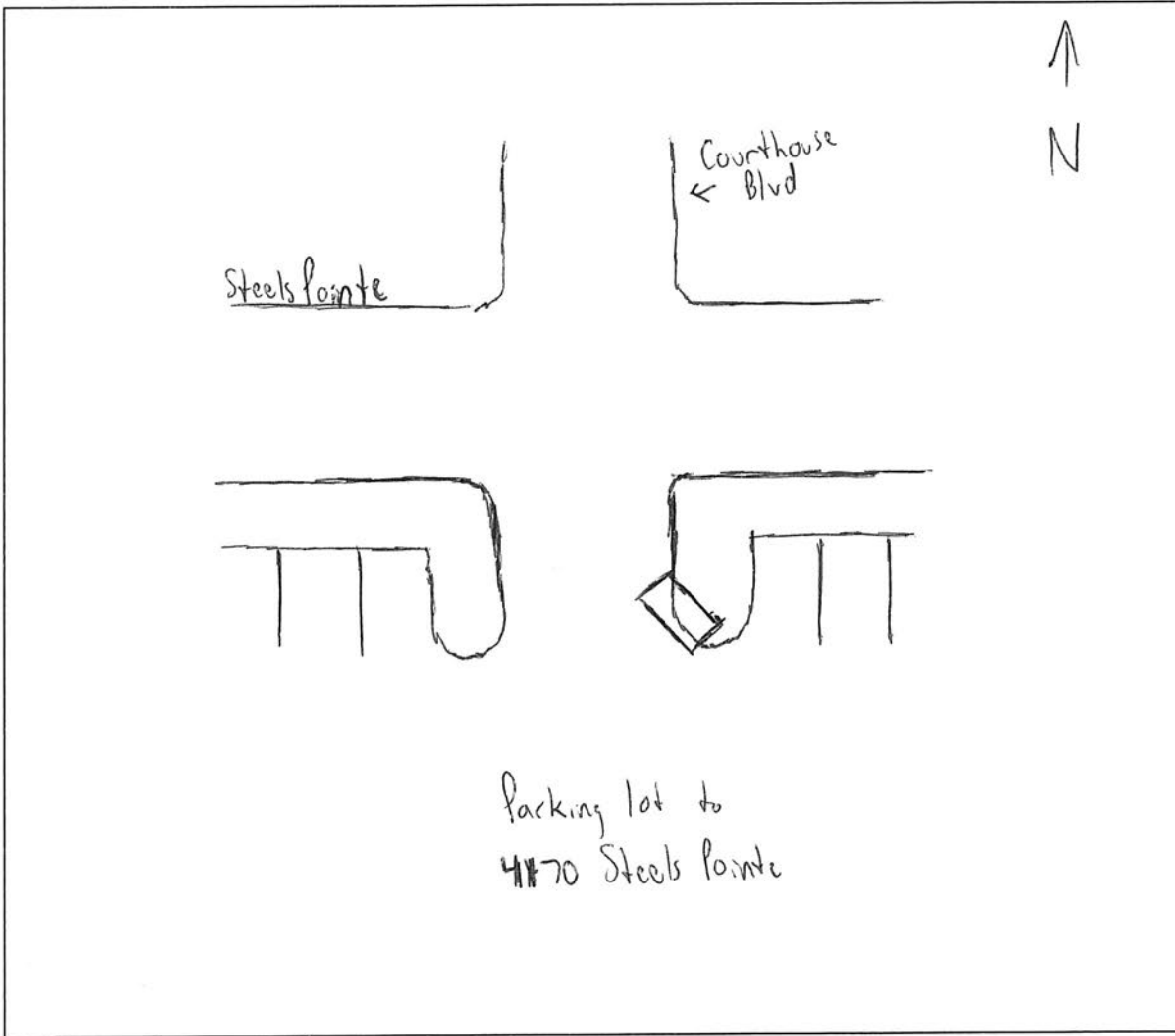

WEATHER

- CLEAR
- RAIN
- SNOW
- FOG
- OTHER

LIGHT

- DAYLIGHT
- DAWN
- DUSK
- DARK - LIGHTED ROAD
- DARK - NOT LIGHTED
- DARK - UNK LIGHTING
- UNKNOWN

SURFACE

- DRY
- WET
- SNOW
- ICE
- OTHER

ROAD

- CONCRETE
- BLACKTOP
- DIRT
- OTHER