



STOW POLICE DEPARTMENT

PRIVATE PROPERTY ACCIDENT REPORT/MINOR
TRAFFIC ACCIDENT REPORT

INCIDENT NUMBER
22-20038

DATE 12-14-22 TIME 1144

Private Property Private Property - Hit/Skip Minor Traffic Accident

LOCATION - ADDRESS
Homewood Ave. at Acorn Pl.

VEHICLE #1

DRIVER #1 - NAME (Last, First, Middle)
Heinz, Timothy Robert

ADDRESS 1709 Lancaster Dr. CITY Youngstown STATE OH ZIP 44511

SSN [REDACTED] DATE OF BIRTH 9-26-66 DRIVER'S LICENSE NUMBER VE052406 STATE OH

OWNER #1 - NAME (Last, First, Middle) SAME AS DRIVER #1
USIC

ADDRESS 3647 Bracksville Rd. Unit B CITY Richfield STATE OH ZIP 44286

SSN [REDACTED] DATE OF BIRTH [REDACTED] DRIVER'S LICENSE NUMBER [REDACTED] STATE [REDACTED]

VEHICLE LICENSE # [REDACTED] STATE TX YEAR 2022 MAKE Chevy MODEL Colorado COLOR White

INSURANCE COMPANY [REDACTED] POLICY NUMBER [REDACTED]

PARTS OF VEHICLE DAMAGED Right front bumper CONTRIBUTING CIRCUMSTANCES Driver inattention

VEHICLE #2

DRIVER #2 - NAME (Last, First, Middle)
M. Campbell Contractors

ADDRESS 700 McCauley Rd. CITY Stow STATE OH ZIP 44224

SSN [REDACTED] DATE OF BIRTH [REDACTED] DRIVER'S LICENSE NUMBER [REDACTED] STATE [REDACTED]

OWNER #2 - NAME (Last, First, Middle) SAME AS DRIVER #2
M. Campbell Contractors

VEHICLE LICENSE # N/A STATE YEAR MAKE Komatsu MODEL WA200Z COLOR Yellow

INSURANCE COMPANY [REDACTED] POLICY NUMBER [REDACTED]

PARTS OF VEHICLE DAMAGED Right rear bumper CONTRIBUTING CIRCUMSTANCES

DESCRIBE WHAT HAPPENED
Unit #1 was travelling southbound on Homewood Ave. through a construction zone. Near the intersection of Acorn Pl, Unit #1 attempted to drive between Unit #2 (an unoccupied construction front end loader) and a telephone pole. Unit #1 side-swiped Unit #2 as a result causing minor damage to both units.

See Reverse Side for Diagram

SUBMITTED BY: Murphy #738 DATE 12-14-22

APPROVING OFFICER: [Signature] DATE 12/16/22

STOW POLICE DEPARTMENT

FIELD SKETCH (not drawn to scale)

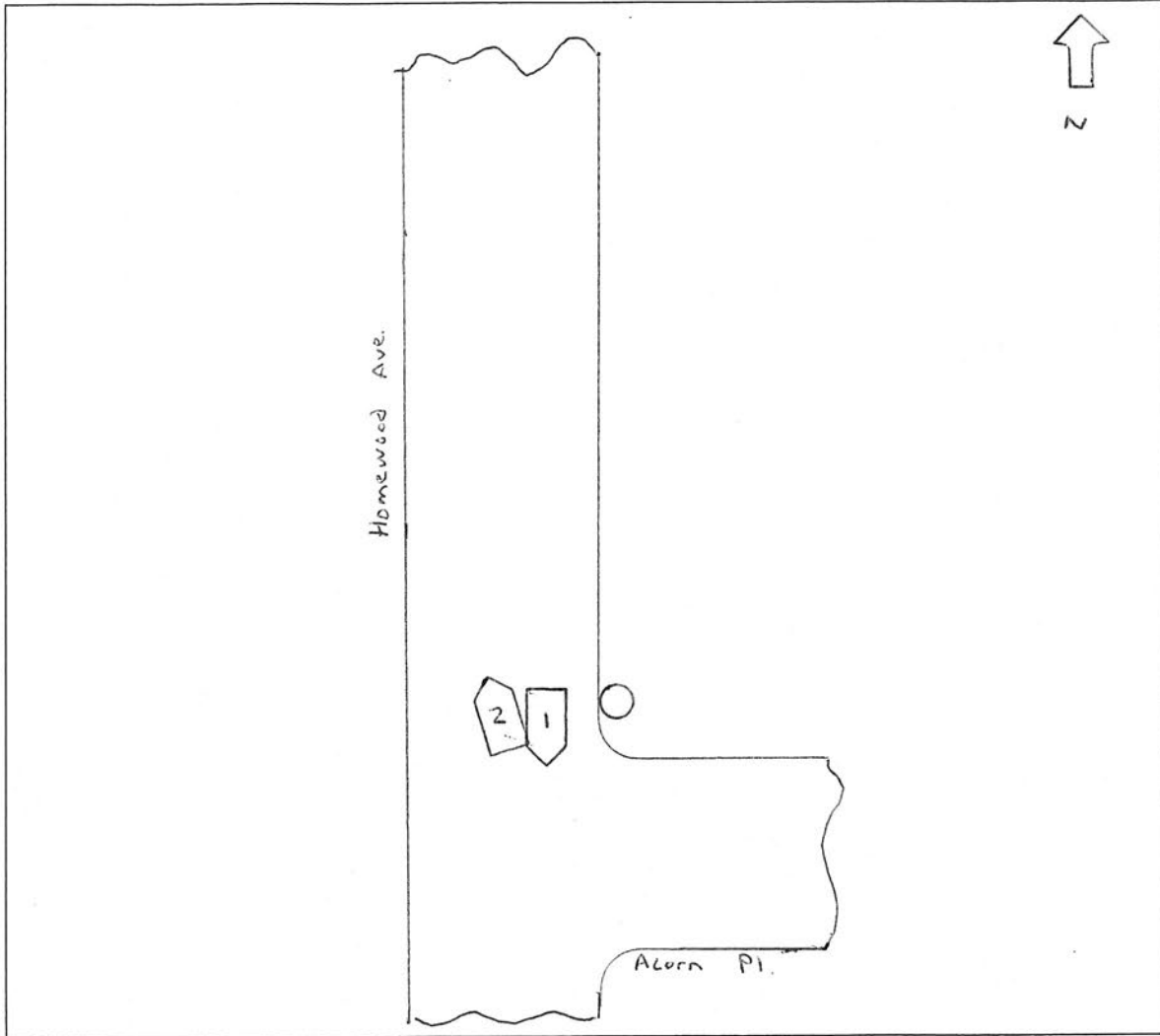

WEATHER

- CLEAR
- RAIN
- SNOW
- FOG
- OTHER

LIGHT

- DAYLIGHT
- DAWN
- DUSK
- DARK - LIGHTED ROAD
- DARK - NOT LIGHTED
- DARK - UNK LIGHTING
- UNKNOWN

SURFACE

- DRY
- WET
- SNOW
- ICE
- OTHER

ROAD

- CONCRETE
- BLACKTOP
- DIRT
- OTHER