



# STOW POLICE DEPARTMENT

PRIVATE PROPERTY ACCIDENT REPORT/MINOR TRAFFIC ACCIDENT REPORT

INCIDENT NUMBER: 22-19380  
 DATE: 12/03/22 TIME: 2108

Private Property  Private Property - Hit/Skip  Minor Traffic Accident

LOCATION - ADDRESS  
3399 Hiwood Ave

DRIVER #1 - NAME (Last, First, Middle): OROS, Taylor, Jade  
 ADDRESS: 157 Lindsey Rd  
 CITY: Munroe Falls STATE: OH ZIP: 44262  
 SSN: [REDACTED] DATE OF BIRTH: 01/29/1996  
 DRIVER'S LICENSE NUMBER: [REDACTED] STATE: OH

VEHICLE #1  
 OWNER #1 - NAME (Last, First, Middle)  SAME AS DRIVER #1: OROS, Ian, Miguel  
 ADDRESS: 157 Lindsey Rd  
 CITY: Munroe Falls STATE: OH ZIP: 44262  
 SSN: [REDACTED] DATE OF BIRTH: 11/07/97  
 DRIVER'S LICENSE NUMBER: [REDACTED] STATE: OH  
 VEHICLE LICENSE#: JLP 1216 STATE: OH YEAR: 2022 MAKE: Honda MODEL: Odyssey COLOR: Black  
 INSURANCE COMPANY: Allstate POLICY NUMBER: 826163552

PARTS OF VEHICLE DAMAGED: front right bumper CONTRIBUTING CIRCUMSTANCES: failure to control

DRIVER #2 - NAME (Last, First, Middle):  
 ADDRESS:  
 CITY: STATE: ZIP:  
 SSN: DATE OF BIRTH: DRIVER'S LICENSE NUMBER: STATE:

VEHICLE #2  
 OWNER #2 - NAME (Last, First, Middle)  SAME AS DRIVER #2:  
 ADDRESS:  
 CITY: STATE: ZIP:  
 SSN: DATE OF BIRTH: DRIVER'S LICENSE NUMBER: STATE:  
 VEHICLE LICENSE #: STATE: YEAR: MAKE: MODEL: COLOR:  
 INSURANCE COMPANY: POLICY NUMBER:

PARTS OF VEHICLE DAMAGED: CONTRIBUTING CIRCUMSTANCES:

DESCRIBE WHAT HAPPENED

Unit #1 was traveling north on Hiwood Ave near 3399 Hiwood Ave. Unit #1 ran off the road right, failing to control the vehicle. Unit #1 stated another vehicle went left of center while traveling south in the same area. Unit #1 stated they left the roadway to avoid a collision. Unit #1 stated the damage to the vehicle was minor.

See Reverse Side for Diagram

SUBMITTED BY: Ofc. Wika #761 DATE: 12/03/22

APPROVING OFFICER: Ginter, 715 DATE: 12-3-22

# STOW POLICE DEPARTMENT

## FIELD SKETCH (not drawn to scale)

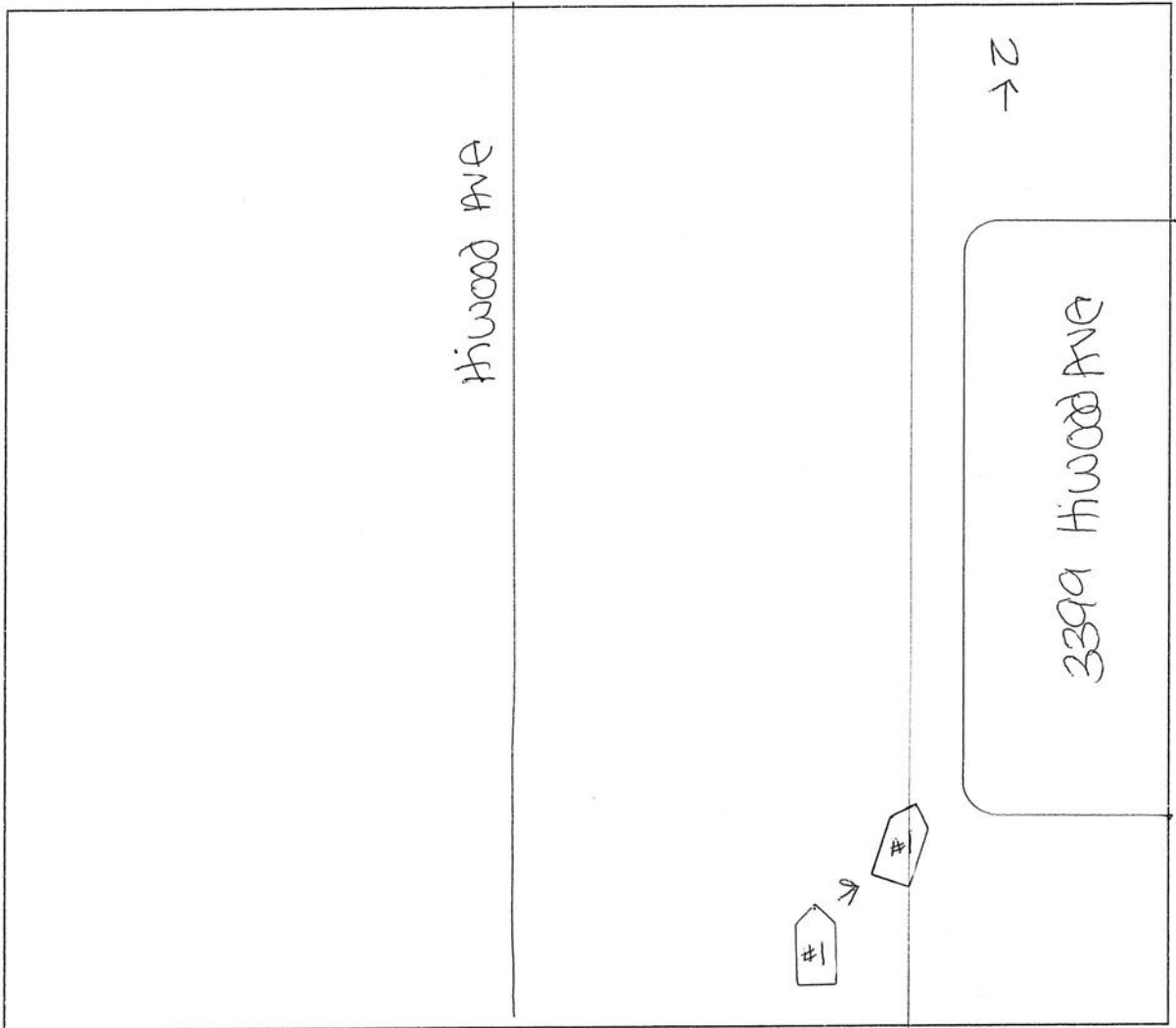

### WEATHER

- CLEAR
- RAIN
- SNOW
- FOG
- OTHER

### LIGHT

- DAYLIGHT
- DAWN
- DUSK
- DARK - LIGHTED ROAD
- DARK - NOT LIGHTED
- DARK - UNK LIGHTING
- UNKNOWN

### SURFACE

- DRY
- WET
- SNOW
- ICE
- OTHER

### ROAD

- CONCRETE
- BLACKTOP
- DIRT
- OTHER