



# STOW POLICE DEPARTMENT

PRIVATE PROPERTY ACCIDENT REPORT/MINOR  
TRAFFIC ACCIDENT REPORT

INCIDENT NUMBER

22-3896

DATE

03/20/22

TIME

1505

Private Property    Private Property - Hit/Skip    Minor Traffic Accident

LOCATION - ADDRESS

4338 Kent Rd Stow, OH 44224

DRIVER #1 - NAME (Last, First, Middle)

Winland, Lavetta, Kay

ADDRESS

5141 Newton Falls Rd Lot 58

CITY

Ravenna

STATE

OH

ZIP

44266

SSN

DATE OF BIRTH

02/11/63

DRIVER'S LICENSE NUMBER

STATE

OH

PHONE

OWNER #1 - NAME (Last, First, Middle)    SAME AS DRIVER #1

Winland, Thomas, Michael

ADDRESS

5141 Newton Falls Rd Lot 58

CITY

Ravenna

STATE

OH

ZIP

44266

SSN

DATE OF BIRTH

02/05/62

DRIVER'S LICENSE NUMBER

STATE

OH

VEHICLE LICENSE #

GGW2658

STATE

OH

YEAR

2012

MAKE

Dodge

MODEL

Ram

COLOR

Black

INSURANCE COMPANY

The General

POLICY NUMBER

OH 3409100

PARTS OF VEHICLE DAMAGED

Front left bumper

CONTRIBUTING CIRCUMSTANCES

Failure to yield

DRIVER #2 - NAME (Last, First, Middle)

Waynesboro, Tara, Anne Hogue

ADDRESS

588 Meadow Glen Ln

CITY

Tallmadge

STATE

OH

ZIP

44278

SSN

DATE OF BIRTH

05/14/86

DRIVER'S LICENSE NUMBER

STATE

OH

PHONE

OWNER #2 - NAME (Last, First, Middle)    SAME AS DRIVER #2

ADDRESS

CITY

STATE

ZIP

SSN

DATE OF BIRTH

DRIVER'S LICENSE NUMBER

STATE

VEHICLE LICENSE #

HAB1757

STATE

OH

YEAR

2016

MAKE

Nissan

MODEL

Rogue

COLOR

Black

INSURANCE COMPANY

Liberty Mutual

POLICY NUMBER

AOV - 281-523683-4017

PARTS OF VEHICLE DAMAGED

Front right bumper

CONTRIBUTING CIRCUMSTANCES

Failure to yield

DESCRIBE WHAT HAPPENED

Unit # 1 was traveling eastbound in the parking lot south of 4338 Kent Rd. Unit # 2 was traveling southbound in the same parking lot. Both units failed to yield, striking each other.

See Reverse Side for Diagram

SUBMITTED BY:

Ofc. Wike # 701

DATE

03/20/22

APPROVING OFFICER:

Ginter, 715

DATE

3-20-22

# STOW POLICE DEPARTMENT

## FIELD SKETCH (not drawn to scale)

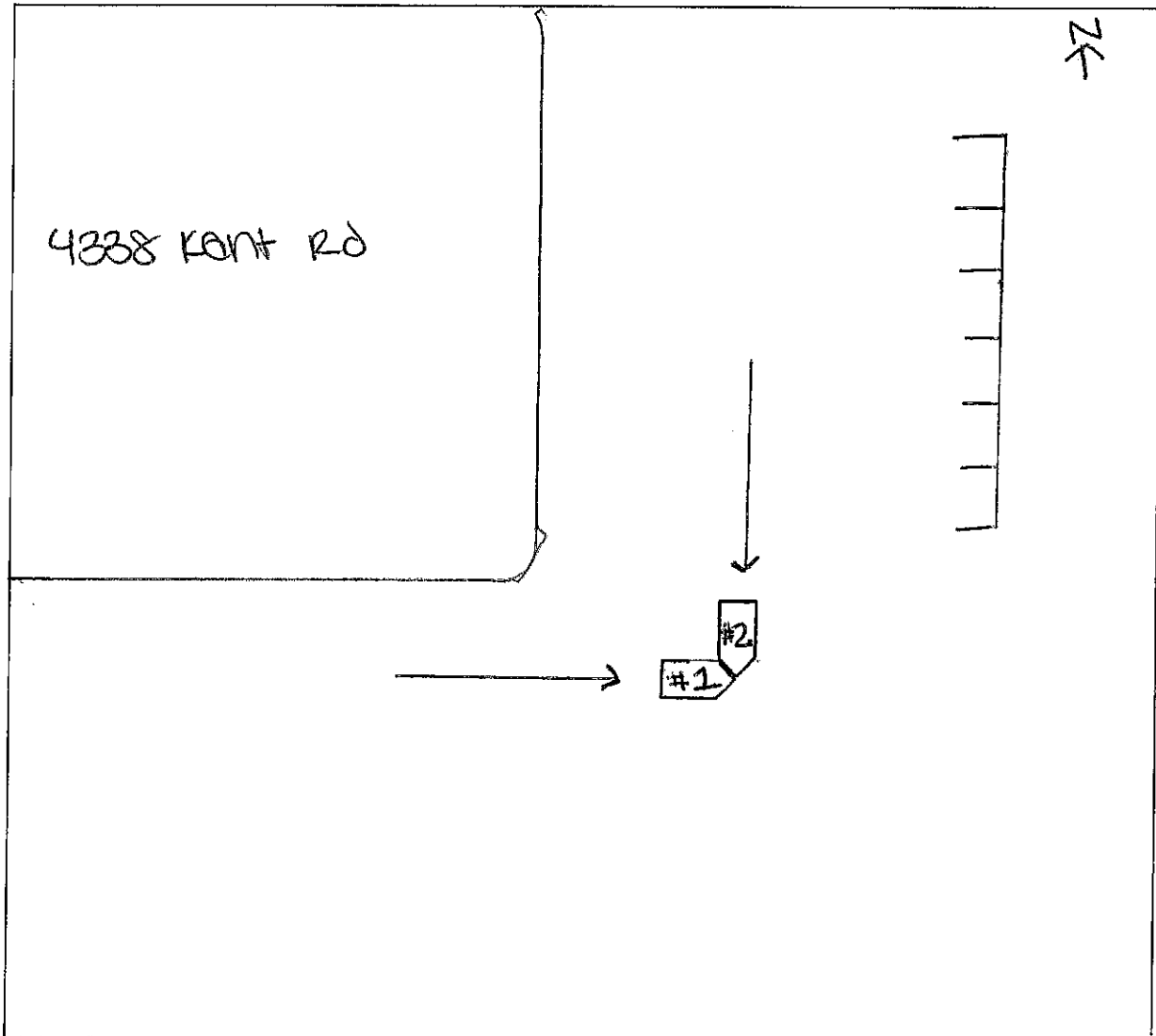

### WEATHER

- CLEAR
- RAIN
- SNOW
- FOG
- OTHER

### LIGHT

- DAYLIGHT
- DAWN
- DUSK
- DARK - LIGHTED ROAD
- DARK - NOT LIGHTED
- DARK - UNK LIGHTING
- UNKNOWN

### SURFACE

- DRY
- WET
- SNOW
- ICE
- OTHER

### ROAD

- CONCRETE
- BLACKTOP
- DIRT
- OTHER





|                                |                                 |                                    |
|--------------------------------|---------------------------------|------------------------------------|
| LOCAL REPORT NUMBER<br>22-3896 | REPORTING AGENCY<br>Stow Police | DATE OF CRASH<br>M 3   D 20   Y 22 |
|--------------------------------|---------------------------------|------------------------------------|

FOR LOCAL USE ONLY -- DO NOT SUBMIT TO THE STATE EXCEPT FOR FATAL CRASHES

I, Tara Amnesboro PRINTED HEREBY MAKE THIS VOLUNTARY STATEMENT TO  
Sfc. Wika #761 OFFICER'S NAME AT Stow, Ohio (Panera parking lot) LOCATION

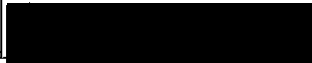
As I was pulling out of the panera/chipotle parking lot I looked ~~right~~ <sup>Right</sup> and did not see a car. Then I looked left a car that was going straight looked as if it was turning. It ended up going straight and I started to pull out. As I pulled out there was a car to my right and we hit front ends.

|  |   |
|--|---|
| ADDRESS OF WITNESS<br><u>588 Meadow Glen Ln, Tallmadge, OH 44278</u>   |  |
| SIGNATURE OF WITNESS<br>X  | OFFICER'S SIGNATURE<br>X <u>Sfc. Samantha Wills</u>                                   |

|                                       |  |  |
|---------------------------------------|--|--|
| LOCAL REPORT NUMBER<br><b>22-3896</b> | REPORTING AGENCY<br><b>Stow Police</b> | DATE OF CRASH<br>M <b>03</b> D <b>20</b> Y <b>22</b> |
|---------------------------------------|--|--|

**FOR LOCAL USE ONLY - DO NOT SUBMIT TO THE STATE EXCEPT FOR FATAL CRASHES**

I, LAVETTA Winland HEREBY MAKE THIS VOLUNTARY STATEMENT TO  
PRINTED

Ofc. WILK #761 AT 4338 KANT RD Stow, OH 44224  
OFFICER'S NAME LOCATION

I WAS DRIVING down The Road behind panera Bread and  
 Chipotle and A woman driving A BLACK NISSAN Rogue  
 CAME OUT OF Chipotle and hit into me on DRIVERS  
 side.

|  |  |
|--|--|
| ADDRESS OF WITNESS<br><b>5141 Newton Falls Rd Lot 58 Ravenna, Ohio 44266</b> | PHONE<br>[REDACTED]                              |
| SIGNATURE OF WITNESS<br>X <i>Lavetta Winland</i>                             | OFFICER'S SIGNATURE<br>X Ofc. Samantha Wilk #761 |

|                                |                                 |                                     |
|--------------------------------|---------------------------------|-------------------------------------|
| LOCAL REPORT NUMBER<br>22-3896 | REPORTING AGENCY<br>STOW POLICE | DATE OF CRASH<br>M 03   D 20   Y 22 |
|--------------------------------|---------------------------------|-------------------------------------|

**FOR LOCAL USE ONLY - DO NOT SUBMIT TO THE STATE EXCEPT FOR FATAL CRASHES**

I, Danielle Winland PRINTED HEREBY MAKE THIS VOLUNTARY STATEMENT TO  
ofc. Wilk #761 OFFICER'S NAME AT 4338 KANT RD, STOW, OH 44224 LOCATION

I was the passenger, but we were going down the road behind chipotle and a car came out of the chipotle plaza and hit us on the front drivers side.

|   |  |
|---|--|
| ADDRESS OF WITNESS<br>5141 newton falls rd lot 58 Ravenna, OH 44266 | PHONE<br>[REDACTED]                                    |
| SIGNATURE OF WITNESS<br>X <u>Danielle Winland</u>                   | OFFICER'S SIGNATURE<br>X OFC. <u>Jametha Wilk #761</u> |