



STOW POLICE DEPARTMENT
PRIVATE PROPERTY ACCIDENT REPORT/MINOR
TRAFFIC ACCIDENT REPORT

INCIDENT NUMBER **22-03412**
DATE **03/11/22** TIME **1603**

Private Property Private Property - Hit/Skip Minor Traffic Accident

LOCATION - ADDRESS
4300 Kent Rd.

VEHICLE #1

DRIVER #1 - NAME (Last, First, Middle) **KANE, CHRISTINE L.**
ADDRESS **885 STONEWATER DR.** CITY **KENT** STATE **OH** ZIP **44224**
SSN [REDACTED] DATE OF BIRTH **01/15/47** DF [REDACTED] STATE **OH**
OWNER #1 - NAME (Last, First, Middle) SAME AS DRIVER #1 PHONE [REDACTED]
ADDRESS [REDACTED] CITY [REDACTED] STATE [REDACTED] ZIP [REDACTED]
SSN [REDACTED] DATE OF BIRTH [REDACTED] DRIVER'S LICENSE NUMBER [REDACTED] STATE [REDACTED]
VEHICLE LICENSE # **DWS-4486** STATE **OH** YEAR **2014** MAKE **TOYOTA** MODEL **CAMRY** COLOR **BLUE**
INSURANCE COMPANY **CINCINNATI INS.** POLICY NUMBER **A010143667**

PARTS OF VEHICLE DAMAGED **REAR DRIVER SIDE BUMPER** CONTRIBUTING CIRCUMSTANCES **IMPROPER BACKING**

VEHICLE #2

DRIVER #2 - NAME (Last, First, Middle) **WUNDERLE, TAMMIE SUE**
ADDRESS **873 GREENBERLING DR.** CITY **KENT** STATE **OH** ZIP **44240**
SSN [REDACTED] DATE OF BIRTH **12/12/57** DRIVER'S LICENSE NUMBER [REDACTED] STATE **OH**
OWNER #2 - NAME (Last, First, Middle) SAME AS DRIVER #2 PHONE [REDACTED]
ADDRESS **WUNDERLE, CARL V.** CITY [REDACTED] STATE [REDACTED] ZIP [REDACTED]
SSN [REDACTED] DATE OF BIRTH **8/21/57** DRIVER'S LICENSE NUMBER [REDACTED] STATE **OH**
VEHICLE LICENSE # **FYN 7371** STATE **OH** YEAR **2013** MAKE **TOYOTA** MODEL **PRIUS** COLOR **LT. BLUE**
INSURANCE COMPANY **BRODEY INS. CO** POLICY NUMBER **APV 1591593 12**

PARTS OF VEHICLE DAMAGED **REAR DRIVER SIDE BUMPER** CONTRIBUTING CIRCUMSTANCES **NONE**

DESCRIBE WHAT HAPPENED
UNIT #2 WAS STOPPED AT THE END OF THE AISLE OF ONE OF THE PARKING AISLES AT GIANT EAGLE. UNIT #1 STARTED BACKING OUT OF A PARKING SPACE. UNIT #1 BACKED INTO UNIT #2.

See Reverse Side for Diagram

SUBMITTED BY: **Lt. S.W. Mills 705** DATE **03/11/22**
APPROVING OFFICER: **Lt. S.W. Mills 705** DATE **03/11/22**

STOW POLICE DEPARTMENT

FIELD SKETCH (not drawn to scale)

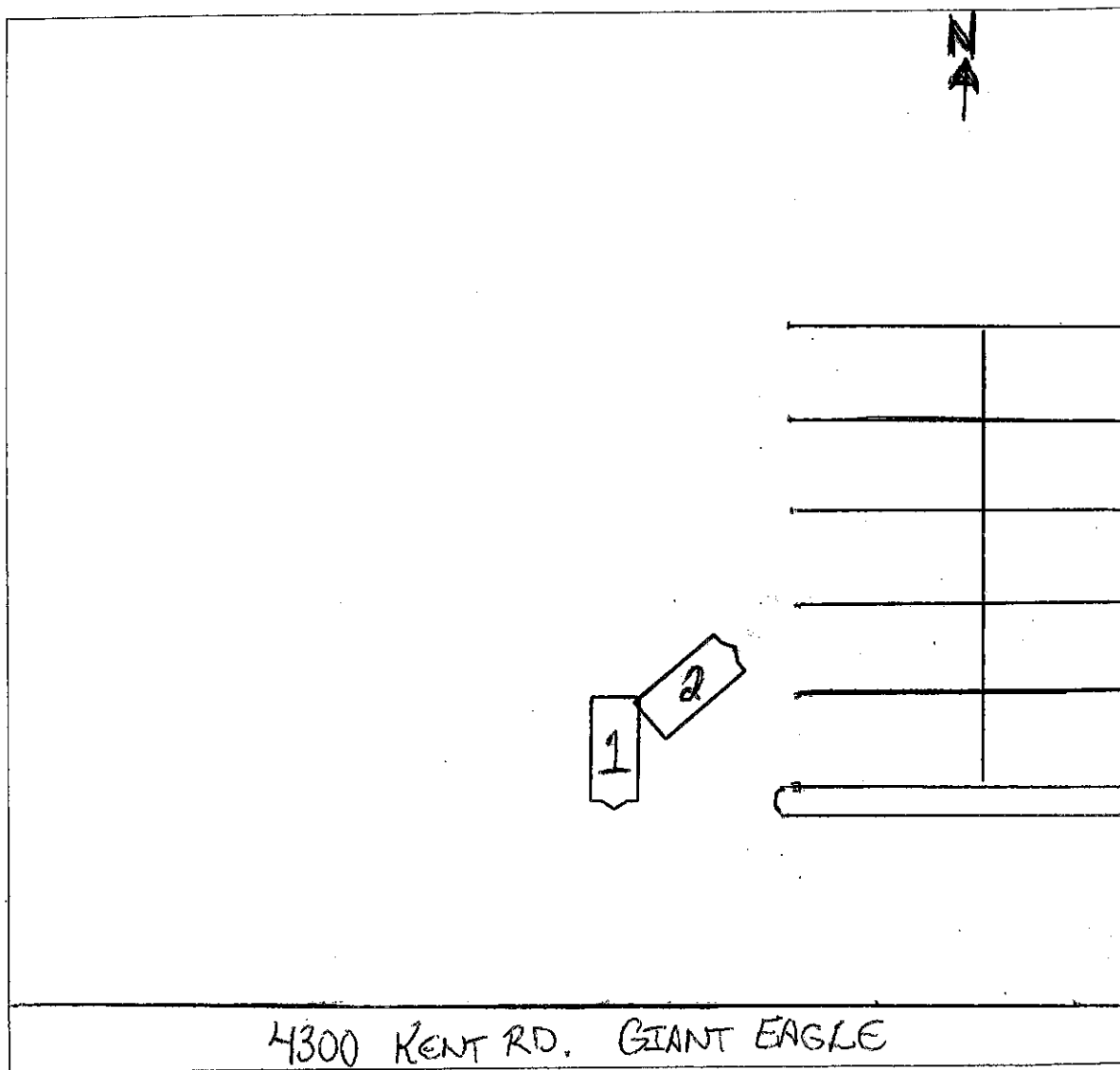

WEATHER

- CLEAR
- RAIN
- SNOW
- FOG
- OTHER

LIGHT

- DAYLIGHT
- DAWN
- DUSK
- DARK - LIGHTED ROAD
- DARK - NOT LIGHTED
- DARK - UNK LIGHTING
- UNKNOWN

SURFACE

- DRY
- WET
- SNOW
- ICE
- OTHER

ROAD

- CONCRETE
- BLACKTOP
- DIRT
- OTHER