



STOW POLICE DEPARTMENT

PRIVATE PROPERTY ACCIDENT REPORT/MINOR TRAFFIC ACCIDENT REPORT

INCIDENT NUMBER
22-15923DATE
10-8-22TIME
1251 Private Property Private Property - Hit/Skip Minor Traffic AccidentLOCATION - ADDRESS
Fishcreek Rd. at 3804 Fishcreek Rd.

VEHICLE #1

DRIVER #1 - NAME (Last, First, Middle) *Saxton, Lori K.* PHONE [REDACTED]

ADDRESS *1061 Verona Dr.* CITY *Kent* STATE *OH* ZIP *44240*

SSN [REDACTED] DATE OF BIRTH *6-6-22* DRIVER'S LICENSE NUMBER [REDACTED] STATE *OH*

OWNER #1 - NAME (Last, First, Middle) SAME AS DRIVER #1 PHONE

ADDRESS CITY STATE ZIP

SSN DATE OF BIRTH DRIVER'S LICENSE NUMBER STATE

VEHICLE LICENSE# *JN07168* STATE *OH* YEAR *2019* MAKE *Bmw* MODEL *X4* COLOR *Red*

INSURANCE COMPANY *Progressive* POLICY NUMBER *4084093*

PARTS OF VEHICLE DAMAGED *Rear hatch* CONTRIBUTING CIRCUMSTANCES *None*

VEHICLE #2

DRIVER #2 - NAME (Last, First, Middle) *Feldman, Cooper James* PHONE [REDACTED]

ADDRESS *7628 Seasons Rd.* CITY *Kent* STATE *OH* ZIP *44240*

SSN [REDACTED] DATE OF BIRTH *10-8-05* DRIVER'S LICENSE NUMBER [REDACTED] STATE *OH*

OWNER #2 - NAME (Last, First, Middle) SAME AS DRIVER #2 PHONE *Feldman, Chad William*

ADDRESS *Same* CITY STATE ZIP

SSN [REDACTED] DATE OF BIRTH *12-7-71* DRIVER'S LICENSE NUMBER [REDACTED] STATE *OH*

VEHICLE LICENSE# *JM37854* STATE *OH* YEAR *2020* MAKE *Jeep* MODEL *Cherokee* COLOR *Black*

INSURANCE COMPANY *State Farm* POLICY NUMBER *D322147-C13-35*

PARTS OF VEHICLE DAMAGED *Front bumper* CONTRIBUTING CIRCUMSTANCES *ACDA*

DESCRIBE WHAT HAPPENED
Unit #1 was stopped on Fishcreek Rd. in the right lane facing south at the red light for the access road to A/D: 3804 Fishcreek Rd. Unit #2 was southbound behind Unit #1 and did not stop in time, striking Unit #1 as a result. Unit #2 sustained nearly no visible damage and Unit #1's rear hatch was dented.

See Reverse Side for Diagram

SUBMITTED BY: *Murphy #1738* DATE *10-8-22*APPROVING OFFICER: *[Signature]* DATE *10-8-22*

STOW POLICE DEPARTMENT

FIELD SKETCH (not drawn to scale)

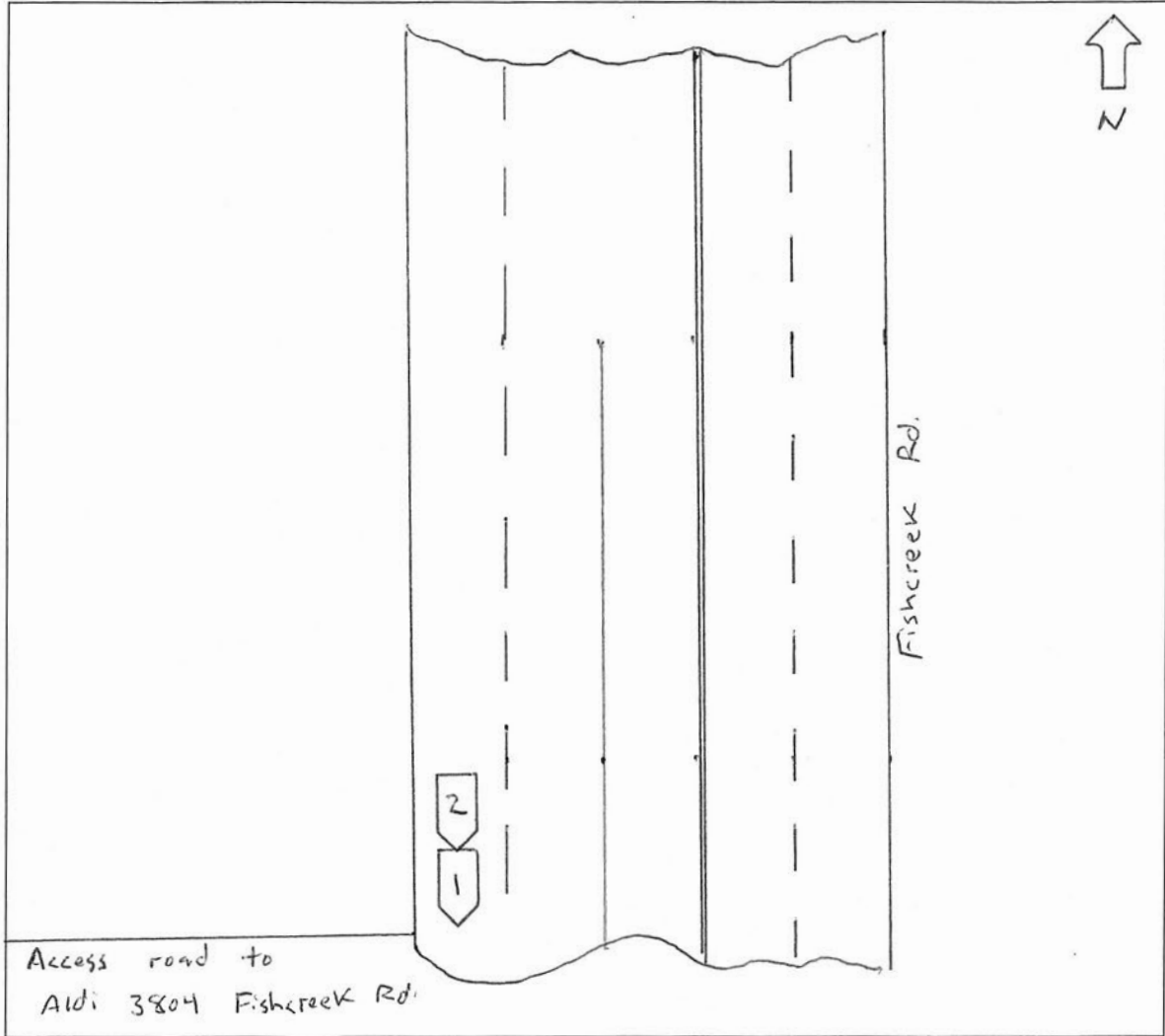

WEATHER

- CLEAR
- RAIN
- SNOW
- FOG
- OTHER

LIGHT

- DAYLIGHT
- DAWN
- DUSK
- DARK - LIGHTED ROAD
- DARK - NOT LIGHTED
- DARK - UNK LIGHTING
- UNKNOWN

SURFACE

- DRY
- WET
- SNOW
- ICE
- OTHER

ROAD

- CONCRETE
- BLACKTOP
- DIRT
- OTHER