



# STOW POLICE DEPARTMENT

PRIVATE PROPERTY ACCIDENT REPORT/MINOR  
TRAFFIC ACCIDENT REPORT

INCIDENT NUMBER  
22-16356

DATE  
10/15/22

TIME  
1605

Private Property    Private Property - Hit/Skip    Minor Traffic Accident

LOCATION - ADDRESS

4097 Bridgewater Parkway

DRIVER #1 - NAME (Last, First, Middle)

Ball, Joshua, Anthony

PHONE

[REDACTED]

ADDRESS

7077 Oakwood Road

CITY

Parma Heights

STATE

OH

ZIP

44130

SSN

[REDACTED]

DATE OF BIRTH

09/20/1990

DRIVER'S LICENSE NUMBER

[REDACTED]

STATE

OH

VEHICLE #1

OWNER #1 - NAME (Last, First, Middle)

Business: Sysco

SAME AS DRIVER #1

PHONE

[REDACTED]

ADDRESS

4747 Grayton Road

CITY

Cleveland

STATE

OH

ZIP

44135

SSN

[REDACTED]

DATE OF BIRTH

[REDACTED]

DRIVER'S LICENSE NUMBER

[REDACTED]

STATE

[REDACTED]

VEHICLE LICENSE#

3Z8 3594

STATE

IN

YEAR

[REDACTED]

MAKE

International

MODEL

RH

COLOR

White

INSURANCE COMPANY

Ohio Insurance

POLICY NUMBER

BAP 234 72 04 13

PARTS OF VEHICLE DAMAGED

Top of trailer. Trailer # 244081 RP: PR24827/IN

CONTRIBUTING CIRCUMSTANCES

Indiscernible

DRIVER #2 - NAME (Last, First, Middle)

Business

PHONE

[REDACTED]

ADDRESS

[REDACTED]

CITY

[REDACTED]

STATE

[REDACTED]

ZIP

[REDACTED]

SSN

[REDACTED]

DATE OF BIRTH

[REDACTED]

DRIVER'S LICENSE NUMBER

[REDACTED]

STATE

[REDACTED]

VEHICLE #2

OWNER #2 - NAME (Last, First, Middle)

Home 2 Suites

SAME AS DRIVER #2

PHONE

[REDACTED]

ADDRESS

4097 Bridgewater Pkwy

CITY

Stow

STATE

OH

ZIP

44224

SSN

[REDACTED]

DATE OF BIRTH

[REDACTED]

DRIVER'S LICENSE NUMBER

[REDACTED]

STATE

[REDACTED]

VEHICLE LICENSE #

[REDACTED]

STATE

[REDACTED]

YEAR

[REDACTED]

MAKE

[REDACTED]

MODEL

[REDACTED]

COLOR

[REDACTED]

INSURANCE COMPANY

[REDACTED]

POLICY NUMBER

[REDACTED]

PARTS OF VEHICLE DAMAGED

[REDACTED]

CONTRIBUTING CIRCUMSTANCES

[REDACTED]

DESCRIBE WHAT HAPPENED

Unit 1 pulled into Home 2 Suites to make a delivery. Unit 1 pulled under an overhang outside Home 2 Suites. The overhang was labeled 13'0" clearance. Unit 1 had labels on the trailer marked 13'0". Unit 1 struck the overhang while attempting to pull under the overhang.

See Reverse Side for Diagram

SUBMITTED BY:

Ofc. Demars 759

DATE

10/15/22

APPROVING OFFICER:

Gintler, 719

DATE

10-15-22

# STOW POLICE DEPARTMENT

FIELD SKETCH (not drawn to scale)

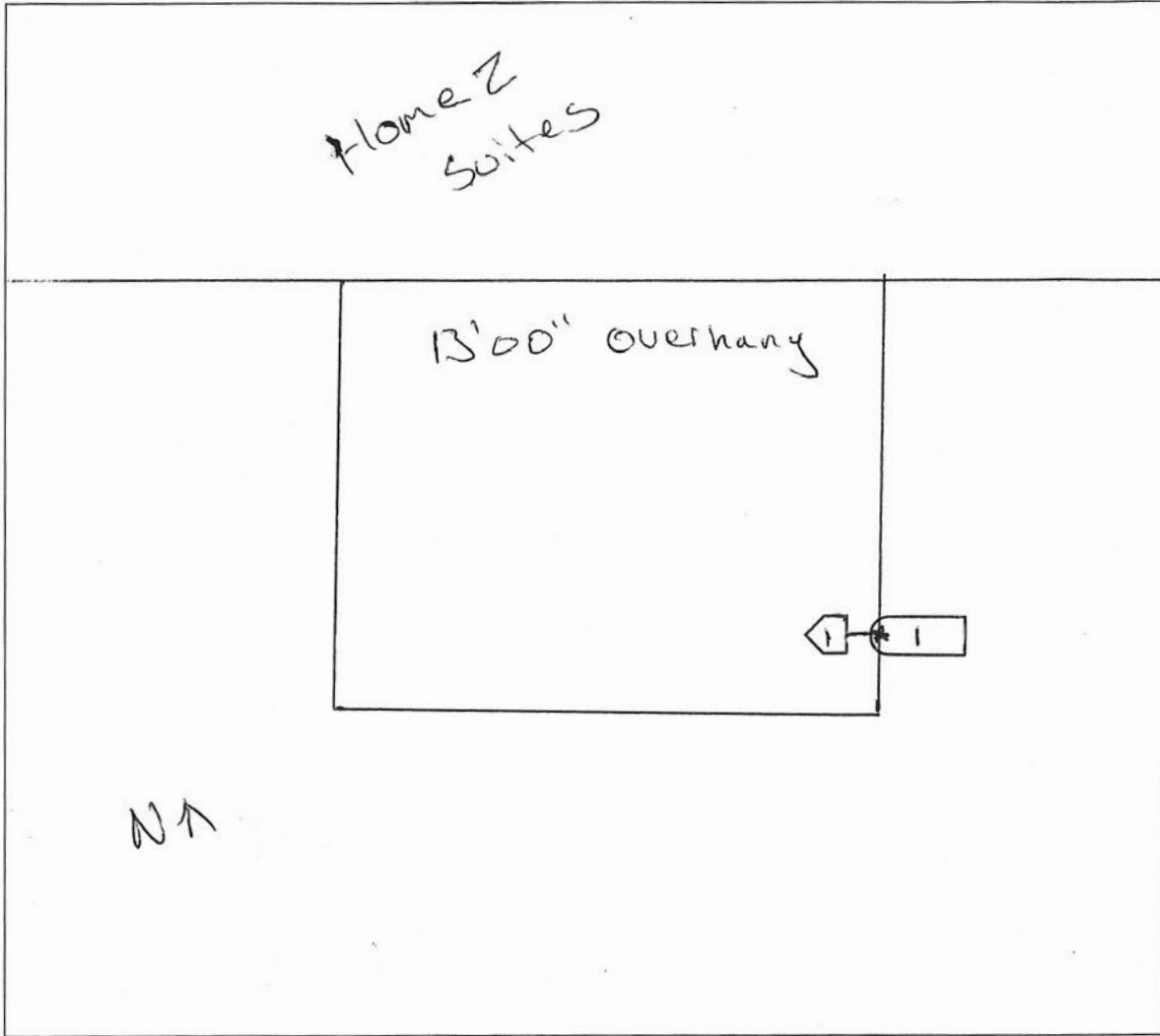

## WEATHER

- CLEAR
- RAIN
- SNOW
- FOG
- OTHER

## LIGHT

- DAYLIGHT
- DAWN
- DUSK
- DARK - LIGHTED ROAD
- DARK - NOT LIGHTED
- DARK - UNK LIGHTING
- UNKNOWN

## SURFACE

- DRY
- WET
- SNOW
- ICE
- OTHER

## ROAD

- CONCRETE
- BLACKTOP
- DIRT
- OTHER