



STOW POLICE DEPARTMENT

PRIVATE PROPERTY ACCIDENT REPORT/MINOR
TRAFFIC ACCIDENT REPORT

INCIDENT NUMBER
22-14531

DATE
09/16/22

TIME
1323

Private Property Private Property - Hit/Skip Minor Traffic Accident

LOCATION - ADDRESS
1555 MAC DRIVE

VEHICLE #1

DRIVER #1 - NAME (Last, First, Middle) **DELSIGNORE, ROBERT A.**

ADDRESS **6782 HARRISON AVE APT. 89** CITY **CINCINNATI** STATE **OH** ZIP **45247**

SSN [REDACTED] DATE OF BIRTH **01/07/70** DRIVER'S LICENSE NUMBER [REDACTED] STATE **OH**

OWNER #1 - NAME (Last, First, Middle) SAME AS DRIVER #1 **DELSIGNORE, DUSTIN PORTER**

ADDRESS **3219 E SOUTH RANGE RD.** CITY **NEW SPRINGFIELD** STATE **OH** ZIP **44443**

SSN [REDACTED] DATE OF BIRTH **04/10/96** DRIVER'S LICENSE NUMBER [REDACTED] STATE **OH**

VEHICLE LICENSE # **JUY 4597** STATE **OH** YEAR **2007** MAKE **DODGE** MODEL **RAM 1500** COLOR **BLACK**

INSURANCE COMPANY **FOUNDERS** POLICY NUMBER **ITO H 282320**

PARTS OF VEHICLE DAMAGED **FRONT DRIVER SIDE BUMPER** CONTRIBUTING CIRCUMSTANCES **FAIL TO CONTROL**

VEHICLE #2

DRIVER #2 - NAME (Last, First, Middle) **N/A.** PHONE [REDACTED]

ADDRESS [REDACTED] CITY [REDACTED] STATE [REDACTED] ZIP [REDACTED]

SSN [REDACTED] DATE OF BIRTH [REDACTED] DRIVER'S LICENSE NUMBER [REDACTED] STATE [REDACTED]

OWNER #2 - NAME (Last, First, Middle) SAME AS DRIVER #2 **CHILDERS, CONSWELLA M.**

ADDRESS **1555 MAC DR. APT. 12** CITY **Stow** STATE **OH** ZIP **44224**

SSN [REDACTED] DATE OF BIRTH **12/17/1970** DRIVER'S LICENSE NUMBER [REDACTED] STATE **OH**

VEHICLE LICENSE # **JKJ-2418** STATE **OH** YEAR **2022** MAKE **GMC** MODEL **TERRAIN** COLOR **GREY**

INSURANCE COMPANY **STATED NO VEHICLE INS.** POLICY NUMBER [REDACTED]

PARTS OF VEHICLE DAMAGED **BOTH DRIVER SIDE DOORS** CONTRIBUTING CIRCUMSTANCES **NONE**

DESCRIBE WHAT HAPPENED
UNIT # 2 WAS PARKED IN THE PARKING LOT OF THE ADDRESS. UNIT # 1 WAS TURNING INTO A PARKING SPACE AND STRUCK UNIT # 2.

See Reverse Side for Diagram

SUBMITTED BY: **Lt. S.W. Miller 705** DATE **09/19/22**

APPROVING OFFICER: **Lt. S.W. Miller 705** DATE **09/19/22**

STOW POLICE DEPARTMENT

FIELD SKETCH (not drawn to scale)

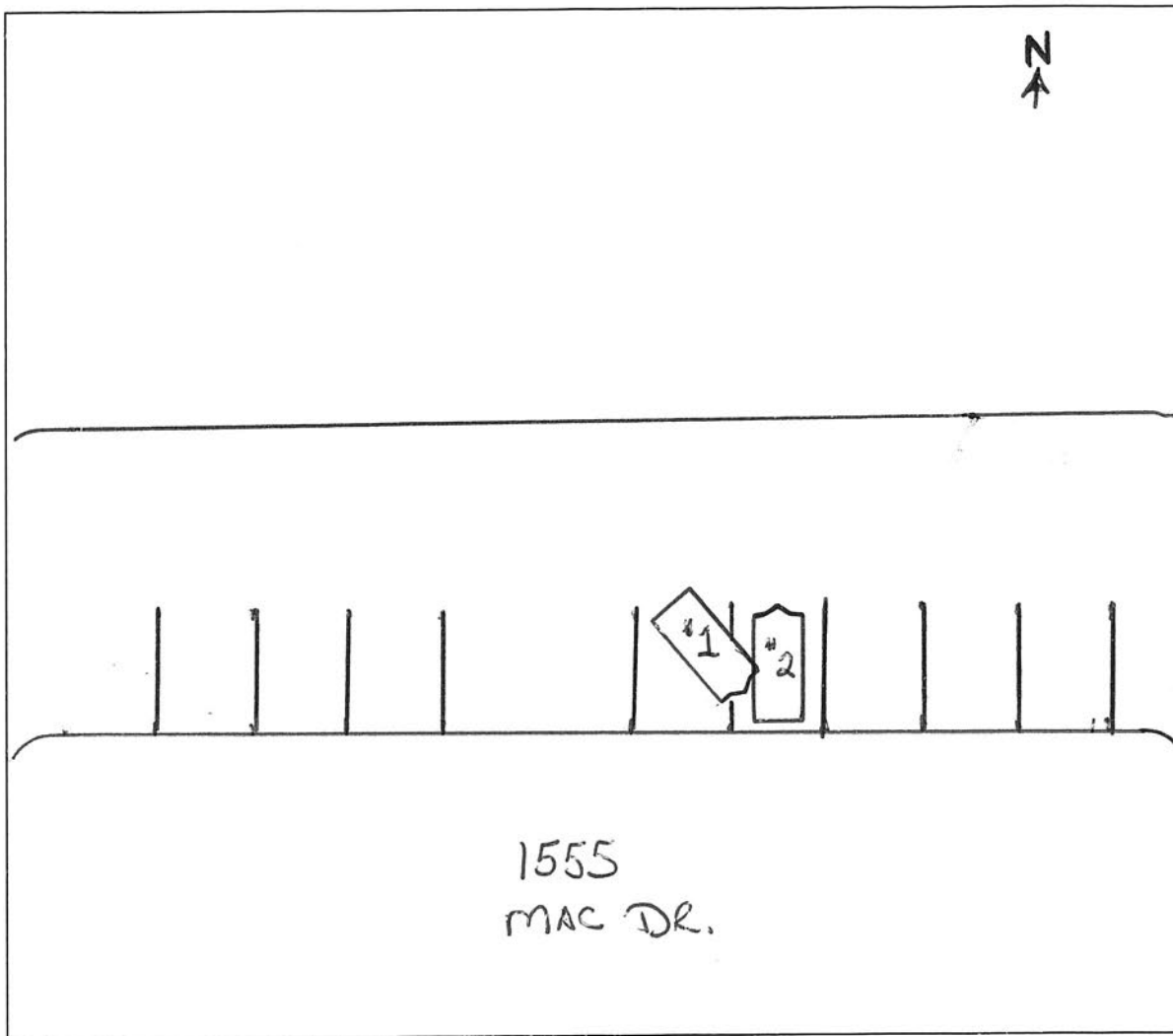

WEATHER

- CLEAR
- RAIN
- SNOW
- FOG
- OTHER

LIGHT

- DAYLIGHT
- DAWN
- DUSK
- DARK – LIGHTED ROAD
- DARK – NOT LIGHTED
- DARK – UNK LIGHTING
- UNKNOWN

SURFACE

- DRY
- WET
- SNOW
- ICE
- OTHER

ROAD

- CONCRETE
- BLACKTOP
- DIRT
- OTHER