



STOW POLICE DEPARTMENT

PRIVATE PROPERTY ACCIDENT REPORT/MINOR
TRAFFIC ACCIDENT REPORT

INCIDENT NUMBER

22-14393

DATE

9/14/22

TIME

1048

Private Property Private Property - Hit/Skip Minor Traffic Accident

LOCATION - ADDRESS

3027 Graham Rd. Stow, OH, 44224 (Dunkin)

DRIVER #1 - NAME (Last, First, Middle)

Parked/unoccupied

PHONE

ADDRESS

CITY

STATE

ZIP

SSN

DATE OF BIRTH

DRIVER'S LICENSE NUMBER

STATE

VEHICLE #1

OWNER #1 - NAME (Last, First, Middle)

SAME AS DRIVER #1

PHONE

West, Brent, E.

ADDRESS

CITY

STATE

ZIP

3003 Ravineview Cir.

Stow

OH

44224

SSN

DATE OF BIRTH

DRIVER'S LICENSE NUMBER

STATE

11-28-07

VEHICLE LICENSE#

STATE

YEAR

MAKE

MODEL

COLOR

HTJ151Z

OH

2010

Lincoln

MKZ

Gray

INSURANCE COMPANY

POLICY NUMBER

Liberty Mutual

AOV-281-519-674-70-09

PARTS OF VEHICLE DAMAGED

rear pass. side door & rear bumper

CONTRIBUTING CIRCUMSTANCES

none

DRIVER #2 - NAME (Last, First, Middle)

Bracamonte, Angie, Marie

PHONE

ADDRESS

CITY

STATE

ZIP

3433 Verner Rd.

Stow

OH

44240

SSN

DATE OF BIRTH

DRIVER'S LICENSE NUMBER

STATE

10/31/03

VEHICLE #2

OWNER #2 - NAME (Last, First, Middle)

SAME AS DRIVER #2

PHONE

Bracamonte, Leonardo

ADDRESS

CITY

STATE

ZIP

3433 Verner Rd

Stow

OH

44240

SSN

DATE OF BIRTH

DRIVER'S LICENSE NUMBER

STATE

4-17-83

VEHICLE LICENSE #

STATE

YEAR

MAKE

MODEL

COLOR

HLT9702

OH

Nissan

Titan

Black

INSURANCE COMPANY

POLICY NUMBER

Allstate

992962638

PARTS OF VEHICLE DAMAGED

Rear tailgate

CONTRIBUTING CIRCUMSTANCES

Rules for Backing

DESCRIBE WHAT HAPPENED

Vehicle #1 was parked, unoccupied at 3027 Graham Rd. Vehicle #2 was backing into a parking spot next to vehicle #1 but backed too close, colliding with the parked vehicle.

See Reverse Side for Diagram

SUBMITTED BY:

Ofc. B. Childers #746

DATE

9/14/22

APPROVING OFFICER:

[Signature]

DATE

9/14/22

STOW POLICE DEPARTMENT

FIELD SKETCH (not drawn to scale)

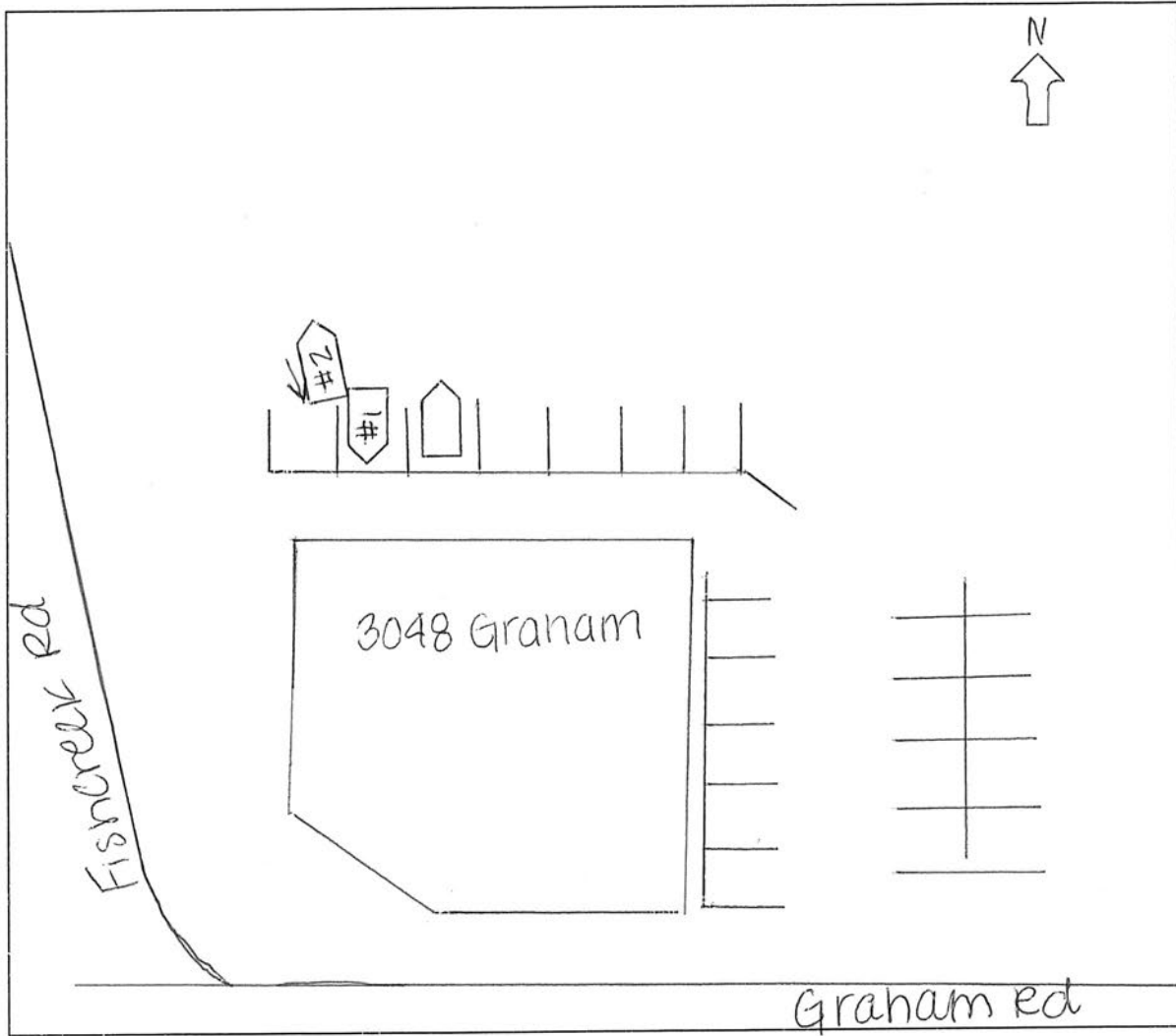

WEATHER

- CLEAR
- RAIN
- SNOW
- FOG
- OTHER

LIGHT

- DAYLIGHT
- DAWN
- DUSK
- DARK - LIGHTED ROAD
- DARK - NOT LIGHTED
- DARK - UNK LIGHTING
- UNKNOWN

SURFACE

- DRY
- WET
- SNOW
- ICE
- OTHER

ROAD

- CONCRETE
- BLACKTOP
- DIRT
- OTHER