



STOW POLICE DEPARTMENT

PRIVATE PROPERTY ACCIDENT REPORT/MINOR
TRAFFIC ACCIDENT REPORT

INCIDENT NUMBER
22-13838

DATE
09/04/22

TIME
0809

Private Property Private Property - Hit/Skip Minor Traffic Accident

LOCATION - ADDRESS
3428 Darrow Rd, Stow, OH, 44224

VEHICLE #1

DRIVER #1 - NAME (Last, First, Middle) _____ PHONE _____

ADDRESS _____ CITY _____ STATE _____ ZIP _____

SSN _____ DATE OF BIRTH _____ DRIVER'S LICENSE NUMBER _____ STATE _____

OWNER #1 - NAME (Last, First, Middle) SAME AS DRIVER #1 _____ PHONE _____

White, Adalin, Marie

ADDRESS _____ CITY _____ STATE _____ ZIP _____

2842 Bailey RD _____ Cuyahoga Falls _____ OH _____ 44221

SSN _____ DATE OF BIRTH _____ DRIVER'S LICENSE NUMBER _____ STATE _____

02/11/1986 _____ OH

VEHICLE LICENSE# _____ STATE _____ YEAR _____ MAKE _____ MODEL _____ COLOR _____

JF3431 _____ OH _____ 2017 _____ Subaru _____ Legacy _____ Red

INSURANCE COMPANY _____ POLICY NUMBER _____

Geico _____ 6007359810

PARTS OF VEHICLE DAMAGED _____ CONTRIBUTING CIRCUMSTANCES _____

Rear driver side door, rear driver side wheel, rear driver side quarter panel _____ None

VEHICLE #2

DRIVER #2 - NAME (Last, First, Middle) _____ PHONE _____

Ryan, Christine, Marie

ADDRESS _____ CITY _____ STATE _____ ZIP _____

290 Hunter Ave _____ Monroe Falls _____ OH _____ 44262

SSN _____ DATE OF BIRTH _____ DRIVER'S LICENSE NUMBER _____ STATE _____

04/12/1954 _____ OH

OWNER #2 - NAME (Last, First, Middle) SAME AS DRIVER #2 _____ PHONE _____

ADDRESS _____ CITY _____ STATE _____ ZIP _____

SSN _____ DATE OF BIRTH _____ DRIVER'S LICENSE NUMBER _____ STATE _____

VEHICLE LICENSE # _____ STATE _____ YEAR _____ MAKE _____ MODEL _____ COLOR _____

EDK9595 _____ OH _____ 2007 _____ Saturn _____ Aura _____ Silver

INSURANCE COMPANY _____ POLICY NUMBER _____

Allstate _____ 026525231

PARTS OF VEHICLE DAMAGED _____ CONTRIBUTING CIRCUMSTANCES _____

Passenger side front bumper _____ Failure to control

DESCRIBE WHAT HAPPENED

Unit #1 was parked and unoccupied in the Flip Top parking lot. Unit #2 attempted to turn left into the parking spot next to Unit #1, striking unit #1 when attempting the turn.

unit #2 reported the accident on 09/04/2022. The accident occurred on 09/03/2022 between 1200 and 1245. The accident was viewed on surveillance camera and the driver of unit #2 admitted to the accident.

See Reverse Side for Diagram

SUBMITTED BY: OFc. Kidd 766 DATE 09/04/2022

APPROVING OFFICER: Sgt. Sun 705 DATE 9/4/22

STOW POLICE DEPARTMENT

FIELD SKETCH (not drawn to scale)

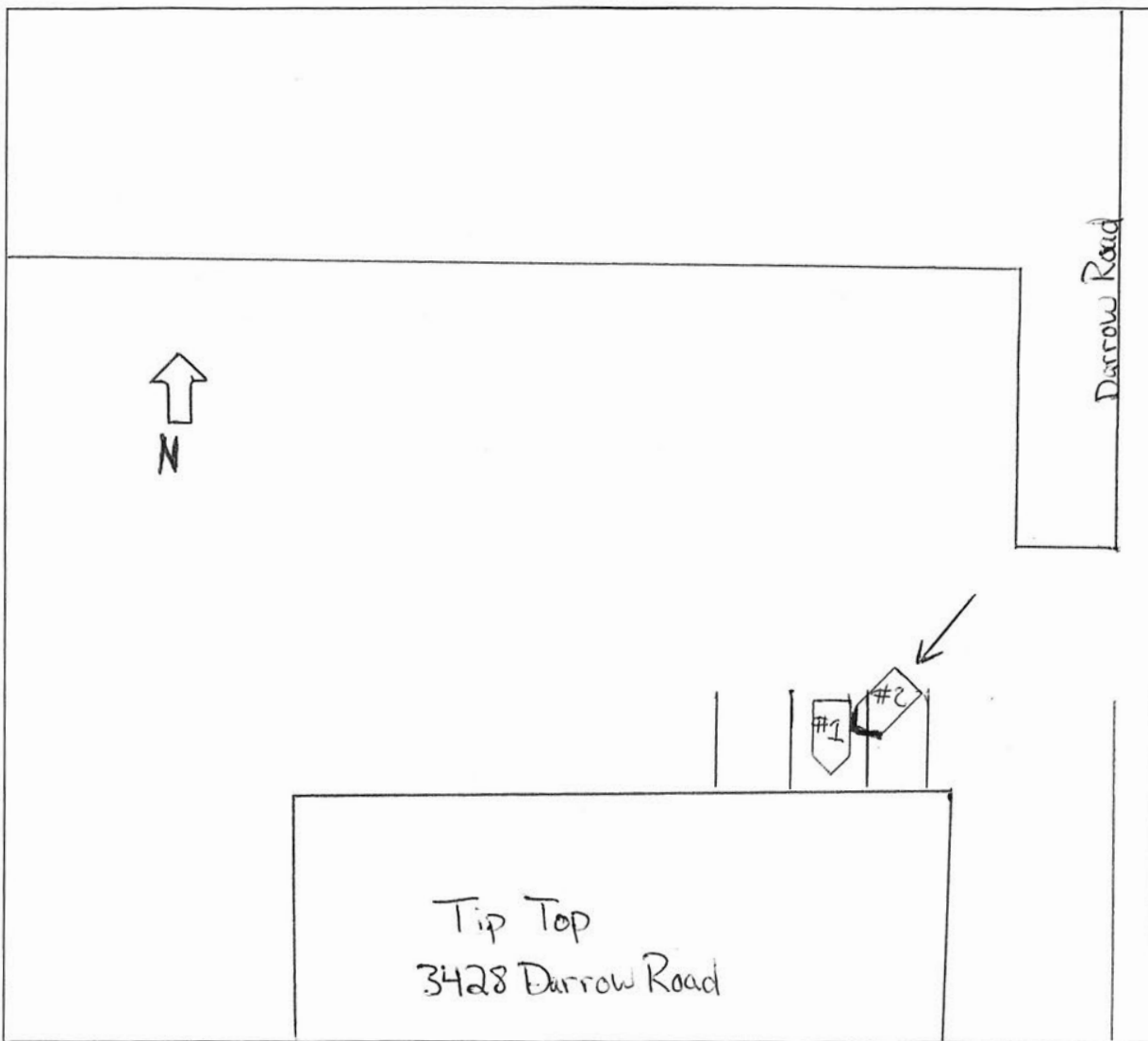

WEATHER

- CLEAR
- RAIN
- SNOW
- FOG
- OTHER

LIGHT

- DAYLIGHT
- DAWN
- DUSK
- DARK - LIGHTED ROAD
- DARK - NOT LIGHTED
- DARK - UNK LIGHTING
- UNKNOWN

SURFACE

- DRY
- WET
- SNOW
- ICE
- OTHER

ROAD

- CONCRETE
- BLACKTOP
- DIRT
- OTHER