



STOW POLICE DEPARTMENT

PRIVATE PROPERTY ACCIDENT REPORT/MINOR
TRAFFIC ACCIDENT REPORT

INCIDENT NUMBER
22-02603

DATE
2/24/22

TIME
1334

Private Property Private Property - Hit/Skip Minor Traffic Accident

LOCATION - ADDRESS
3520 Hudson Dr Stow, OH 44224

VEHICLE #1

DRIVER #1 - NAME (Last, First, Middle) **Ash, Brandon, S** PHONE [REDACTED]

ADDRESS **2804 Fairview Pl** CITY **Cuyahoga Falls** STATE **OH** ZIP **44221**

SSN [REDACTED] DATE OF BIRTH **6/17/92** DRIVER'S LICENSE NUMBER [REDACTED] STATE **OH**

OWNER #1 - NAME (Last, First, Middle) SAME AS DRIVER #1 PHONE [REDACTED]

ADDRESS [REDACTED] CITY [REDACTED] STATE [REDACTED] ZIP [REDACTED]

SSN [REDACTED] DATE OF BIRTH [REDACTED] DRIVER'S LICENSE NUMBER [REDACTED] STATE [REDACTED]

VEHICLE LICENSE# **HM 59942** STATE **OH** YEAR **2016** MAKE **Nissan** MODEL **Versa** COLOR **BLK**

INSURANCE COMPANY **Progressive** POLICY NUMBER **909291855**

PARTS OF VEHICLE DAMAGED **Passenger side front door** CONTRIBUTING CIRCUMSTANCES **None**

VEHICLE #2

DRIVER #2 - NAME (Last, First, Middle) **Basnet, Bal, B** PHONE [REDACTED]

ADDRESS **1465 Gurley Ave** CITY **Akron** STATE **OH** ZIP **44310**

SSN [REDACTED] DATE OF BIRTH **9/1/83** DRIVER'S LICENSE NUMBER [REDACTED] STATE **OH**

OWNER #2 - NAME (Last, First, Middle) SAME AS DRIVER #2 PHONE [REDACTED]

ADDRESS [REDACTED] CITY [REDACTED] STATE [REDACTED] ZIP [REDACTED]

SSN [REDACTED] DATE OF BIRTH [REDACTED] DRIVER'S LICENSE NUMBER [REDACTED] STATE [REDACTED]

VEHICLE LICENSE # **HBL 2870** STATE **OH** YEAR **2016** MAKE **Toyota** MODEL **Rav 4** COLOR **RED**

INSURANCE COMPANY **Nationwide** POLICY NUMBER **9234 J059084**

PARTS OF VEHICLE DAMAGED **Driver's side Rear bumper / rear fender** CONTRIBUTING CIRCUMSTANCES **Improper backing**

DESCRIBE WHAT HAPPENED
Veh#1 backed out of parking space and stopped to go forward. Veh#2 backed out of a perpendicular spot and struck the front passenger door of Veh#1. A witness observed Veh#1 back out of the parking spot first.

Witness: **Keith M Ciolek**
1126 Elna Ave
Kent, OH 44240

See Reverse Side for Diagram

SUBMITTED BY: **Ptl B HADDIX #736** DATE **2/24/22**

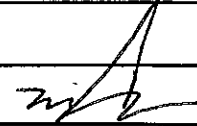
APPROVING OFFICER:  DATE **2-24-22**

STOW POLICE DEPARTMENT

FIELD SKETCH (not drawn to scale)

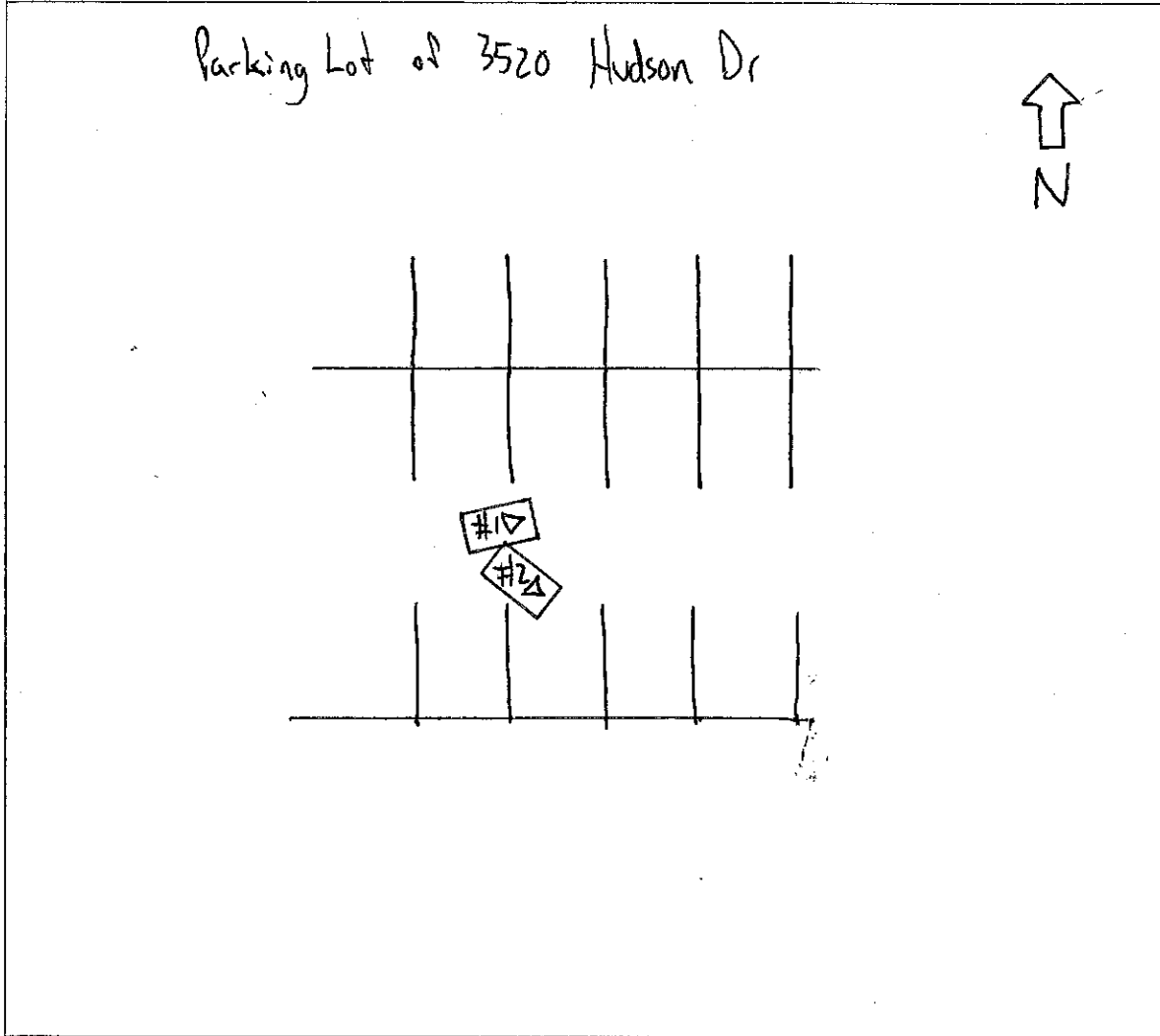

WEATHER

- CLEAR
- RAIN
- SNOW
- FOG
- OTHER

LIGHT

- DAYLIGHT
- DAWN
- DUSK
- DARK -- LIGHTED ROAD
- DARK -- NOT LIGHTED
- DARK -- UNK LIGHTING
- UNKNOWN

SURFACE

- DRY
- WET
- SNOW
- ICE
- OTHER

ROAD

- CONCRETE
- BLACKTOP
- DIRT
- OTHER