



STOW POLICE DEPARTMENT

PRIVATE PROPERTY ACCIDENT REPORT/MINOR
TRAFFIC ACCIDENT REPORT

INCIDENT NUMBER
22-017916

DATE
2.7.2022

TIME
1305

Private Property Private Property - Hit/Skip Minor Traffic Accident

LOCATION - ADDRESS
3227 Graham Road

DRIVER #1 - NAME (Last, First, Middle) Schmitt, Laney M
ADDRESS 1227 Arndale Road CITY Stow STATE OH ZIP 44224
SSN [REDACTED] DATE OF BIRTH 1.22.2004 DRIVER'S LICENSE NUMBER [REDACTED] STATE OH

VEHICLE #1
OWNER #1 - NAME (Last, First, Middle) SAME AS DRIVER #1 Schmitt, Timothy A
ADDRESS 2134 Bryn Mawr Drive CITY Stow STATE OH ZIP 44224
SSN [REDACTED] DATE OF BIRTH 4.24.1977 DRIVER'S LICENSE NUMBER [REDACTED] STATE OH
VEHICLE LICENSE # GUV 2576 STATE OH YEAR 2010 MAKE Honda MODEL CR-V COLOR Tan
INSURANCE COMPANY Progressive POLICY NUMBER 941207077

PARTS OF VEHICLE DAMAGED Front Passenger Side CONTRIBUTING CIRCUMSTANCES None

DRIVER #2 - NAME (Last, First, Middle) Whitaker, Amanda J.
ADDRESS 5157 Terra Lee Circle CITY Stow STATE OH ZIP 44224
SSN [REDACTED] DATE OF BIRTH 10.30.2003 DRIVER'S LICENSE NUMBER [REDACTED] STATE OH

VEHICLE #2
OWNER #2 - NAME (Last, First, Middle) SAME AS DRIVER #2 Whitaker, Alan C.
ADDRESS 5157 Terra Lee Circle CITY Stow STATE OH ZIP 44224
SSN [REDACTED] DATE OF BIRTH 2.17.1962 DRIVER'S LICENSE NUMBER [REDACTED] STATE OH
VEHICLE LICENSE # FGV 2130 STATE OH YEAR 2009 MAKE Hyundai MODEL Accent COLOR Blue
INSURANCE COMPANY STATE FARM POLICY NUMBER 051 4039-C21-3510

PARTS OF VEHICLE DAMAGED Rear AND Passenger side rear CONTRIBUTING CIRCUMSTANCES Backed out of parking space

DESCRIBE WHAT HAPPENED
Driver #1 was driving westbound through the parking lot of 3227 Graham Road (Stow-Munroe Falls High School). Driver #2 was parked in the parking lot of 3227 Graham Road. Driver #2 backed (south) out of a parking space. Driver #1 struck Driver #2 at an angle.

See Reverse Side for Diagram

SUBMITTED BY: A. Smith

DATE 2.7.2022

APPROVING OFFICER: J. Gintler

DATE 2-8-22

STOW POLICE DEPARTMENT

FIELD SKETCH (not drawn to scale)

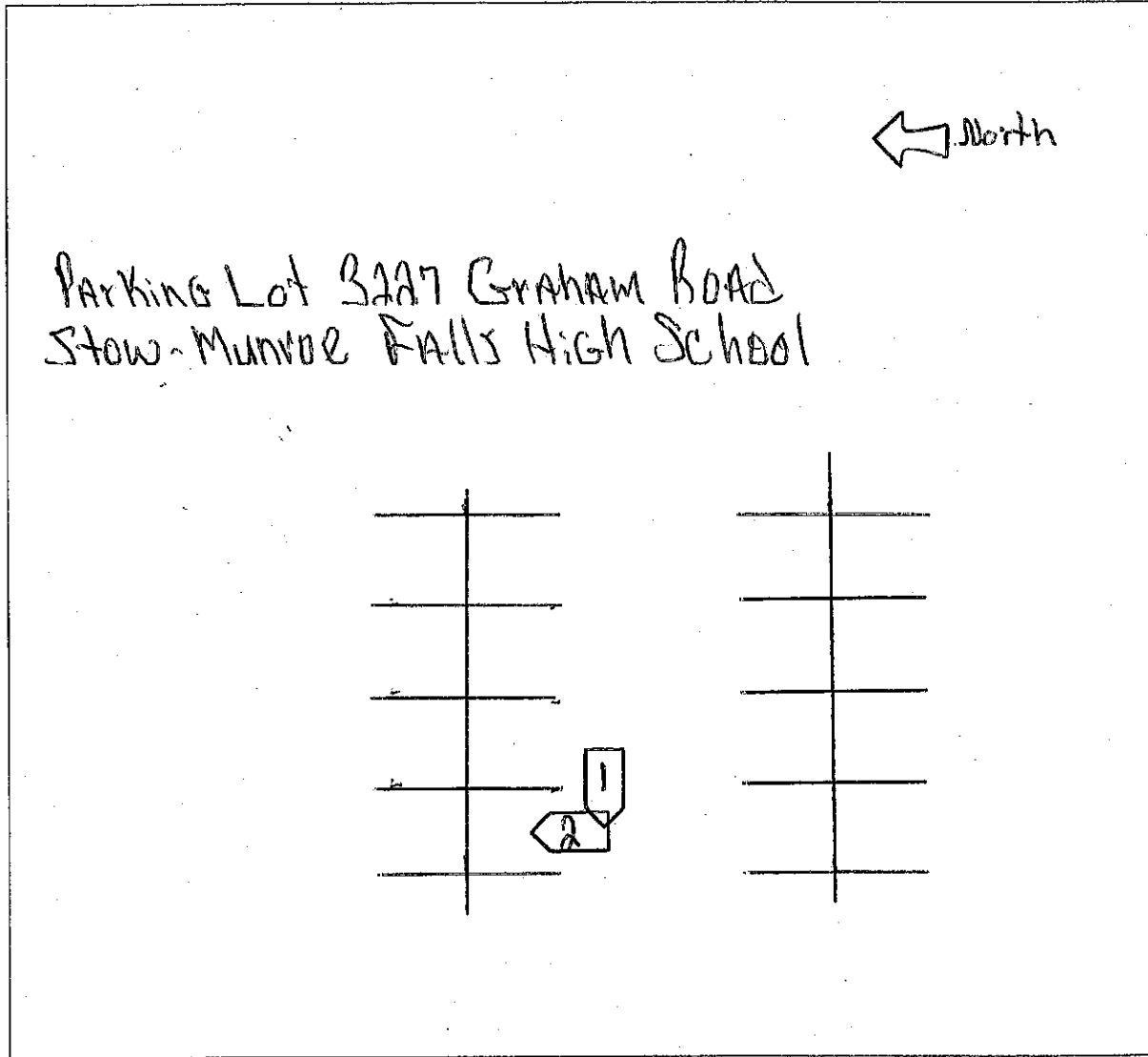

WEATHER

- CLEAR
- RAIN
- SNOW
- FOG
- OTHER

LIGHT

- DAYLIGHT
- DAWN
- DUSK
- DARK - LIGHTED ROAD
- DARK - NOT LIGHTED
- DARK - UNK LIGHTING
- UNKNOWN

SURFACE

- DRY
- WET
- SNOW
- ICE
- OTHER

ROAD

- CONCRETE
- BLACKTOP
- DIRT
- OTHER

LOCAL REPORT NUMBER <i>22-017916</i>	REPORTING AGENCY <i>Stow PD</i>	DATE OF CRASH M <i>2</i> D <i>7</i> YR <i>22</i>
---	------------------------------------	---

FOR LOCAL USE ONLY - DO NOT SUBMIT TO THE STATE EXCEPT FOR FATAL CRASHES

I, *Laney Schmitt* HEREBY MAKE THIS VOLUNTARY STATEMENT TO
PRINTED

B. Smith #1728 AT *3227 Graham road*
OFFICER'S NAME LOCATION

I pulled out of my parking spot and started to drive down the row to leave. The blue car pulled out in front of me so I slammed on my breaks. Our cars were already too close and we hit each other.

ADDRESS OF WITNESS <i>1227 Acndale Road, Stow OH.0</i>	PHONE [REDACTED]
SIGNATURE OF WITNESS X <i>Laney Schmitt</i>	OFFICER'S SIGNATURE X <i>B. Smith #1728</i>

LOCAL REPORT NUMBER 22-017912	REPORTING AGENCY Stow PD	DATE OF CRASH M 2 D 7 Y 22
---	------------------------------------	--

FOR LOCAL USE ONLY - DO NOT SUBMIT TO THE STATE EXCEPT FOR FATAL CRASHES

I, Amanda Whitaker PRINTED HEREBY MAKE THIS VOLUNTARY STATEMENT TO
B. Smith OFFICER'S NAME AT 3227 GRAHAM ROAD LOCATION

I was backing out slowly so I could see around the other cars and she (the other driver) came flying out of nowhere and by the time we saw each other it was too late to stop.

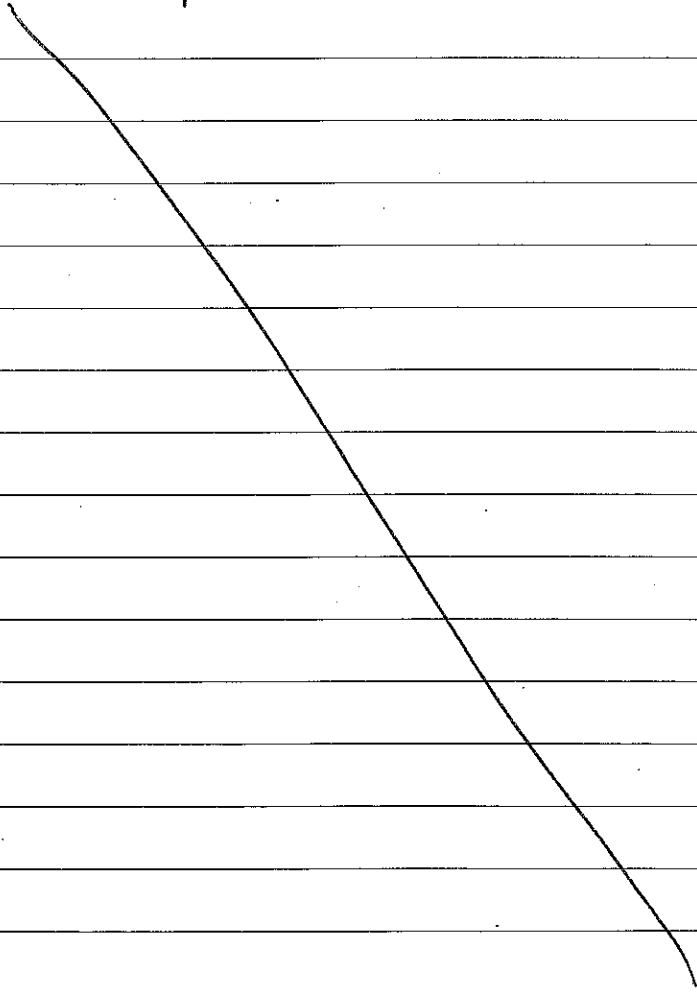

ADDRESS OF WITNESS <u>5157 Terra Lee Circle, Stow, Ohio 44224</u>	PHONE [REDACTED]
SIGNATURE OF WITNESS <u>X [Signature]</u>	OFFICER'S SIGNATURE <u>X [Signature]</u>