



STOW POLICE DEPARTMENT

PRIVATE PROPERTY ACCIDENT REPORT/MINOR TRAFFIC ACCIDENT REPORT

INCIDENT NUMBER

2022-01404

DATE

01/30/2022

TIME

1236

 Private Property Private Property - Hit/Skip Minor Traffic Accident

LOCATION - ADDRESS

4200 Kent Road - Stow, OH 44224

DRIVER #1 - NAME (Last, First, Middle)

Davidson, Meredith L.

PHONE

ADDRESS

3769 Silvercrest Dr.

CITY

Stow

STATE

OH

ZIP

44224

SSN

DATE OF BIRTH

02/22/1981

DRIVER'S LICENSE NUMBER

STATE

OH

VEHICLE #1

OWNER #1 - NAME (Last, First, Middle)

 SAME AS DRIVER #1

PHONE

ADDRESS

CITY

STATE

ZIP

SSN

DATE OF BIRTH

DRIVER'S LICENSE NUMBER

STATE

VEHICLE LICENSE#

HBL 2380

STATE

OH

YEAR

2009

MAKE

Toyota

MODEL

Camry

COLOR

Green

INSURANCE COMPANY

Erie

POLICY NUMBER

Q 05 7308918

PARTS OF VEHICLE DAMAGED

Rear, driver side bumper, quarter panel

CONTRIBUTING CIRCUMSTANCES

None

DRIVER #2 - NAME (Last, First, Middle)

Glover, Ve Shaun Antonio

PHONE

ADDRESS

4433 Fishcreek Rd.

CITY

Stow

STATE

OH

ZIP

44224

SSN

DATE OF BIRTH

03/12/1997

DRIVER'S LICENSE NUMBER

STATE

OH

VEHICLE #2

OWNER #2 - NAME (Last, First, Middle)

 SAME AS DRIVER #2

PHONE

ADDRESS

CITY

STATE

ZIP

SSN

DATE OF BIRTH

DRIVER'S LICENSE NUMBER

STATE

VEHICLE LICENSE #

HFV 6324

STATE

OH

YEAR

2017

MAKE

Hyundai

MODEL

Sonata

COLOR

Silver

INSURANCE COMPANY

None Provided - Unable to show proof

POLICY NUMBER

PARTS OF VEHICLE DAMAGED

Front passenger bumper

CONTRIBUTING CIRCUMSTANCES

Struck vehicle #1, ACDA

DESCRIBE WHAT HAPPENED

Vehicle 1[#] was stopped waiting to make a right turn. Vehicle 2[#] pulled behind vehicle 1[#]. Vehicle 2[#] attempted to drive through the left lane but did not provide enough room and struck Vehicle 1[#].

See Reverse Side for Diagram

SUBMITTED BY:

Pvt. J. Smith 740

DATE

1/30/2022

APPROVING OFFICER:

DATE

1-30-22

STOW POLICE DEPARTMENT

FIELD SKETCH (not drawn to scale)

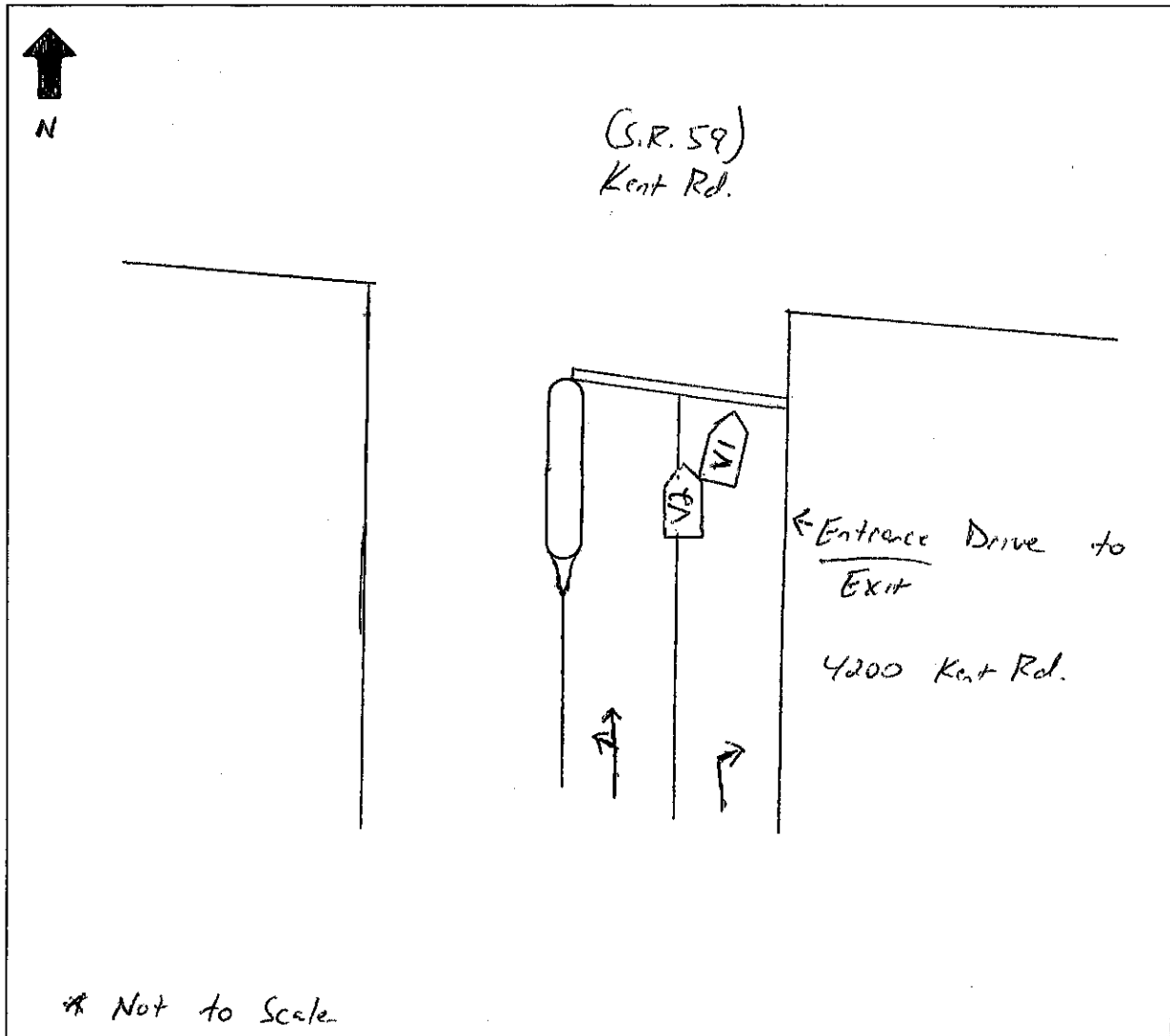

WEATHER

- CLEAR
- RAIN
- SNOW
- FOG
- OTHER
Cloudy

LIGHT

- DAYLIGHT
- DAWN
- DUSK
- DARK - LIGHTED ROAD
- DARK - NOT LIGHTED
- DARK - UNK LIGHTING
- UNKNOWN

SURFACE

- DRY
- WET
- SNOW
- ICE
- OTHER

ROAD

- CONCRETE
- BLACKTOP
- DIRT
- OTHER