



# STOW POLICE DEPARTMENT

## PRIVATE PROPERTY ACCIDENT REPORT/MINOR TRAFFIC ACCIDENT REPORT

INCIDENT NUMBER  
22-01360DATE  
01/29/22TIME  
1233 Private Property  Private Property - Hit/Skip  Minor Traffic Accident

## LOCATION - ADDRESS

4200 Kent Road, Stow, OH 44224 (Target)

## DRIVER #1 - NAME (Last, First, Middle)

Knight, Christy, Leigh

## ADDRESS

485 Newell Avenue

## CITY

Akron

## STATE

OH

## ZIP

44305

## SSN

[REDACTED]

## DATE OF BIRTH

07/20/80

## DRIVER'S LICENSE NUMBER

[REDACTED]

## STATE

OH

## OWNER #1 - NAME (Last, First, Middle)

 SAME AS DRIVER #1

## PHONE

## ADDRESS

## CITY

## STATE

## ZIP

## SSN

## DATE OF BIRTH

## DRIVER'S LICENSE NUMBER

## STATE

## VEHICLE LICENSE#

F1B6684

## STATE

OH

## YEAR

2014

## MAKE

Hyundai

## MODEL

Elantra

## COLOR

Black

## INSURANCE COMPANY

Progressive

## POLICY NUMBER

906527168

## PARTS OF VEHICLE DAMAGED

Driver's Side Quarter Panel

## CONTRIBUTING CIRCUMSTANCES

None

## DRIVER #2 - NAME (Last, First, Middle)

Kotecki, Catarina, Scali

## ADDRESS

2946 Boston Mills Road

## CITY

Brecksville

## STATE

OH

## ZIP

44141

## SSN

[REDACTED]

## DATE OF BIRTH

01/19/63

## DRIVER'S LICENSE NUMBER

[REDACTED]

## STATE

ID

## OWNER #2 - NAME (Last, First, Middle)

Kotecki, David, Allan

 SAME AS DRIVER #2

## PHONE

## ADDRESS

1251 Bluebird Lane

## CITY

Idaho Falls

## STATE

ID

## ZIP

83402

## SSN

[REDACTED]

## DATE OF BIRTH

05/19/61

## DRIVER'S LICENSE NUMBER

[REDACTED]

## STATE

ID

## VEHICLE LICENSE #

8BLN791

## STATE

ID

## YEAR

2019

## MAKE

Honda

## MODEL

CR-V

## COLOR

Gray

## INSURANCE COMPANY

Progressive

## POLICY NUMBER

941606509

## PARTS OF VEHICLE DAMAGED

Passenger's Side Front Bumper

## CONTRIBUTING CIRCUMSTANCES

Failure to Yield Right of Way

## DESCRIBE WHAT HAPPENED

Unit #1 was southbound in the parking lot near Target. Unit #2 was westbound in the parking lot near Target. Unit #2 failed to yield the right of way when making a left turn, striking the rear quarter panel of Unit #1.

The driver of Unit #2 stated they were southbound and they never saw Unit #1, until Unit #1 struck Unit #2. However, video surveillance disputed this claim, and the video was attached to the report.

See Reverse Side for Diagram

## SUBMITTED BY:

Ofc. Balog 749

## DATE

01/29/22

## APPROVING OFFICER:

[Signature]

## DATE

1-29-22

# STOW POLICE DEPARTMENT

## FIELD SKETCH (not drawn to scale)

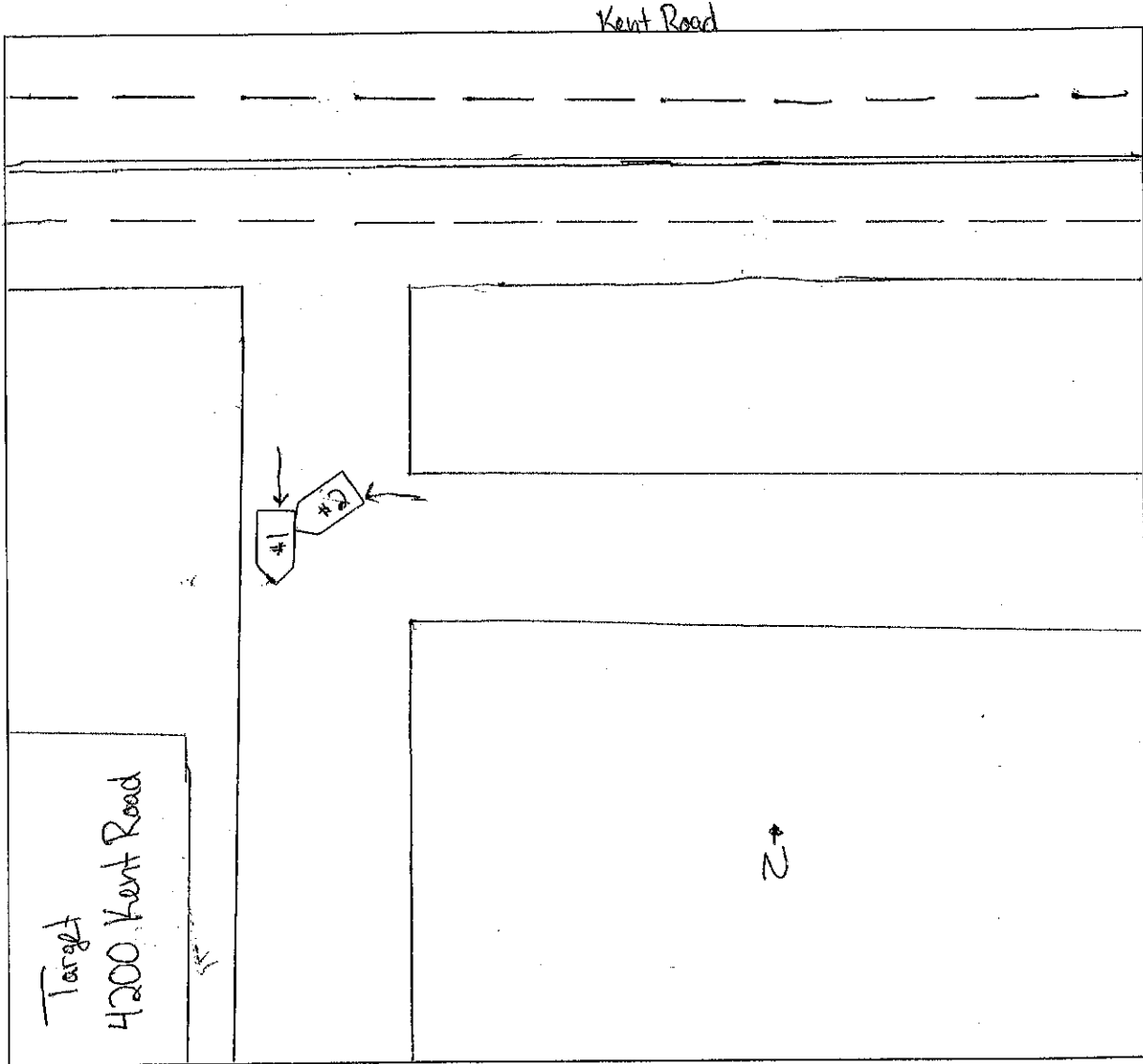

### WEATHER

- CLEAR
- RAIN
- SNOW
- FOG
- OTHER

### LIGHT

- DAYLIGHT
- DAWN
- DUSK
- DARK - LIGHTED ROAD
- DARK - NOT LIGHTED
- DARK - UNK LIGHTING
- UNKNOWN

### SURFACE

- DRY
- WET
- SNOW
- ICE
- OTHER

### ROAD

- CONCRETE
- BLACKTOP
- DIRT
- OTHER