



STOW POLICE DEPARTMENT

PRIVATE PROPERTY ACCIDENT REPORT/MINOR TRAFFIC ACCIDENT REPORT

INCIDENT NUMBER 22-0612

DATE 01/15/22 TIME 1623

Private Property Private Property -- Hit/Skip Minor Traffic Accident

LOCATION - ADDRESS
4044 Fishcreek Rd, Stow, OH 44224

DRIVER #1 - NAME (Last, First, Middle) Unoccupied PHONE -
 ADDRESS - CITY - STATE - ZIP -
 SSN - DATE OF BIRTH - DRIVER'S LICENSE NUMBER - STATE -

VEHICLE #1
 OWNER #1 - NAME (Last, First, Middle) SAME AS DRIVER #1 Woldman, James, M PHONE -
 ADDRESS 4368 Fishcreek Rd CITY Stow STATE OH ZIP 44224
 SSN - DATE OF BIRTH 03/26/31 DRIVER'S LICENSE NUMBER - STATE -
 VEHICLE LICENSE # HG16559 STATE OH YEAR 2016 MAKE Ford MODEL Fusion COLOR Silver
 INSURANCE COMPANY Granda POLICY NUMBER 5084753

PARTS OF VEHICLE DAMAGED Passenger door & rear door CONTRIBUTING CIRCUMSTANCES N/A

DRIVER #2 - NAME (Last, First, Middle) UNKNOWN PHONE -
 ADDRESS - CITY - STATE - ZIP -
 SSN - DATE OF BIRTH - DRIVER'S LICENSE NUMBER - STATE -

VEHICLE #2
 OWNER #2 - NAME (Last, First, Middle) SAME AS DRIVER #2 UNKNOWN PHONE -
 ADDRESS - CITY - STATE - ZIP -
 SSN - DATE OF BIRTH - DRIVER'S LICENSE NUMBER - STATE -
 VEHICLE LICENSE # - STATE - YEAR - MAKE - MODEL - COLOR -
 INSURANCE COMPANY - POLICY NUMBER -

PARTS OF VEHICLE DAMAGED - CONTRIBUTING CIRCUMSTANCES -

DESCRIBE WHAT HAPPENED
Unit #1 was parked in the parking lot of 4044 Fishcreek Rd, Unit #2 damaged the left side of unit #1 before leaving the scene.

See Reverse Side for Diagram

SUBMITTED BY: OFC. WIKA #761 DATE 01/15/22

APPROVING OFFICER: [Signature] DATE 1-15-22

STOW POLICE DEPARTMENT

FIELD SKETCH (not drawn to scale)

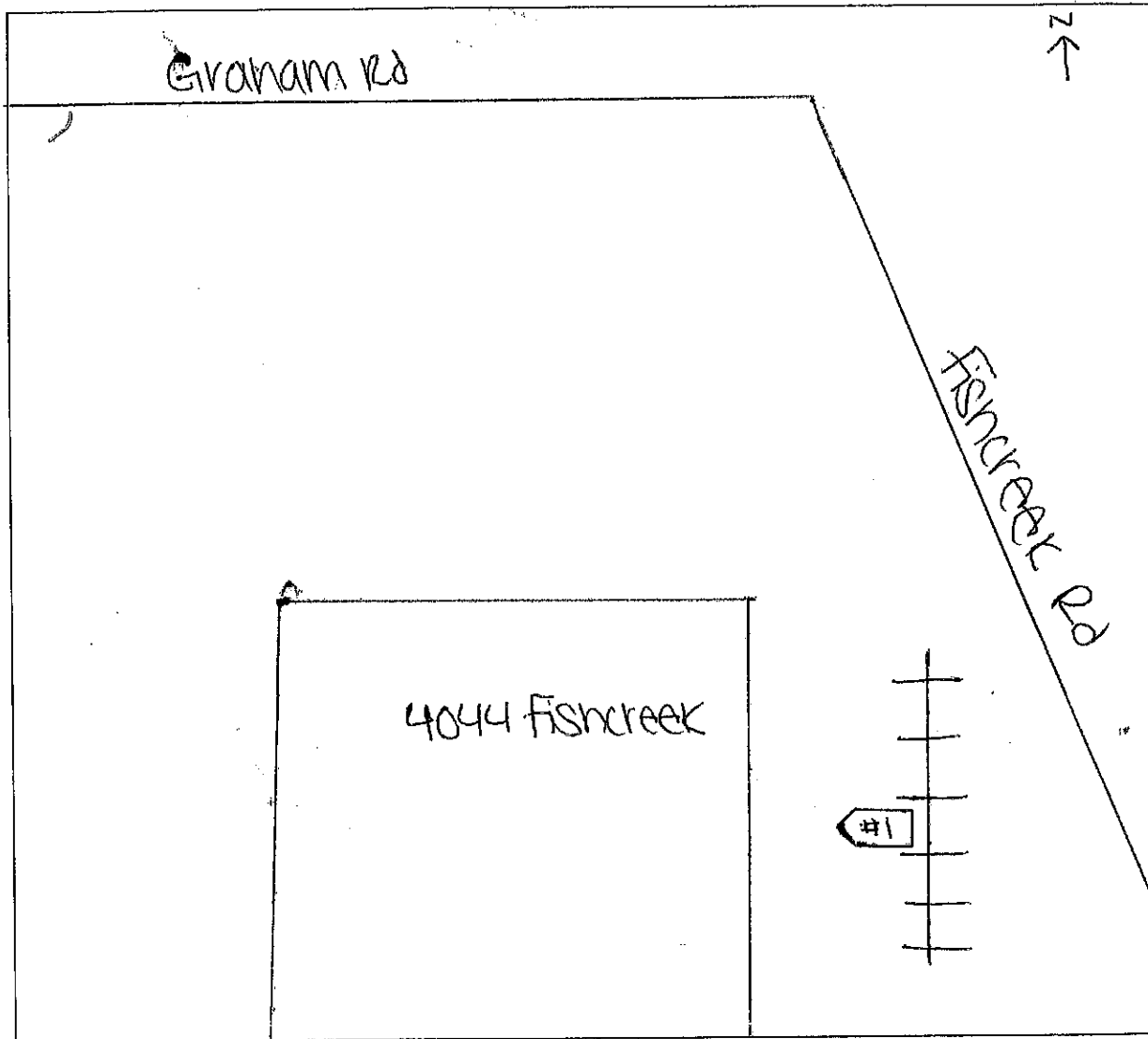

WEATHER

- CLEAR
- RAIN
- SNOW
- FOG
- OTHER

LIGHT

- DAYLIGHT
- DAWN
- DUSK
- DARK - LIGHTED ROAD
- DARK - NOT LIGHTED
- DARK - UNK LIGHTING
- UNKNOWN

SURFACE

- DRY
- WET
- SNOW
- ICE
- OTHER

ROAD

- CONCRETE
- BLACKTOP
- DIRT
- OTHER