



STOW POLICE DEPARTMENT

PRIVATE PROPERTY ACCIDENT REPORT/MINOR TRAFFIC ACCIDENT REPORT

INCIDENT NUMBER: 22-00564
 DATE: 1/14/22
 TIME: 1029

Private Property Private Property - Hit/Skip Minor Traffic Accident

LOCATION - ADDRESS: 3520 Hudson Dr, Stow, OH 44224

VEHICLE #1

DRIVER #1 - NAME (Last, First, Middle): Locke, Marie, L
 PHONE: [REDACTED]

ADDRESS: 1580 Front St
 CITY: Cuyahoga Falls
 STATE: OH
 ZIP: 44221

SSN: [REDACTED]
 DATE OF BIRTH: 2/17/77
 DRIVER'S LICENSE NUMBER: [REDACTED]
 STATE: OH

OWNER #1 - NAME (Last, First, Middle): Locke, Kevin, P
 SAME AS DRIVER #1
 PHONE: [REDACTED]

ADDRESS: 1580 Front St
 CITY: Cuyahoga Falls
 STATE: OH
 ZIP: 44221

SSN: [REDACTED]
 DATE OF BIRTH: 10/05/73
 DRIVER'S LICENSE NUMBER: [REDACTED]
 STATE: OH

VEHICLE LICENSE #: FIU3493
 STATE: OH
 YEAR: 2010
 MAKE: Honda
 MODEL: CR-V
 COLOR: RED

INSURANCE COMPANY: [REDACTED]
 POLICY NUMBER: 9224 J 116383

PARTS OF VEHICLE DAMAGED: Front Bumper
 CONTRIBUTING CIRCUMSTANCES: None

VEHICLE #2

DRIVER #2 - NAME (Last, First, Middle): Stala, Heather, J
 PHONE: [REDACTED]

ADDRESS: 375 Lindenwood Ave
 CITY: Akron
 STATE: OH
 ZIP: 44301

SSN: UNK
 DATE OF BIRTH: 6/9/76
 DRIVER'S LICENSE NUMBER: [REDACTED]
 STATE: PA

OWNER #2 - NAME (Last, First, Middle): [REDACTED]
 SAME AS DRIVER #2
 PHONE: [REDACTED]

ADDRESS: [REDACTED]
 CITY: [REDACTED]
 STATE: [REDACTED]
 ZIP: [REDACTED]

SSN: [REDACTED]
 DATE OF BIRTH: [REDACTED]
 DRIVER'S LICENSE NUMBER: [REDACTED]
 STATE: [REDACTED]

VEHICLE LICENSE #: ZSS 7106
 STATE: PA
 YEAR: 2007
 MAKE: Dodge
 MODEL: Durango
 COLOR: TAN

INSURANCE COMPANY: AAA
 POLICY NUMBER: PASS 213880071

PARTS OF VEHICLE DAMAGED: Front left
 CONTRIBUTING CIRCUMSTANCES: Failure To Yield

DESCRIBE WHAT HAPPENED: Veh#1 was southbound driving in a lane towards the exit of 3520 Hudson Dr. Veh#2 was exiting an aisle driving eastbound and stopped at the stop sign. Veh#2 proceeded into the lane with the intentions of turning right (south). Veh#2 failed to yield the right of way to Veh#1. Veh#1 struck the front left of Veh#2.

See Reverse Side for Diagram

SUBMITTED BY: Pte B. Bladino #1736
 DATE: 1/14/22

APPROVING OFFICER: [Signature]
 DATE: 1-14-22

STOW POLICE DEPARTMENT

FIELD SKETCH (not drawn to scale)

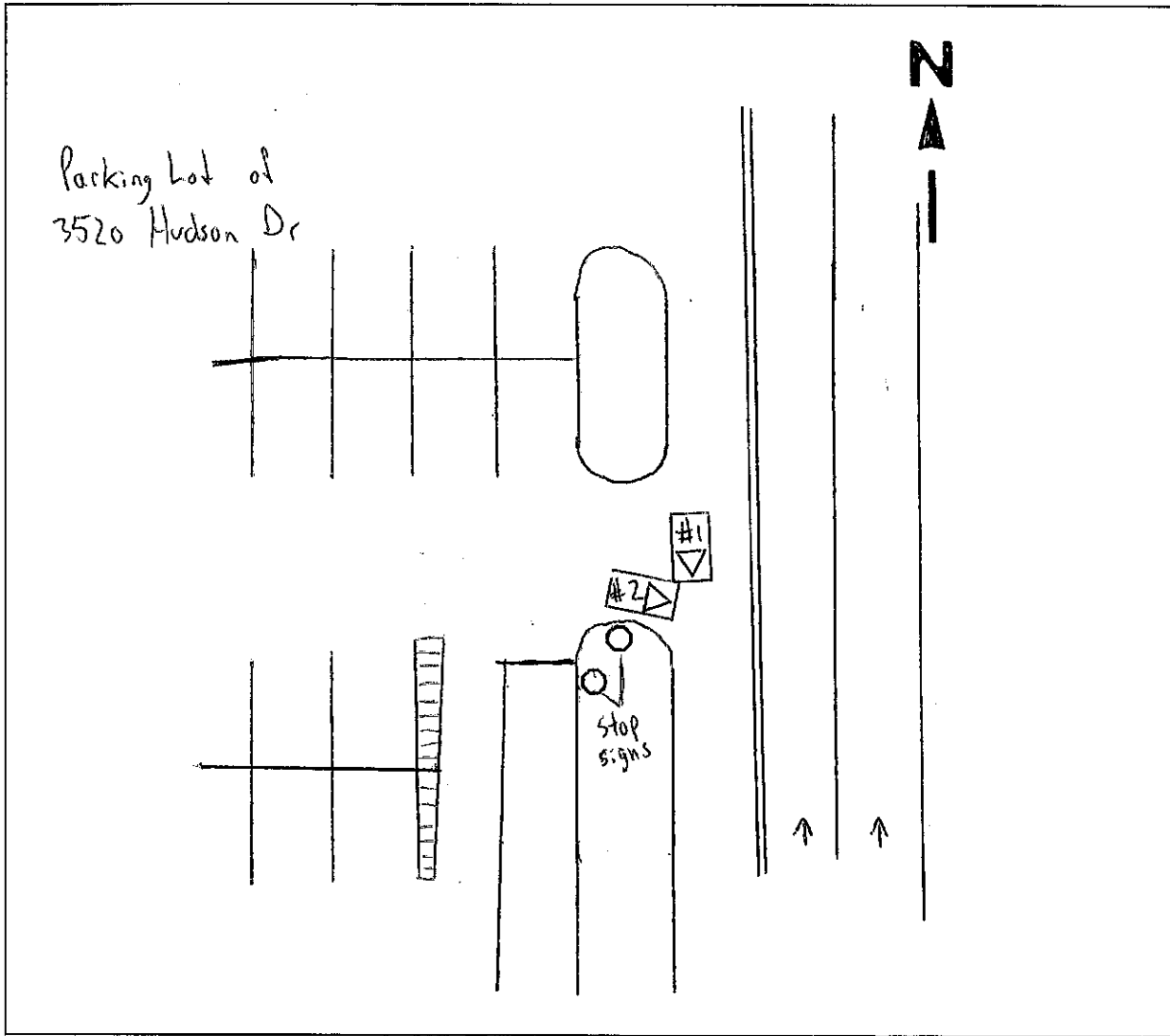

WEATHER

- CLEAR
- RAIN
- SNOW
- FOG
- OTHER

LIGHT

- DAYLIGHT
- DAWN
- DUSK
- DARK - LIGHTED ROAD
- DARK - NOT LIGHTED
- DARK - UNK LIGHTING
- UNKNOWN

SURFACE

- ~~DRY~~
- WET
- SNOW
- ICE
- OTHER

ROAD

- CONCRETE
- BLACKTOP
- DIRT
- OTHER