



# STOW POLICE DEPARTMENT

PRIVATE PROPERTY ACCIDENT REPORT/MINOR  
TRAFFIC ACCIDENT REPORT

INCIDENT NUMBER  
**20-12431**

DATE  
**8/23/20**

TIME  
**1251**

Private Property    Private Property - Hit/Skip    Minor Traffic Accident

LOCATION - ADDRESS  
**4300 Kent Rd Stow OH 44224**

VEHICLE #1

DRIVER #1 - NAME (Last, First, Middle) **Turner, Nicole, R** PHONE [REDACTED]

ADDRESS **4362 Cherryhurst Dr** CITY **Stow** STATE **OH** ZIP **44224**

SSN [REDACTED] DATE OF BIRTH **12/01/70** DRIVER'S LICENSE NUMBER [REDACTED] STATE **OH**

OWNER #1 - NAME (Last, First, Middle)  SAME AS DRIVER #1 PHONE [REDACTED]

ADDRESS [REDACTED] CITY [REDACTED] STATE [REDACTED] ZIP [REDACTED]

SSN [REDACTED] DATE OF BIRTH [REDACTED] DRIVER'S LICENSE NUMBER [REDACTED] STATE [REDACTED]

VEHICLE LICENSE# **FQZ 1899** STATE **OH** YEAR [REDACTED] MAKE **Toyota** MODEL **Highlander** COLOR **SEL**

INSURANCE COMPANY **State Farm** POLICY NUMBER **995 2051-C12-35**

PARTS OF VEHICLE DAMAGED  
**Rear passenger side fender**

VEHICLE #2

DRIVER #2 - NAME (Last, First, Middle) **Lober, Casey, Renee** PHONE [REDACTED]

ADDRESS **1219 Apt #1 E Main St.** CITY **Kent** STATE **OH** ZIP **44240**

SSN **UNK** DATE OF BIRTH **1/15/99** DRIVER'S LICENSE NUMBER [REDACTED] STATE **PA**

OWNER #2 - NAME (Last, First, Middle)  SAME AS DRIVER #2 PHONE [REDACTED]

ADDRESS **240 Alexander Ave** CITY **Strabane** STATE **PA** ZIP **15363**

SSN **-** DATE OF BIRTH **5/5/66** DRIVER'S LICENSE NUMBER **UNK** STATE **-**

VEHICLE LICENSE # **JXS 2751** STATE **PA** YEAR [REDACTED] MAKE **Hundai** MODEL **Sonata** COLOR **Light Blu**

INSURANCE COMPANY **State Farm** POLICY NUMBER **269 3045-B25-38E**

PARTS OF VEHICLE DAMAGED  
**Rear passenger side bumper/tail light**

DESCRIBE WHAT HAPPENED  
**Veh#1 and Veh#2 were both parked in the parking lot of Giant Eagle, 4300 Kent Rd. Both vehicles were backing out of their parking spaces and the vehicles collided. The driver of Veh#1 states she began to back up first. The driver of Veh#2 states they began backing up at the same time.**

See Reverse Side for Diagram

SUBMITTED BY: **P. B. HADIX 736** DATE **8/23/20**

APPROVING OFFICER: **[Signature]** DATE **8-23-20**

# STOW POLICE DEPARTMENT

FIELD SKETCH (not drawn to scale)

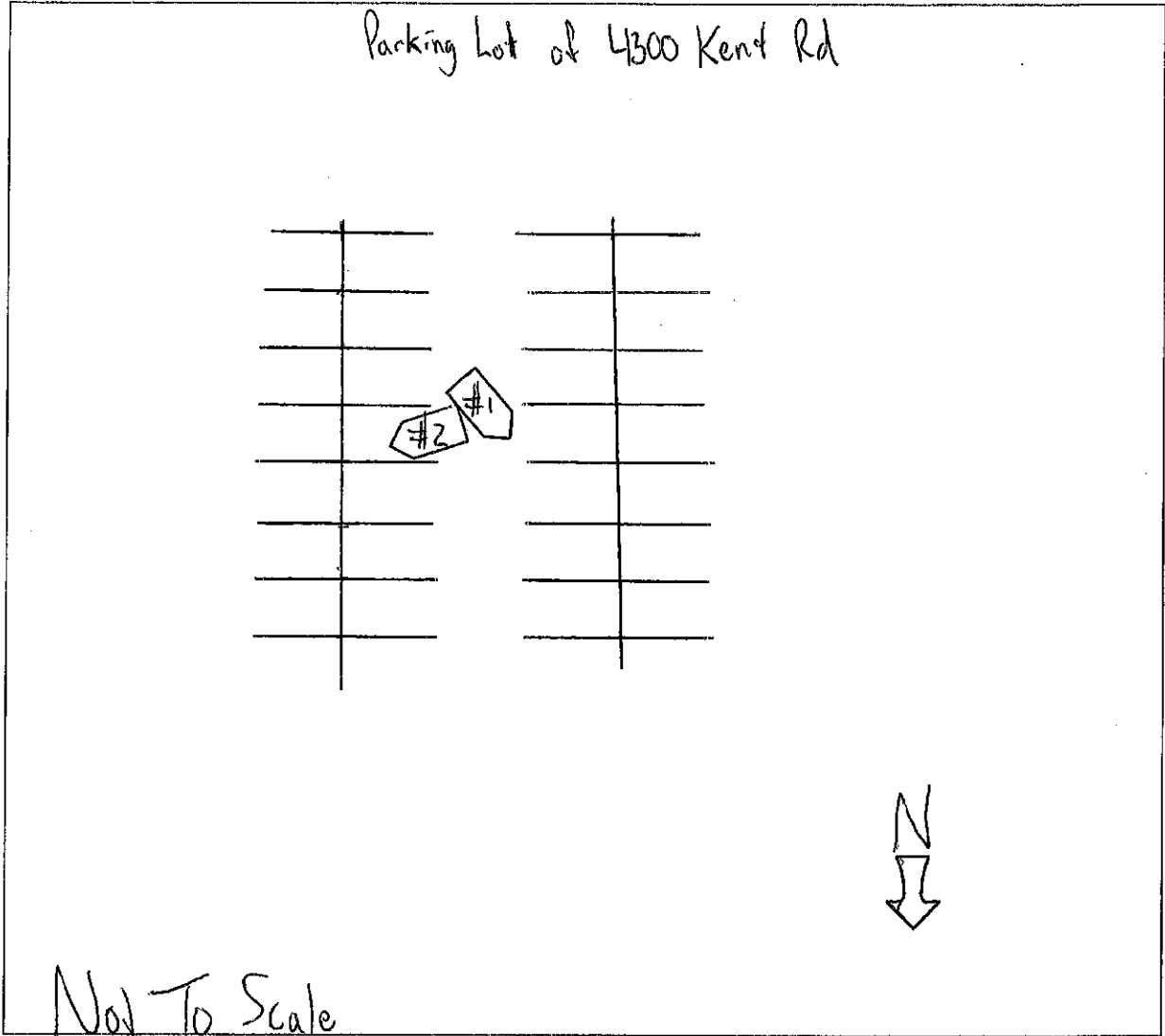

## WEATHER

- CLEAR
- RAIN
- SNOW
- FOG

## LIGHT

- DAYLIGHT
- DARKNESS
- WITH STREET LIGHTS

## SURFACE

- DRY
- WET
- SNOW
- OTHER

## ROAD

- CONCRETE
- BLACKTOP
- DIRT
- OTHER