



STOW POLICE DEPARTMENT

PRIVATE PROPERTY ACCIDENT REPORT/MINOR TRAFFIC ACCIDENT REPORT

INCIDENT NUMBER

20-7352

DATE

5/21/20

TIME

10/17

 Private Property
 Private Property - Hit/Skip
 Minor Traffic Accident

LOCATION - ADDRESS

4152 Kent Rd. Stow, OH 44224

DRIVER #1 - NAME (Last, First, Middle)

Conrad, Andrew, Richard

PHONE

ADDRESS

2524 Norman Dr.

CITY

Stow

STATE

OH

ZIP

44224

SSN

DATE OF BIRTH

1/21/95

DRIVER'S LICENSE NUMBER

STATE

OH

VEHICLE #1

OWNER #1 - NAME (Last, First, Middle)

Ean Holdings LLC

 SAME AS DRIVER #1

PHONE

ADDRESS

4002 E 21st street. STE 1500

CITY

Tusca

STATE

OK

ZIP

74134

SSN

DATE OF BIRTH

NIA

NIA

DRIVER'S LICENSE NUMBER

NIA

STATE

OH

VEHICLE LICENSE #

DPR2852

STATE

MI

YEAR

2019

MAKE

Hyundai

MODEL

Elantra

COLOR

Silver

INSURANCE COMPANY

Progressive

POLICY NUMBER

925956239

PARTS OF VEHICLE DAMAGED

Front license plate bracket

CONTRIBUTING CIRCUMSTANCES

none

DRIVER #2 - NAME (Last, First, Middle)

Westerfield, James, J.

PHONE

ADDRESS

2141 Liberty Rd.

CITY

Stow

STATE

OH

ZIP

44224

SSN

DATE OF BIRTH

11/3/61

DRIVER'S LICENSE NUMBER

STATE

FL

VEHICLE #2

OWNER #2 - NAME (Last, First, Middle)

 SAME AS DRIVER #2

PHONE

ADDRESS

CITY

STATE

ZIP

SSN

DATE OF BIRTH

DRIVER'S LICENSE NUMBER

STATE

VEHICLE LICENSE #

H2D2902

STATE

OH

YEAR

2005

MAKE

Ford

MODEL

Expedition

COLOR

Black

INSURANCE COMPANY

Geico

POLICY NUMBER

450732-01-99

PARTS OF VEHICLE DAMAGED

none

CONTRIBUTING CIRCUMSTANCES

Rules for starting & backing

DESCRIBE WHAT HAPPENED

Vehicle #2 was attempting to exit private property at 4152 Kent Rd. The driver thought he was clear to go and inched into the roadway on Kent Rd. The driver realized he wasn't clear and put his vehicle in reverse. While reversing, he struck vehicle #1, who was behind him.

See Reverse Side for Diagram

SUBMITTED BY:

DATE

5/21/20

APPROVING OFFICER:

DATE

05/21/2020

STOW POLICE DEPARTMENT

FIELD SKETCH (not drawn to scale)

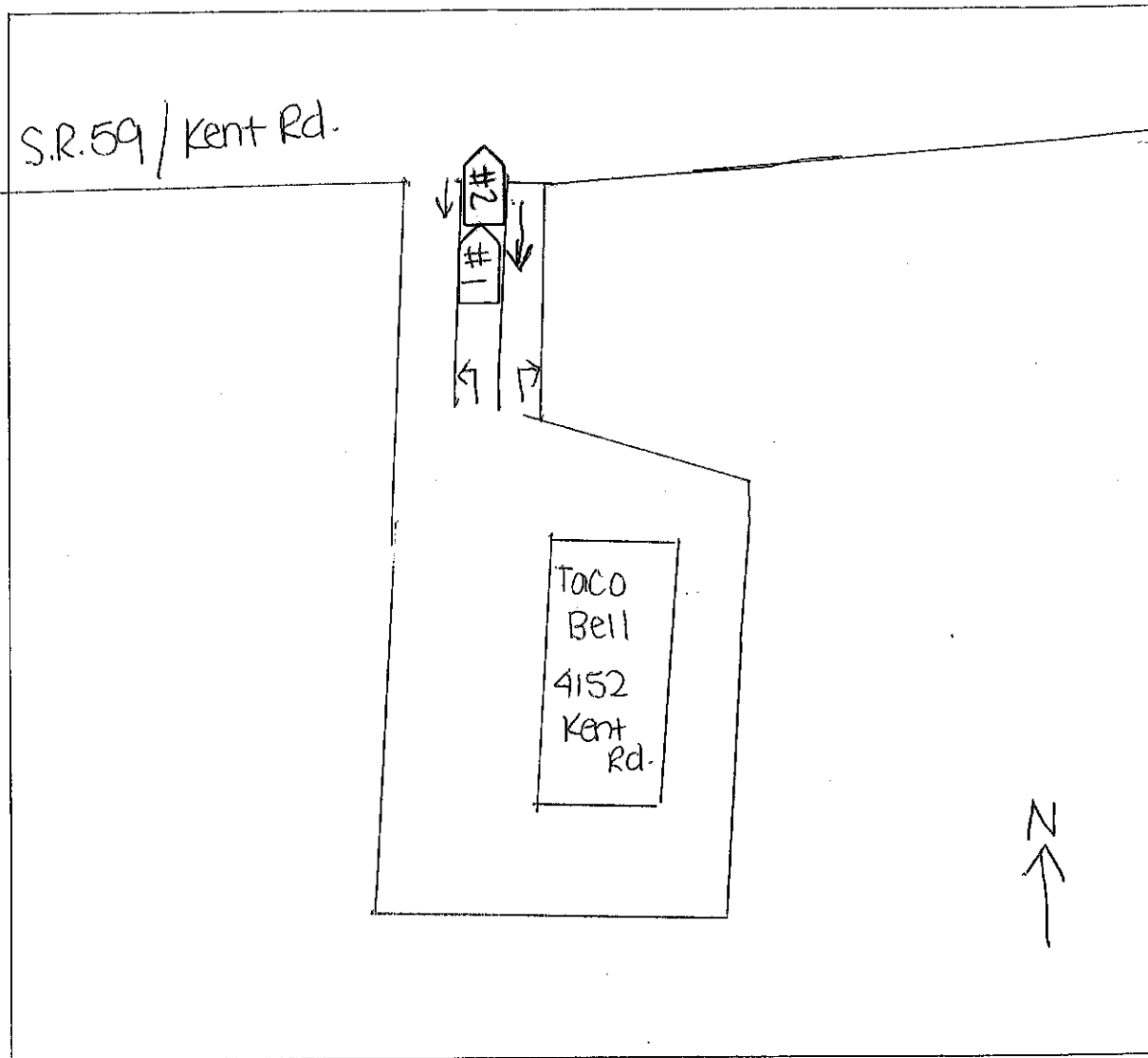

WEATHER

- CLEAR
- RAIN
- SNOW
- FOG
- OTHER

LIGHT

- DAYLIGHT
- DAWN
- DUSK
- DARK - LIGHTED ROAD
- DARK - NOT LIGHTED
- DARK - UNK LIGHTING
- UNKNOWN

SURFACE

- DRY
- WET
- SNOW
- ICE
- OTHER

ROAD

- CONCRETE
- BLACKTOP
- DIRT
- OTHER