



STOW POLICE DEPARTMENT

PRIVATE PROPERTY ACCIDENT REPORT/MINOR TRAFFIC ACCIDENT REPORT

INCIDENT NUMBER

21-20468

DATE

12-14-21

TIME

1424

Private Property Private Property - Hit/Skip Minor Traffic Accident

LOCATION - ADDRESS

1469 Commerce

DRIVER #1 - NAME (Last, First, Middle)

Bilotti, Jonmarie

PHONE

ADDRESS

3085 E. Ridgewood Dr

CITY

Seven Hills

STATE

OH

ZIP

44131

SSN

DATE OF BIRTH

11-01-68

DRIVER'S LICENSE NUMBER

STATE

VEHICLE #1

OWNER #1 - NAME (Last, First, Middle)

SAME AS DRIVER #1

PHONE

ADDRESS

CITY

STATE

ZIP

SSN

DATE OF BIRTH

DRIVER'S LICENSE NUMBER

STATE

VEHICLE LICENSE#

STATE

YEAR

MAKE

MODEL

COLOR

J6P1252

OH

2021

Hyundai

Elantra

white

INSURANCE COMPANY

POLICY NUMBER

PARTS OF VEHICLE DAMAGED

Under carriage of front bumper

CONTRIBUTING CIRCUMSTANCES

Full Time + Attention

DRIVER #2 - NAME (Last, First, Middle)

PHONE

ADDRESS

CITY

STATE

ZIP

SSN

DATE OF BIRTH

DRIVER'S LICENSE NUMBER

STATE

VEHICLE #2

OWNER #2 - NAME (Last, First, Middle)

SAME AS DRIVER #2

PHONE

ADDRESS

CITY

STATE

ZIP

SSN

DATE OF BIRTH

DRIVER'S LICENSE NUMBER

STATE

VEHICLE LICENSE #

STATE

YEAR

MAKE

MODEL

COLOR

INSURANCE COMPANY

POLICY NUMBER

PARTS OF VEHICLE DAMAGED

CONTRIBUTING CIRCUMSTANCES

DESCRIBE WHAT HAPPENED

Unit #1 was exiting the driveway @ 1469 Commerce. Unit #1 failed to keep full time and attention, as a result she drove off the driveway into a ditch.

See Reverse Side for Diagram

SUBMITTED BY:

[Signature] 739

DATE

12-15-21

APPROVING OFFICER:

[Signature] 710

DATE

12/15/21

STOW POLICE DEPARTMENT

FIELD SKETCH (not drawn to scale)

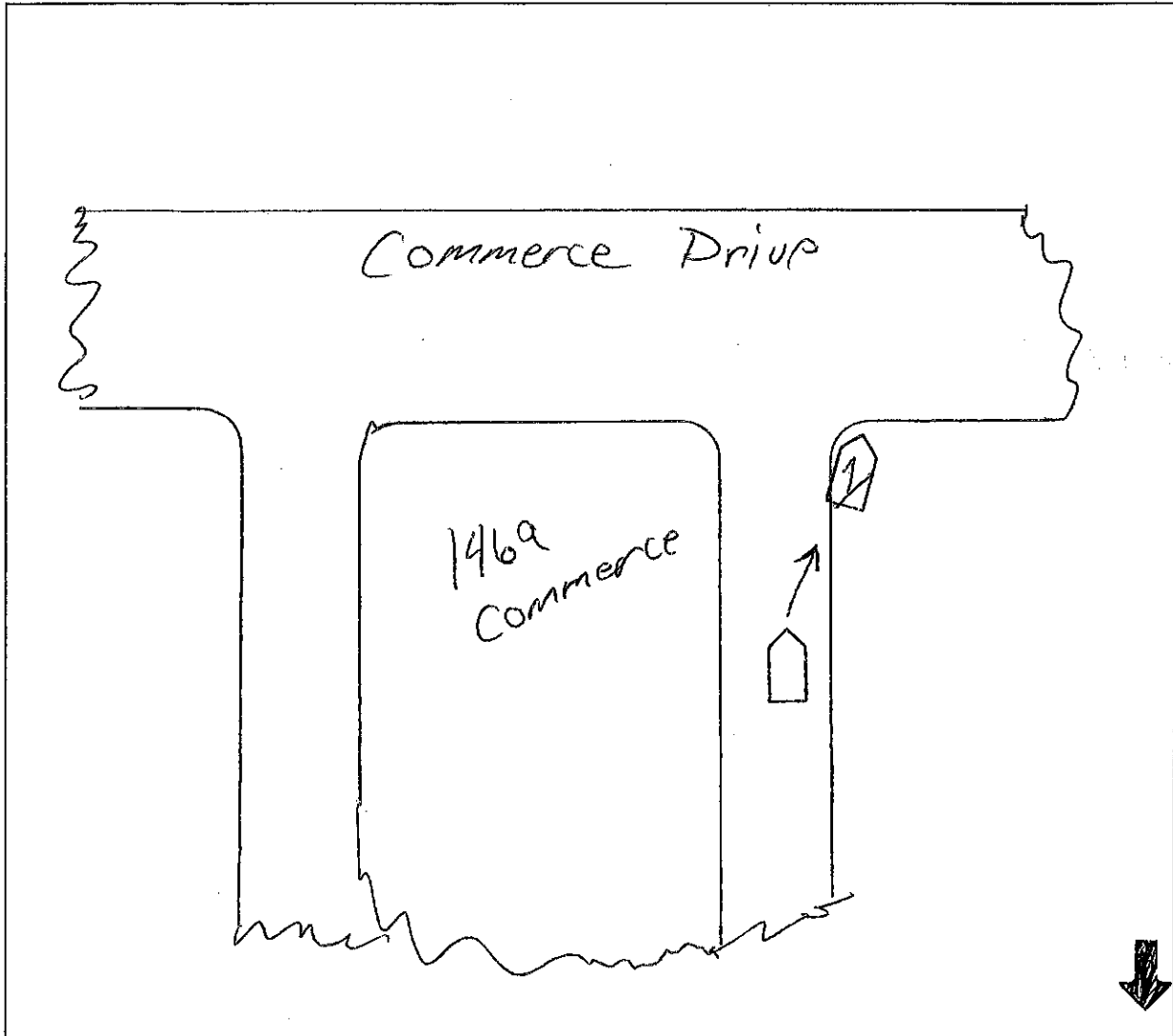

WEATHER

- CLEAR
- RAIN
- SNOW
- FOG
- OTHER

LIGHT

- DAYLIGHT
- DAWN
- DUSK
- DARK - LIGHTED ROAD
- DARK - NOT LIGHTED
- DARK - UNK LIGHTING
- UNKNOWN

SURFACE

- DRY
- WET
- SNOW
- ICE
- OTHER

ROAD

- CONCRETE
- BLACKTOP
- DIRT
- OTHER