



# STOW POLICE DEPARTMENT

## PRIVATE PROPERTY ACCIDENT REPORT/MINOR TRAFFIC ACCIDENT REPORT

INCIDENT NUMBER

21-19049

DATE

11/20/21

TIME

1137

 Private Property  
  Private Property - Hit/Skip  
  Minor Traffic Accident

LOCATION - ADDRESS

3520 Hudson Drive

DRIVER #1 - NAME (Last, First, Middle)

Brown, Amanda, L.

ADDRESS

260 Cuyahoga Street #A

CITY

Akron

STATE

OHIO

ZIP

44304

SSN

DATE OF BIRTH

2/4/81

DRIVER'S LICENSE NUMBER

STATE

OHIO

VEHICLE #1

OWNER #1 - NAME (Last, First, Middle)

 SAME AS DRIVER #1

PHONE

ADDRESS

CITY

STATE

ZIP

SSN

DATE OF BIRTH

DRIVER'S LICENSE NUMBER

STATE

VEHICLE LICENSE#

HMK 4948

STATE

OH

YEAR

2017

MAKE

Chevy

MODEL

Equinox

COLOR

Black

INSURANCE COMPANY

National General

POLICY NUMBER

2009304946

PARTS OF VEHICLE DAMAGED

Driver door

CONTRIBUTING CIRCUMSTANCES

none

DRIVER #2 - NAME (Last, First, Middle)

Myers, Jamie, E.

ADDRESS

80 Donovan Lane

CITY

Akron

STATE

OHIO

ZIP

44310

SSN

DATE OF BIRTH

8-02-89

DRIVER'S LICENSE NUMBER

STATE

OHIO

VEHICLE #2

OWNER #2 - NAME (Last, First, Middle)

 SAME AS DRIVER #2

PHONE

ADDRESS

CITY

STATE

ZIP

SSN

DATE OF BIRTH

DRIVER'S LICENSE NUMBER

STATE

VEHICLE LICENSE #

GEV 2847

STATE

OH

YEAR

2018

MAKE

HYUN

MODEL

Santa FE

COLOR

Black

INSURANCE COMPANY

Geico

POLICY NUMBER

4784547619

PARTS OF VEHICLE DAMAGED

Rear bumper

CONTRIBUTING CIRCUMSTANCES

struck Unit #1

DESCRIBE WHAT HAPPENED

Unit #1 and Unit #2 were in the parking lot of 3520 Hudson Drive. Unit #2 was backing out of a parking spot and struck #1.

See Reverse Side for Diagram

SUBMITTED BY:

Ptl. R. Frisina #742

DATE

11-20-21

APPROVING OFFICER:

DATE

11-20-21

# STOW POLICE DEPARTMENT

## FIELD SKETCH (not drawn to scale)

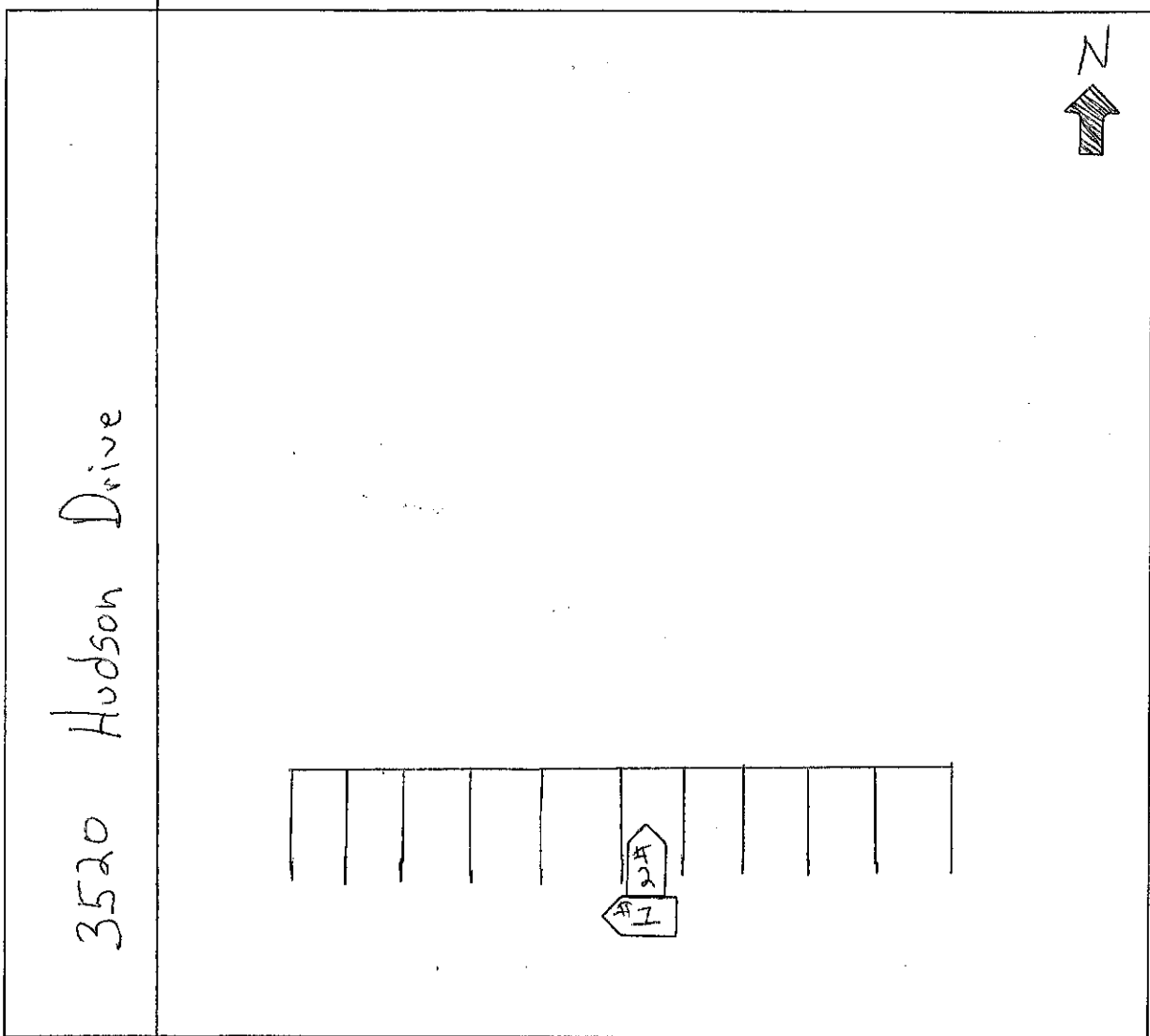

### WEATHER

- CLEAR
- RAIN
- SNOW
- FOG
- OTHER

### LIGHT

- DAYLIGHT
- DAWN
- DUSK
- DARK - LIGHTED ROAD
- DARK - NOT LIGHTED
- DARK - UNK LIGHTING
- UNKNOWN

### SURFACE

- DRY
- WET
- SNOW
- ICE
- OTHER

### ROAD

- CONCRETE
- BLACKTOP
- DIRT
- OTHER