



STOW POLICE DEPARTMENT

PRIVATE PROPERTY ACCIDENT REPORT/MINOR TRAFFIC ACCIDENT REPORT

INCIDENT NUMBER
2021-00015475

DATE
09/23/2021

TIME
1540

Private Property Private Property - Hit/Skip Minor Traffic Accident

LOCATION - ADDRESS
4220 Kent Road Stow, OH 44224

DRIVER #1 - NAME (Last, First, Middle)
Blank, William, F

ADDRESS
1403 Whipoorwill Trl

CITY
Stow

STATE
OH

ZIP
44224

SSN
[REDACTED]

DATE OF BIRTH
08/12/1943

DRIVER'S LICENSE NUMBER
[REDACTED]

STATE
OH

VEHICLE #1

OWNER #1 - NAME (Last, First, Middle) SAME AS DRIVER #1
SAME

ADDRESS
-

CITY
-

STATE
-

ZIP
-

SSN
-

DATE OF BIRTH
-

DRIVER'S LICENSE NUMBER
-

STATE
-

VEHICLE LICENSE#
PENSYRR

STATE
OH

YEAR
2013

MAKE
Hyundai

MODEL
Sonata

COLOR
RED

INSURANCE COMPANY
State Farm

POLICY NUMBER
728-0453-A14-35B

PARTS OF VEHICLE DAMAGED
Driver Side Front Bumper & Fender & Tire/Rim

CONTRIBUTING CIRCUMSTANCES
Failure to Yield

DRIVER #2 - NAME (Last, First, Middle)
Thompson, Nicole, L

ADDRESS
10163 Hewins Rd

CITY
Garrettsville

STATE
OH

ZIP
44231

SSN
[REDACTED]

DATE OF BIRTH
09/27/1982

DRIVER'S LICENSE NUMBER
[REDACTED]

STATE
OH

VEHICLE #2

OWNER #2 - NAME (Last, First, Middle) SAME AS DRIVER #2
SAME

ADDRESS
-

CITY
-

STATE
-

ZIP
-

SSN
-

DATE OF BIRTH
-

DRIVER'S LICENSE NUMBER
-

STATE
-

VEHICLE LICENSE #
JIU6933

STATE
OH

YEAR
2017

MAKE
Ford

MODEL
Explorer

COLOR
WHT

INSURANCE COMPANY
All-State

POLICY NUMBER
826 309 903

PARTS OF VEHICLE DAMAGED
Passenger side front and rear doors (sideskirt)

CONTRIBUTING CIRCUMSTANCES
None

DESCRIBE WHAT HAPPENED

Vehicle #1 was parked in-front of the above listed address. As vehicle #2 travelled pass vehicle #1, vehicle #1 drove into the passenger side of vehicle #2.

See Reverse Side for Diagram

SUBMITTED BY: **P.H. Begunovic 762**

DATE
09/23/2021

APPROVING OFFICER:

DATE

STOW POLICE DEPARTMENT

FIELD SKETCH (not drawn to scale)

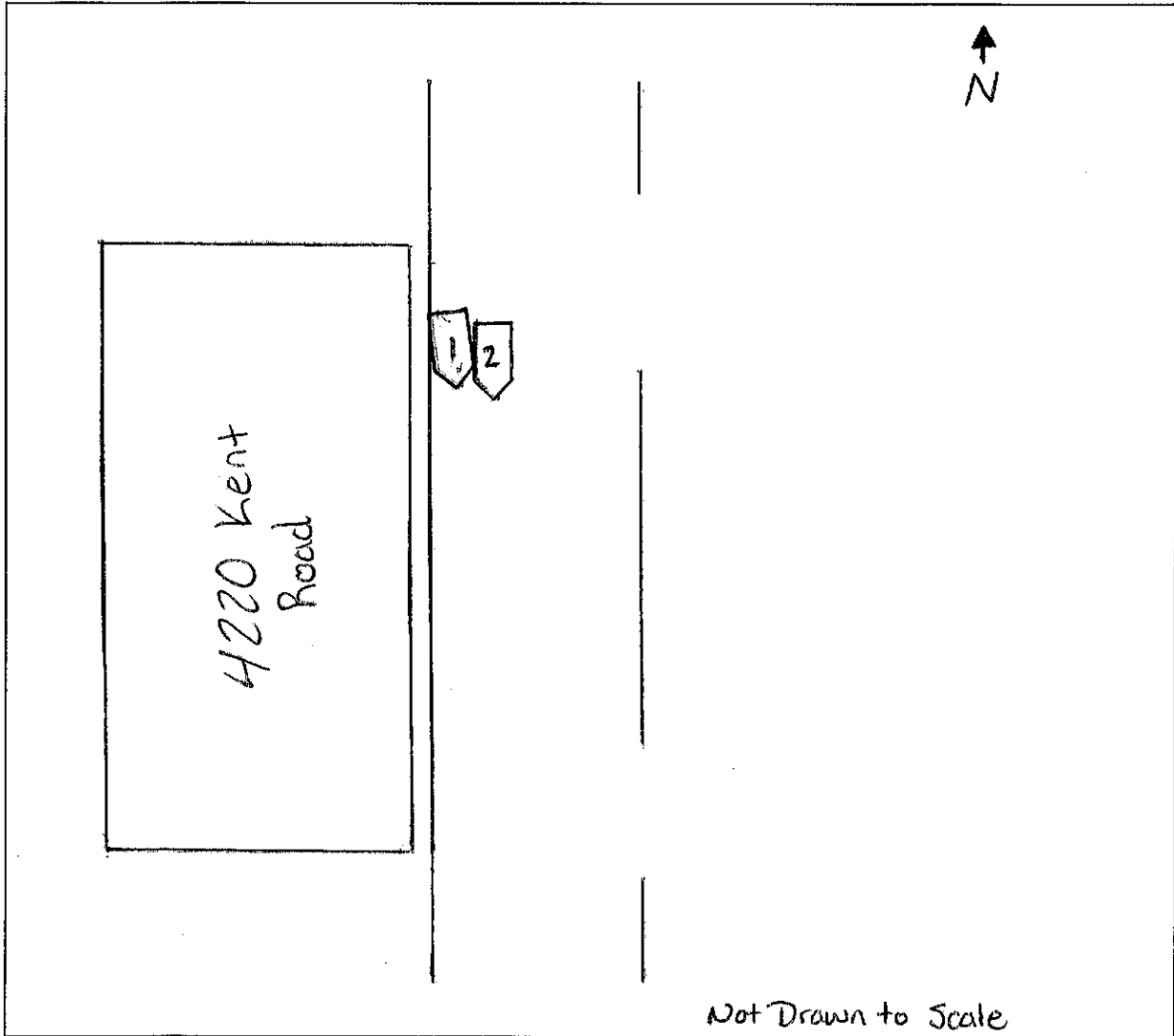

WEATHER

- CLEAR
- RAIN
- SNOW
- FOG
- OTHER

LIGHT

- DAYLIGHT
- DAWN
- DUSK
- DARK - LIGHTED ROAD
- DARK - NOT LIGHTED
- DARK - UNK LIGHTING
- UNKNOWN

SURFACE

- DRY
- WET
- SNOW
- ICE
- OTHER

ROAD

- CONCRETE
- BLACKTOP
- DIRT
- OTHER

LOCAL REPORT NUMBER 2021-00015475	REPORTING AGENCY Stow PD	DATE OF CRASH M 09 D 23 Y 21
--------------------------------------	-----------------------------	-------------------------------------

FOR LOCAL USE ONLY - DO NOT SUBMIT TO THE STATE EXCEPT FOR FATAL CRASHES

I, WILLIAM BLANK HEREBY MAKE THIS VOLUNTARY STATEMENT TO
PRINTED

PI. Begonovic AT 4220 Kent Road
OFFICER'S NAME LOCATION

PULLED up in front of OFFICE MAX
 (STOW KENT) TO pick up WIFE.
 AFTER SHE PUT PURCHASES IN CAR & GOT IN
 I PULLED AWAY FROM CURB
 WITHOUT CHECKING TRAFFIC.

ADDRESS OF WITNESS 1403 Whippoorwill Trail	OFFICER'S SIGNATURE X PI. Begonovic 762
SIGNATURE OF WITNESS X <u>William E. Blank</u>	



LOCAL REPORT NUMBER 2021-00015475	REPORTING AGENCY Stow PD	DATE OF CRASH M 09 D 23 Y 21
--------------------------------------	-----------------------------	-------------------------------------

FOR LOCAL USE ONLY – DO NOT SUBMIT TO THE STATE EXCEPT FOR FATAL CRASHES

I, Nicole Thompson HEREBY MAKE THIS VOLUNTARY STATEMENT TO
PRINTED

At: At. Begonovic AT 4220 Kent Road
OFFICER'S NAME LOCATION

While driving thru plaza by Office Max the
gentle man ^{in a red car} pulled ~~me~~ out of ~~the~~ from by the curb
& hit into the side of my white ford
explorer. I was already 1/2 pass the car
already.

ADDRESS OF WITNESS 10163 Hewins Rd Garrettsville OH 44231	OFFICER'S SIGNATURE X At. Begonovic 762
SIGNATURE OF WITNESS X Nicole Thompson	