



STOW POLICE DEPARTMENT

PRIVATE PROPERTY ACCIDENT REPORT/MINOR TRAFFIC ACCIDENT REPORT

INCIDENT NUMBER
21-12920

DATE
08-13-21

TIME
0926

Private Property Private Property - Hit/Skip Minor Traffic Accident

LOCATION - ADDRESS

3748 IONA AVE. STOW, OH 44224

VEHICLE #1

DRIVER #1 - NAME (Last, First, Middle) N/A PHONE -

ADDRESS - CITY - STATE - ZIP -

SSN - DATE OF BIRTH - DRIVER'S LICENSE NUMBER - STATE -

OWNER #1 - NAME (Last, First, Middle) SAME AS DRIVER #1 PHONE -

ADDRESS RESTORATION RESOURCES INC. CITY HUDSON STATE OH ZIP 44236

1546 GEORGETOWN RD.

SSN - DATE OF BIRTH - DRIVER'S LICENSE NUMBER - STATE -

VEHICLE LICENSE# PKW6075 STATE OH YEAR 19 MAKE CHEVY MODEL BOX TRUCK COLOR GREEN

INSURANCE COMPANY WESTFIELD POLICY NUMBER TRA4473903

PARTS OF VEHICLE DAMAGED LEFT REAR CONTRIBUTING CIRCUMSTANCES PARKED ON FIRE HYDRANT SIDE OF STREET

VEHICLE #2

DRIVER #2 - NAME (Last, First, Middle) WALTERS, LARRY, A PHONE -

ADDRESS 2286 GRAMM RD. CITY STOW STATE OH ZIP 44224

SSN - DATE OF BIRTH 08-02-44 DRIVER'S LICENSE NUMBER - STATE OH

OWNER #2 - NAME (Last, First, Middle) SAME AS DRIVER #2 PHONE -

ADDRESS - CITY - STATE - ZIP -

SSN - DATE OF BIRTH - DRIVER'S LICENSE NUMBER - STATE -

VEHICLE LICENSE # JBZ3498 STATE OH YEAR 11 MAKE FORD MODEL F-150 COLOR BLUE

INSURANCE COMPANY TRAVELER'S POLICY NUMBER 6005583572031

PARTS OF VEHICLE DAMAGED RIGHT REAR CONTRIBUTING CIRCUMSTANCES IMPROPER BACKING

DESCRIBE WHAT HAPPENED

UNIT #1 WAS PARKED, UNOCCUPIED ON THE FIRE HYDRANT SIDE OF IONA AVE. UNIT #2 IMPROPERLY BACKED OUT OF THE DRIVEWAY AT 3748 IONA AVE. AND STRUCK UNIT #1.

See Reverse Side for Diagram

SUBMITTED BY: SCHULZ 735 DATE 08-13-21

APPROVING OFFICER: [Signature] DATE 8-13-21

STOW POLICE DEPARTMENT

FIELD SKETCH (not drawn to scale)

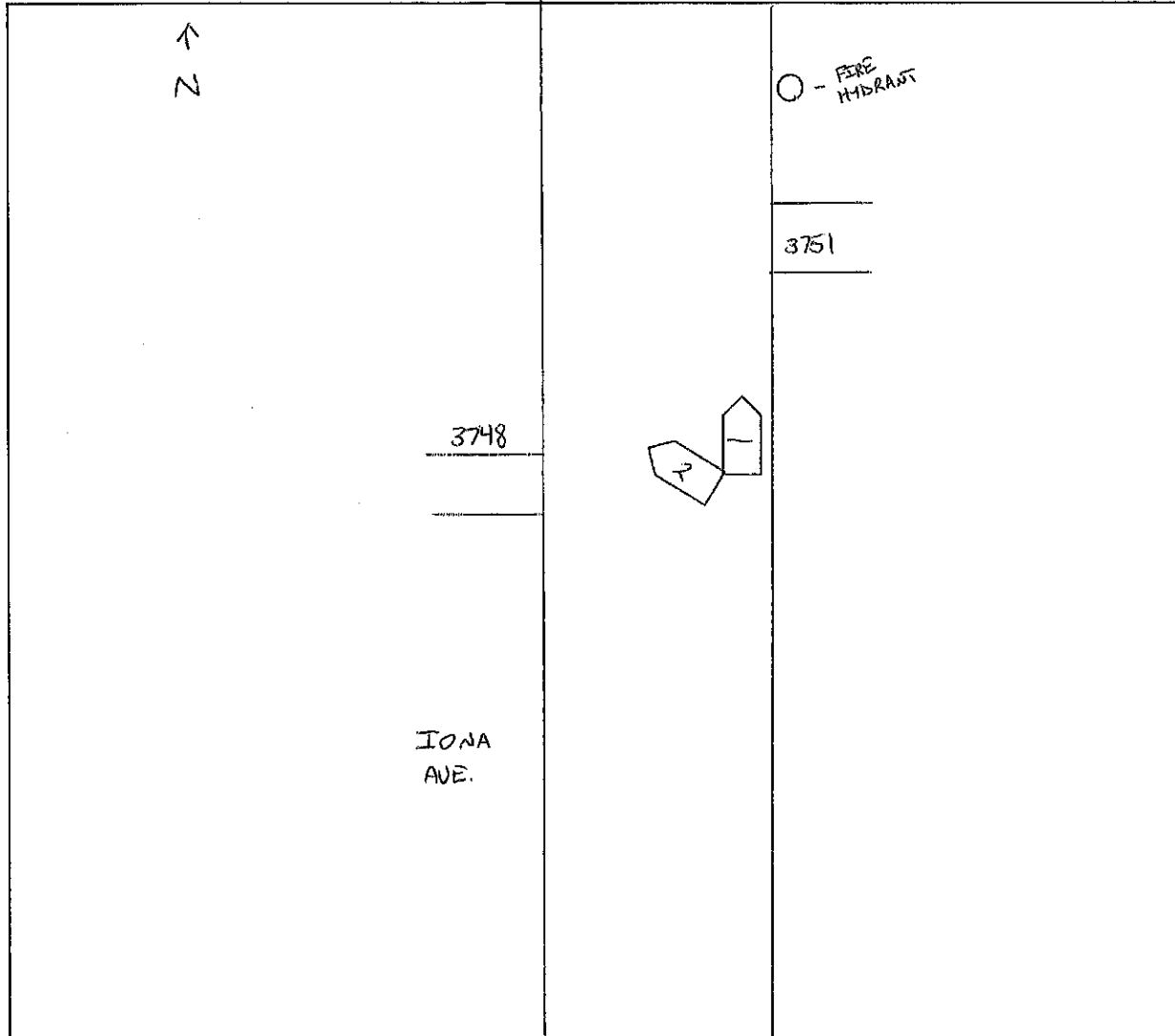

WEATHER

- CLEAR
- RAIN
- SNOW
- FOG
- OTHER

LIGHT

- DAYLIGHT
- DAWN
- DUSK
- DARK - LIGHTED ROAD
- DARK - NOT LIGHTED
- DARK - UNK LIGHTING
- UNKNOWN

SURFACE

- DRY
- WET
- SNOW
- ICE
- OTHER

ROAD

- CONCRETE
- BLACKTOP
- DIRT
- OTHER