



STOW POLICE DEPARTMENT

PRIVATE PROPERTY ACCIDENT REPORT/MINOR
TRAFFIC ACCIDENT REPORT

INCIDENT NUMBER
21-12574

DATE
8/6/2021

TIME
2206

Private Property Private Property - Hit/Skip Minor Traffic Accident

LOCATION - ADDRESS

3048 GRAHAM RD.

VEHICLE #1

DRIVER #1 - NAME (Last, First, Middle) PHONE
ENGLE, EVELYN MAE [REDACTED]

ADDRESS CITY STATE ZIP
4621 GRAFTON LN STOW OH 44224

SSN DATE OF BIRTH DRIVER'S LICENSE NUMBER STATE
[REDACTED] 7/18/2002 [REDACTED] OH

OWNER #1 - NAME (Last, First, Middle) SAME AS DRIVER #1 PHONE

ADDRESS CITY STATE ZIP

SSN DATE OF BIRTH DRIVER'S LICENSE NUMBER STATE

VEHICLE LICENSE# STATE YEAR MAKE MODEL COLOR
JKJ 2603 OH 2018 HYUNDAI ELANTRA BLUE

INSURANCE COMPANY POLICY NUMBER
STATE FARM 7325879 A16 35 F

PARTS OF VEHICLE DAMAGED CONTRIBUTING CIRCUMSTANCES
REAR BUMPER DRIVERS SIDE NONE

VEHICLE #2

DRIVER #2 - NAME (Last, First, Middle) PHONE
GRAY, TERESA L. [REDACTED]

ADDRESS CITY STATE ZIP
3000 GRAHAM RD Apt 415 STOW OH 44224

SSN DATE OF BIRTH DRIVER'S LICENSE NUMBER STATE
[REDACTED] 10/7/1958 [REDACTED] OH

OWNER #2 - NAME (Last, First, Middle) SAME AS DRIVER #2 PHONE

ADDRESS CITY STATE ZIP

SSN DATE OF BIRTH DRIVER'S LICENSE NUMBER STATE

VEHICLE LICENSE # STATE YEAR MAKE MODEL COLOR
M784310 OH 2021 Ford Eco Sport RED

INSURANCE COMPANY POLICY NUMBER
PROGRESSIVE 40809253

PARTS OF VEHICLE DAMAGED CONTRIBUTING CIRCUMSTANCES
REAR BUMPER DRIVER SIDE FAIL TO PUT VEHICLE IN PARK

DESCRIBE WHAT HAPPENED

UNIT 1 WAS PARKED DRIVERLESS IN THE PARKING LOT FACING EAST.
UNIT 2'S DRIVER PULLED THE VEHICLE INTO THE PARKING SPACE
ON THE OPPOSITE SIDE OF THE LOT FACING WEST. UNIT 2'S DRIVER
EXITED THE VEHICLE AND FAILED TO PUT THE VEHICLE IN PARK. UNIT
2, NOW DRIVERLESS, ROLLED EAST ACROSS THE LOT STRIKING UNIT 1.

See Reverse Side for Diagram

SUBMITTED BY: DATE
OFO GABEL 760 8/6/2021

APPROVING OFFICER: DATE
[Signature] 8-7-21

STOW POLICE DEPARTMENT

FIELD SKETCH (not drawn to scale)

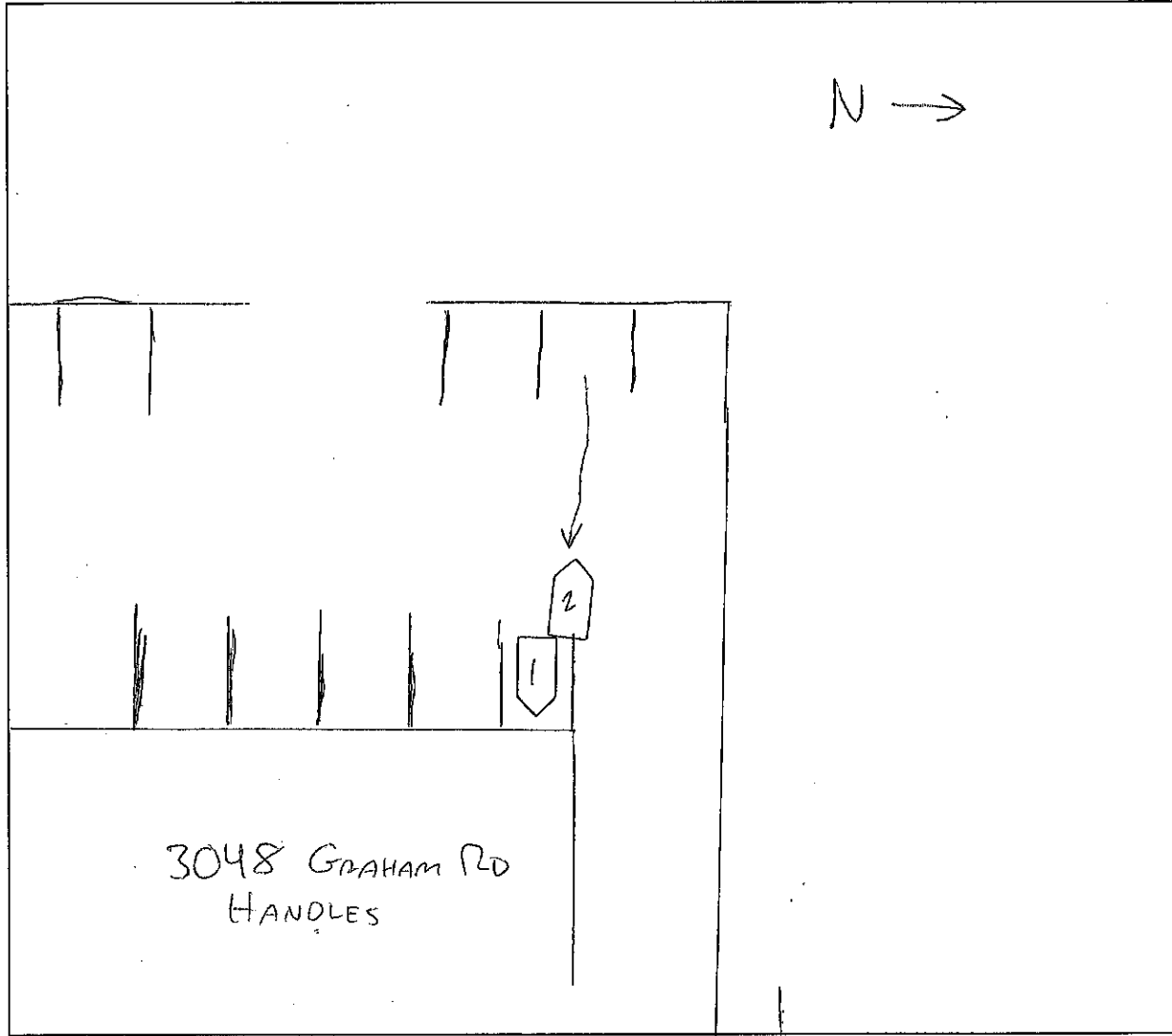

WEATHER

- CLEAR
- RAIN
- SNOW
- FOG
- OTHER

LIGHT

- DAYLIGHT
- DAWN
- DUSK
- DARK - LIGHTED ROAD
- DARK - NOT LIGHTED
- DARK - UNK LIGHTING
- UNKNOWN

SURFACE

- DRY
- WET
- SNOW
- ICE
- OTHER

ROAD

- CONCRETE
- BLACKTOP
- DIRT
- OTHER