



# STOW POLICE DEPARTMENT

PRIVATE PROPERTY ACCIDENT REPORT/MINOR  
TRAFFIC ACCIDENT REPORT

INCIDENT NUMBER

21-06844

DATE

5-5-21

TIME

1437

 Private Property  Private Property - Hit/Skip  Minor Traffic Accident

LOCATION - ADDRESS

Planet Fitness 835 Graham Rd.

DRIVER #1 - NAME (Last, First, Middle)

PHONE

ADDRESS

CITY

STATE

ZIP

SSN

DATE OF BIRTH

DRIVER'S LICENSE NUMBER

STATE

OWNER #1 - NAME (Last, First, Middle)  SAME AS DRIVER #1

PHONE

Jackson, Devon Terrell

ADDRESS

CITY

STATE

ZIP

818 Myrtle Ave.

Cuyahoga Falls

OH

44221

SSN

DATE OF BIRTH

DRIVER'S LICENSE NUMBER

STATE

12-24-94

OH

VEHICLE LICENSE#

STATE

YEAR

MAKE

MODEL

COLOR

HRU2307

OH

2019

Chevy

Silverado

white

INSURANCE COMPANY

POLICY NUMBER

Farmers

192804196

PARTS OF VEHICLE DAMAGED

CONTRIBUTING CIRCUMSTANCES

Right rear tailgate

DRIVER #2 - NAME (Last, First, Middle)

PHONE

Biswa, Om Prakash

ADDRESS

CITY

STATE

ZIP

3070 Meier Pl.

Cuyahoga Falls

OH

44221

SSN

DATE OF BIRTH

DRIVER'S LICENSE NUMBER

STATE

1-19-97

OH

OWNER #2 - NAME (Last, First, Middle)  SAME AS DRIVER #2

PHONE

Truck Bulls Transportation/Gulfstream Logistics, Inc.

ADDRESS

CITY

STATE

ZIP

314 Westwood Ct.

Vernon Hills

IL

60061

SSN

DATE OF BIRTH

DRIVER'S LICENSE NUMBER

STATE

VEHICLE LICENSE #

STATE

YEAR

MAKE

MODEL

COLOR

P1091446

IL

2018

Freightliner

Cascadia

Red

INSURANCE COMPANY

POLICY NUMBER

Core Pointe

CIC 1602224-00-N-T

PARTS OF VEHICLE DAMAGED

CONTRIBUTING CIRCUMSTANCES

Left rear of trailer

Driver inattention

DESCRIBE WHAT HAPPENED

Unit #1 was parked driverless in the parking lot of Planet Fitness facing west. Unit #2 was northbound through the parking lot driving a tractor-trailer. Unit #2 attempted to turn east in the main aisle side-swiped the rear tailgate of Unit #1. A witness saw Unit #2 hit Unit #1 and flee the scene.

See Reverse Side for Diagram

SUBMITTED BY:

Murphy #738

DATE

5-5-21

APPROVING OFFICER:

DATE

5-6-21

# STOW POLICE DEPARTMENT

## FIELD SKETCH (not drawn to scale)

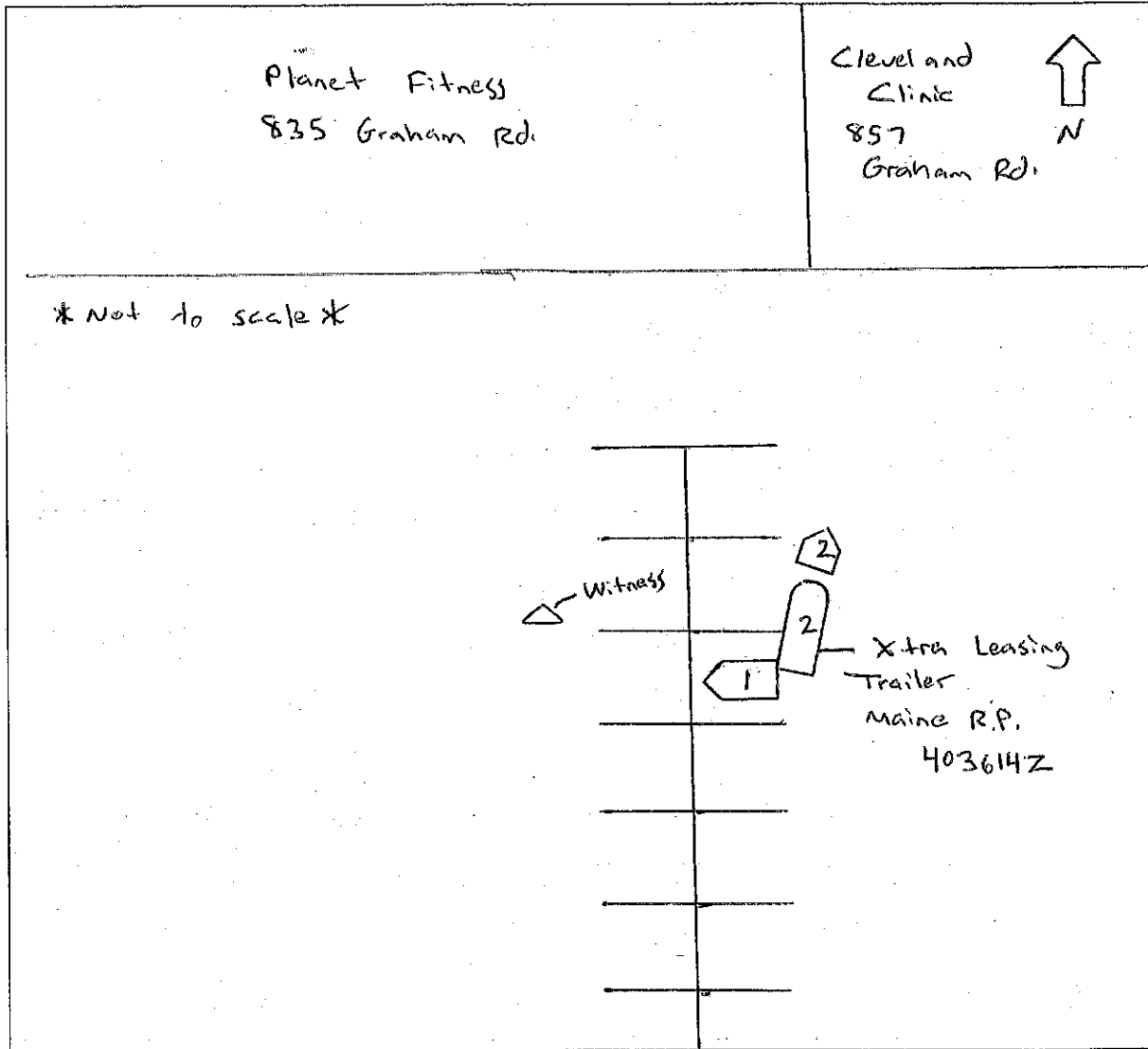

### WEATHER

- CLEAR
- RAIN
- SNOW
- FOG
- OTHER

### LIGHT

- DAYLIGHT
- DAWN
- DUSK
- DARK - LIGHTED ROAD
- DARK - NOT LIGHTED
- DARK - UNK LIGHTING
- UNKNOWN

### SURFACE

- DRY
- WET
- SNOW
- ICE
- OTHER

### ROAD

- CONCRETE
- BLACKTOP
- DIRT
- OTHER



LOCAL REPORT NUMBER 21-06844	REPORTING AGENCY Stow PD	DATE OF CRASH M 5   D 5   Y 21
---------------------------------	-----------------------------	-----------------------------------

FOR LOCAL USE ONLY - DO NOT SUBMIT TO THE STATE EXCEPT FOR FATAL CRASHES

I, Catherine Hill HEREBY MAKE THIS VOLUNTARY STATEMENT TO  
PRINTED  
Murphy AT 3892 Genevieve Blvd Stow Oh  
OFFICER'S NAME LOCATION

On Wednesday May 5<sup>th</sup> I was going into the Planet Fitness on Graham Rd. approx. 2:35 pm when I saw a tractor/trailer driving up an aisle towards Cleve. Clinic I watched him pause at the pillar of Cleve. Clinic while he was attempting to turn At that time there was a loud crunching noise where the back end of his trailer hit a white pick-up truck in the lot. He continued to drive on and I took a picture of the license plate I then proceeded to go into Planet Fitness and let them know what I saw

Q. Which way did he turn?

A. Right towards Lighthouse Pools

Q. What did the driver look like?

A. Skinny, around 30<sup>5</sup> dark skinned, not African/American maybe haitian or India

ADDRESS OF WITNESS 3892 Genevieve Blvd Stow Oh.	PHONE 216-630-1326
SIGNATURE OF WITNESS X Catherine Hill	OFFICER'S SIGNATURE X <i>[Signature]</i> #1738

## OHIO TRAFFIC ACCIDENT - DIAGRAM/NARRATIVE CONTINUATION

OH-2 (Rev. 1/82)

LOCAL REPORT NUMBER 21-06844	REPORTING AGENCY Stow PD	DATE OF ACCIDENT M 5   D 5   Y 21
IN COUNTY OF Summit	ACCIDENT LOCATION Planet Fitness 835 Graham Rd	
<p>I called Xtra Leasing and they advised the trailer GPS showed it was parked at Great Lakes Truck in Akron. I called Great Lakes and they advised the truck and trailer were still there and a male named Om Biswa dropped it off for service. The employee I spoke with went outside and took pictures of the truck and trailer. He emailed me the pictures and in one of them you can see a small amount of white paint transfer on the driver's side rear aluminum pillar of the trailer.</p> <p>I ran the name Om Biswa through LEADS and found a male that lived close by the crash scene that matched the description the witness gave. I went to his residence and he stated he was driving through the lot yesterday. He said he stopped for a few seconds to make sure he could make the turn and never noticed hitting anything.</p>		
OFFICERS SIGNATURE 		BADGE NO. #138