



STOW POLICE DEPARTMENT

PRIVATE PROPERTY ACCIDENT REPORT/MINOR TRAFFIC ACCIDENT REPORT

INCIDENT NUMBER
21-66685

DATE
5-3-21

TIME
6055

Private Property Private Property - Hit/Skip Minor Traffic Accident

LOCATION - ADDRESS

977 HERON SPRINGS

VEHICLE #1

DRIVER #1 - NAME (Last, First, Middle) **UNOCCUPIED** PHONE -

ADDRESS - CITY - STATE - ZIP -

SSN - DATE OF BIRTH - DRIVER'S LICENSE NUMBER - STATE -

OWNER #1 - NAME (Last, First, Middle) SAME AS DRIVER #1 PHONE -

LULLI, JOHN P.

ADDRESS **6509 MARSH RD. APT 727** CITY **MAYFIELD HTS.** STATE **OH** ZIP **44124**

SSN - DATE OF BIRTH **9-16-74** DRIVER'S LICENSE NUMBER - STATE **OH**

VEHICLE LICENSE# **HPE9912** STATE **OH** YEAR **2013** MAKE **HONDA** MODEL **CRV** COLOR **RED**

INSURANCE COMPANY **ERIE INS.** POLICY NUMBER **QOH 5115702**

PARTS OF VEHICLE DAMAGED **FRONT DRIVER SIDE** CONTRIBUTING CIRCUMSTANCES **N/A**

VEHICLE #2

DRIVER #2 - NAME (Last, First, Middle) **TYGER, JACKSON R.** PHONE -

ADDRESS **977 HERON SPRINGS PKWY** CITY **STOW** STATE **OH** ZIP **44224**

SSN - DATE OF BIRTH **6/7/2004** DRIVER'S LICENSE NUMBER - STATE -

OWNER #2 - NAME (Last, First, Middle) SAME AS DRIVER #2 PHONE -

TYGER, JENNIFER L.

ADDRESS - CITY - STATE - ZIP -

SSN - DATE OF BIRTH **8/20/74** DRIVER'S LICENSE NUMBER - STATE **OH**

VEHICLE LICENSE # **EZG6460** STATE **OH** YEAR **2010** MAKE **HONDA** MODEL **ACCORD** COLOR **BLACK**

INSURANCE COMPANY **SAFECO.** POLICY NUMBER **K3077512**

PARTS OF VEHICLE DAMAGED **ENTIRE PASSENGER SIDE** CONTRIBUTING CIRCUMSTANCES **IMPROPER BACKING**

DESCRIBE WHAT HAPPENED

UNIT 2 PARKED INSIDE GARAGE AT 977 HERON SPRINGS PKWY. UNIT 1 WAS PARKED UNOCCUPIED DIRECTLY OUTSIDE THE GARAGE. UNIT 2 DRIVER BACKED OUT OF THE GARAGE + STRUCK UNIT 1. UNIT 2 PROCEEDED IN REVERSE UNTIL UNIT 1 WAS PUSHED OUT OF THE WAY.

See Reverse Side for Diagram

SUBMITTED BY: **[Signature] #247**

APPROVING OFFICER: **[Signature]**

DATE **5/3/21**

DATE **5-3-21**

STOW POLICE DEPARTMENT

FIELD SKETCH (not drawn to scale)

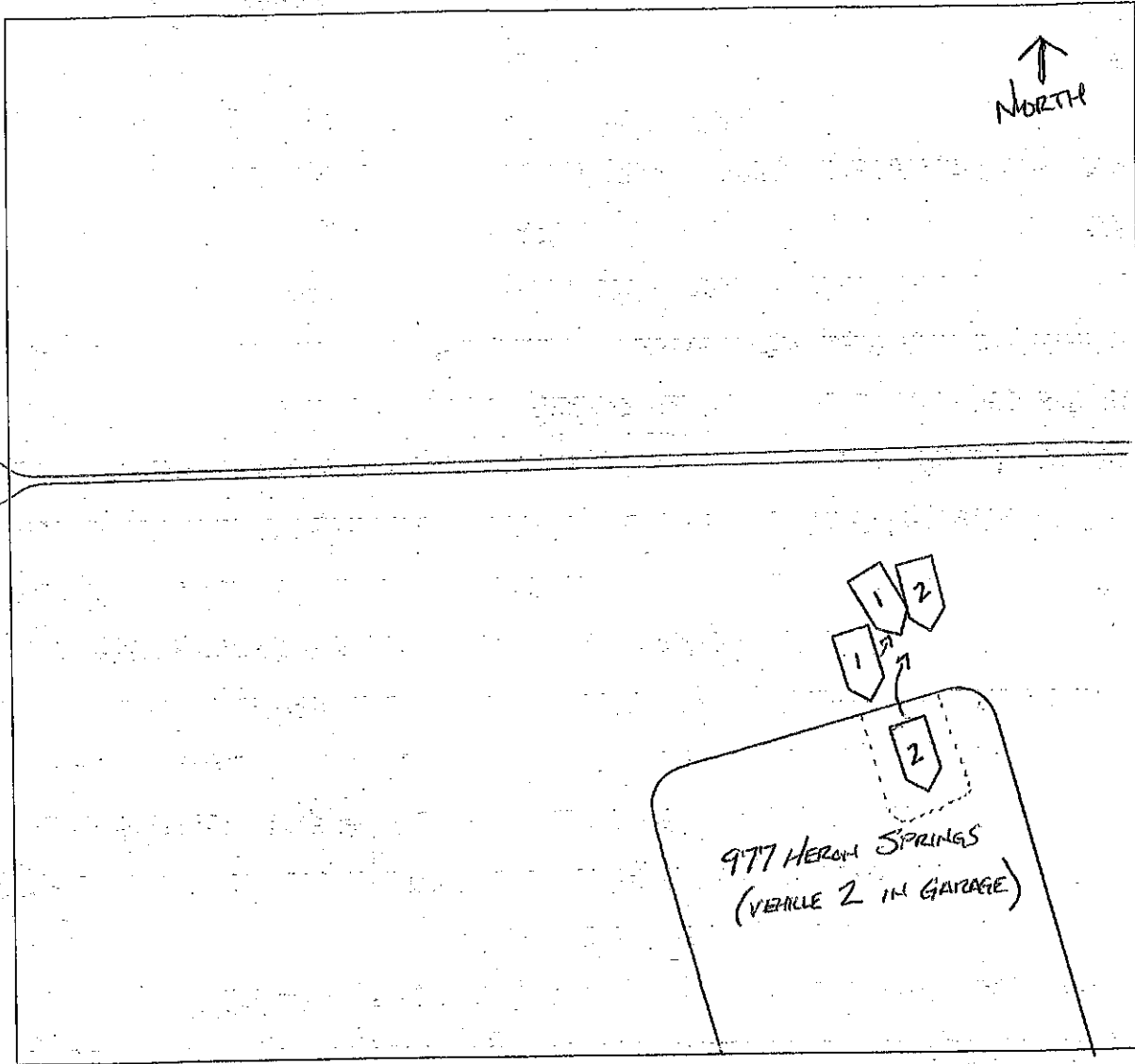

WEATHER

- CLEAR
- RAIN
- SNOW
- FOG
- OTHER

LIGHT

- DAYLIGHT
- DAWN
- DUSK
- DARK - LIGHTED ROAD
- DARK - NOT LIGHTED
- DARK - UNK LIGHTING
- UNKNOWN

SURFACE

- DRY
- WET
- SNOW
- ICE
- OTHER

ROAD

- CONCRETE
- BLACKTOP
- DIRT
- OTHER