



STOW POLICE DEPARTMENT

PRIVATE PROPERTY ACCIDENT REPORT/MINOR TRAFFIC ACCIDENT REPORT

INCIDENT NUMBER

21-5834

DATE

4-17-21

TIME

1733

 Private Property
 Private Property - Hit/Skip
 Minor Traffic Accident

LOCATION - ADDRESS

3101 GRAHAM RD.

DRIVER #1 - NAME (Last, First, Middle)

DEMARS, CHRISTOPHER B.

PHONE

ADDRESS

3800 DARROW RD.

CITY

STOW

STATE

OH

ZIP

44224

SSN

DATE OF BIRTH

DRIVER'S LICENSE NUMBER

STATE

OH

OWNER #1 - NAME (Last, First, Middle) SAME AS DRIVER #1

CITY OF STOW

PHONE

ADDRESS

3760 DARROW RD.

CITY

STOW

STATE

OH

ZIP

44224

SSN

DATE OF BIRTH

DRIVER'S LICENSE NUMBER

STATE

VEHICLE LICENSE#

4

STATE

OH

YEAR

17

MAKE

FORD

MODEL

TAURUS

COLOR

BLK

INSURANCE COMPANY

SELECTIVE INS. Co. of AMERICA

POLICY NUMBER

S2007145

PARTS OF VEHICLE DAMAGED

PASS. SIDE FRONT / LOWER QUARTER PANEL

CONTRIBUTING CIRCUMSTANCES

DRIVER INATTENTION

DRIVER #2 - NAME (Last, First, Middle)

PHONE

ADDRESS

CITY

STATE

ZIP

SSN

DATE OF BIRTH

DRIVER'S LICENSE NUMBER

STATE

OWNER #2 - NAME (Last, First, Middle) SAME AS DRIVER #2

PHONE

ADDRESS

CITY

STATE

ZIP

SSN

DATE OF BIRTH

DRIVER'S LICENSE NUMBER

STATE

VEHICLE LICENSE #

STATE

YEAR

MAKE

MODEL

COLOR

INSURANCE COMPANY

POLICY NUMBER

PARTS OF VEHICLE DAMAGED

CONTRIBUTING CIRCUMSTANCES

DESCRIBE WHAT HAPPENED

DEMARS WAS DRIVING E/B ON GRAHAM RD., TURNED INTO THE PARKING LOT OF 3101 GRAHAM RD, AND DROVE OVER A LARGE ROCK WITH THE PASSENGER SIDE FRONT END. THE VEHICLE WAS STUCK OFF THE GROUND, AND HAD TO BE LIFTED OFF WITH A TOW TRUCK. DEMARS WAS LOOKING AT THE MDT AND TURNED TOO SOON.

See Reverse Side for Diagram

SUBMITTED BY:

ISEL

DATE

4-23-21

APPROVING OFFICER:

TK

DATE

4-23-21

STOW POLICE DEPARTMENT

FIELD SKETCH (not drawn to scale)

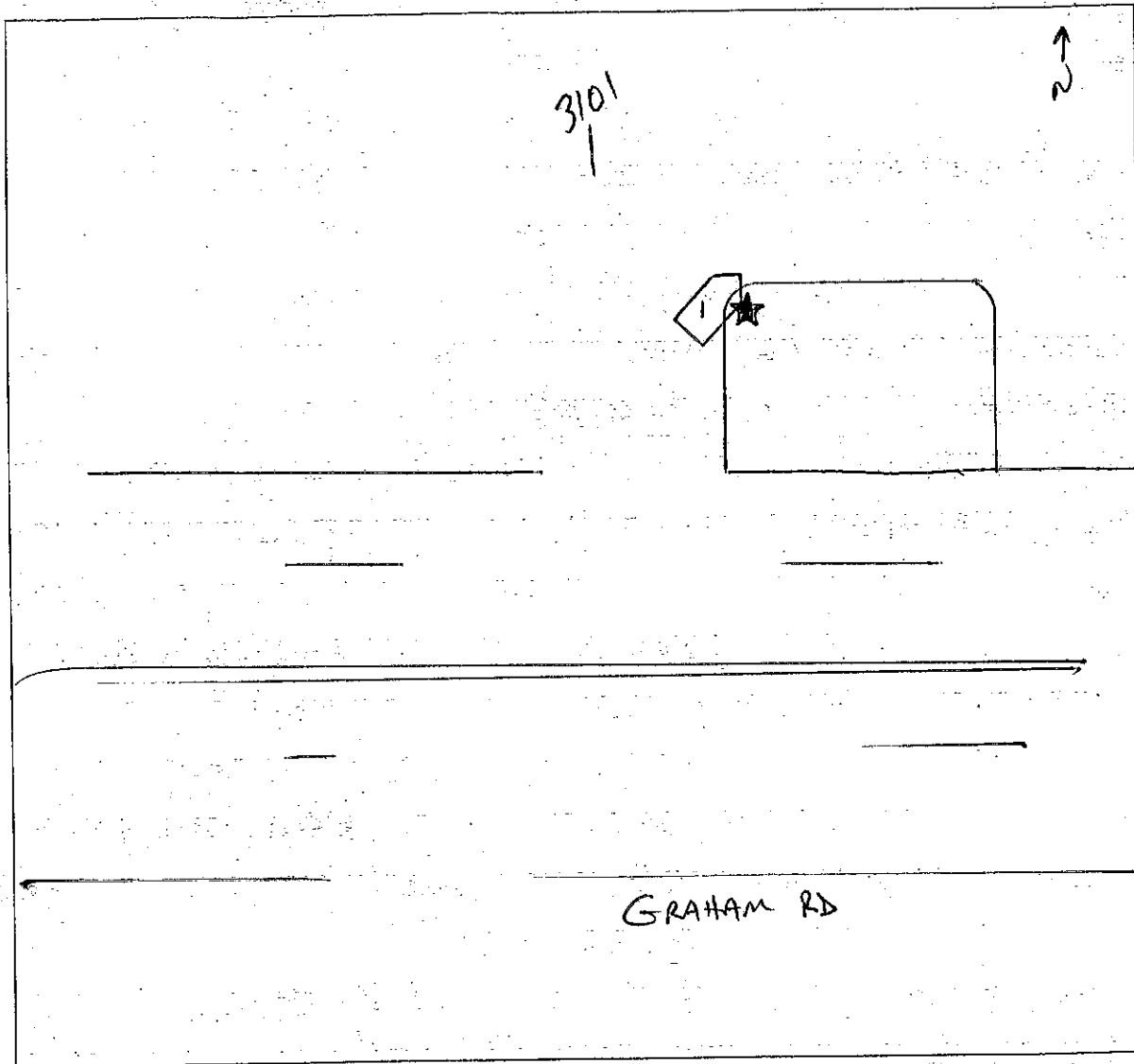

WEATHER

- CLEAR
- RAIN
- SNOW
- FOG
- OTHER

LIGHT

- DAYLIGHT
- DAWN
- DUSK
- DARK - LIGHTED ROAD
- DARK - NOT LIGHTED
- DARK - UNK LIGHTING
- UNKNOWN

SURFACE

- DRY
- WET
- SNOW
- ICE
- OTHER

ROAD

- CONCRETE
- BLACKTOP
- DIRT
- OTHER