



STOW POLICE DEPARTMENT

PRIVATE PROPERTY ACCIDENT REPORT/MINOR TRAFFIC ACCIDENT REPORT

INCIDENT NUMBER

26-10386

DATE

5/20/26

TIME

2346

 Private Property
 Private Property - Hit/Skip
 Minor Traffic Accident

LOCATION - ADDRESS

750 E. Steels Corner RD (Circle K)

DRIVER #1 - NAME (Last, First, Middle)

UNKNOWN

PHONE

ADDRESS

CITY

STATE

ZIP

SSN

DATE OF BIRTH

DRIVER'S LICENSE NUMBER

STATE

OWNER #1 - NAME (Last, First, Middle)

 SAME AS DRIVER #1

PHONE

ADDRESS

CITY

STATE

ZIP

SSN

DATE OF BIRTH

DRIVER'S LICENSE NUMBER

STATE

VEHICLE LICENSE#

STATE

YEAR

MAKE

MODEL

COLOR

White

INSURANCE COMPANY

POLICY NUMBER

PARTS OF VEHICLE DAMAGED

Left Side

CONTRIBUTING CIRCUMSTANCES

ACDA

DRIVER #2 - NAME (Last, First, Middle)

PHONE

ADDRESS

CITY

STATE

ZIP

SSN

DATE OF BIRTH

DRIVER'S LICENSE NUMBER

STATE

OWNER #2 - NAME (Last, First, Middle)

 SAME AS DRIVER #2

PHONE

ADDRESS

CITY

STATE

ZIP

SSN

DATE OF BIRTH

DRIVER'S LICENSE NUMBER

STATE

VEHICLE LICENSE #

STATE

YEAR

MAKE

MODEL

COLOR

INSURANCE COMPANY

POLICY NUMBER

PARTS OF VEHICLE DAMAGED

CONTRIBUTING CIRCUMSTANCES

DESCRIBE WHAT HAPPENED

Unit 7 was at the gas pumps at the listed location when Unit 1 went to leave, the left side of the box truck struck the pole knocking it over. Then driving off. No labels were seen on the truck by the witness and there was no plate on the vehicle either. Officers are waiting for video footage. Investigation pending.

See Reverse Side for Diagram

SUBMITTED BY:

DATE

5/22/26

APPROVING OFFICER:

DATE

5-22-26

STOW POLICE DEPARTMENT

FIELD SKETCH (not drawn to scale)

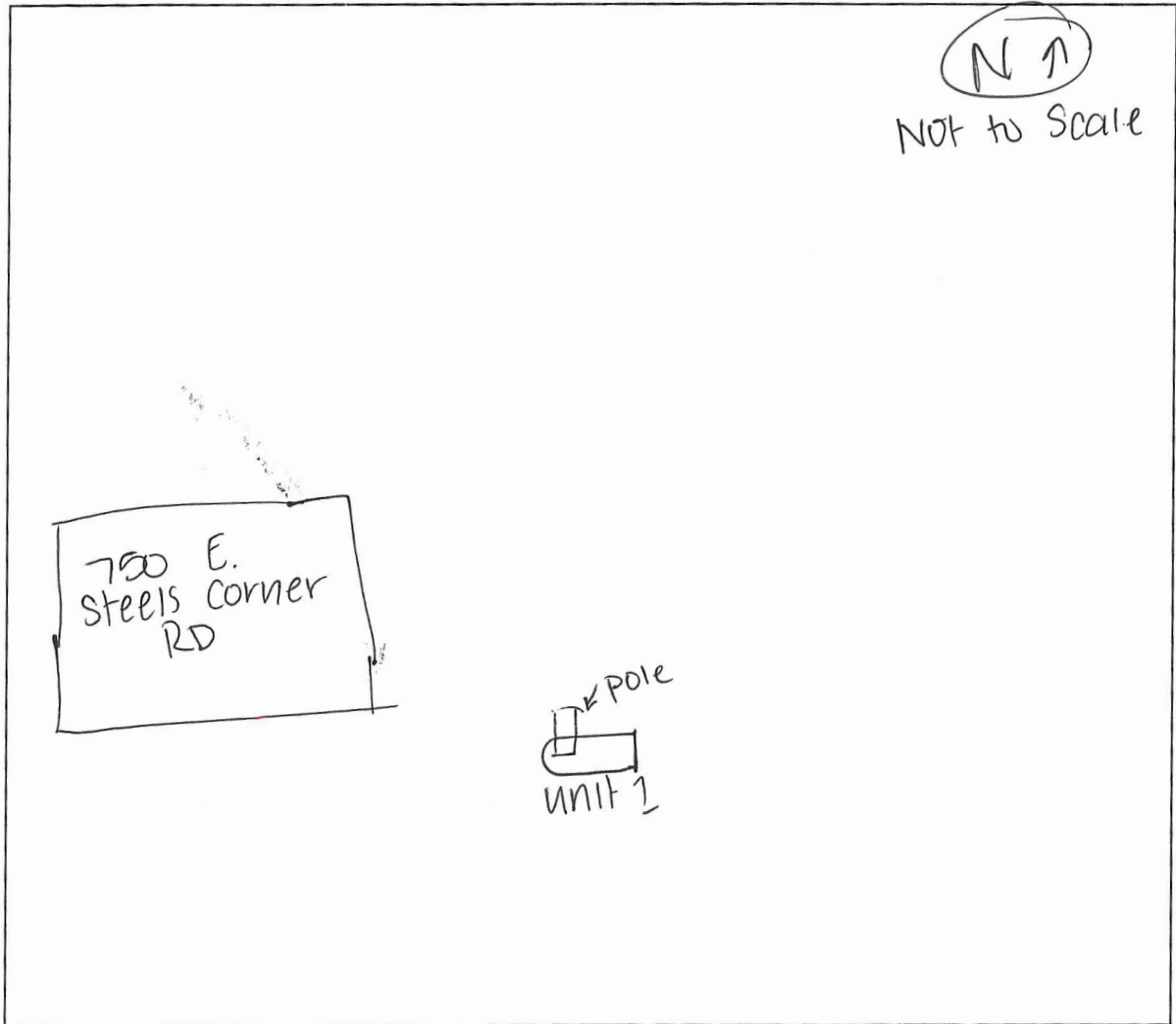

WEATHER

- CLEAR
- RAIN
- SNOW
- FOG
- OTHER

LIGHT

- DAYLIGHT
- DAWN
- DUSK
- DARK - LIGHTED ROAD
- DARK - NOT LIGHTED
- DARK - UNK LIGHTING
- UNKNOWN

SURFACE

- DRY
- WET
- SNOW
- ICE
- OTHER

ROAD

- CONCRETE
- BLACKTOP
- DIRT
- OTHER