



STOW POLICE DEPARTMENT

PRIVATE PROPERTY ACCIDENT REPORT/MINOR
TRAFFIC ACCIDENT REPORT

INCIDENT NUMBER

26-09366

DATE

05/01/2026

TIME

2140

 Private Property Private Property – Hit/Skip Minor Traffic

LOCATION - ADDRESS

3950 Kent Rd. Stow, OH 44224 (Spare Box)

DRIVER #1 – NAME (Last, First, Middle)
Copeland, Neil Edward

PHONE

419-651-7605

ADDRESS

1196 Marianna Cir.

CITY

Mansfield

STATE

OH

ZIP

44903

SSN

DATE OF BIRTH

04/22/1986

DRIVER'S LICENSE NUMBER

STATE

OH

VEHICLE #1

OWNER #1 – NAME (Last, First, Middle) SAME AS DRIVER #1

PHONE

ADDRESS

CITY

STATE

ZIP

SSN

DATE OF BIRTH

DRIVER'S LICENSE NUMBER

STATE

VEHICLE LICENSE#

V304831

STATE

OH

YEAR

2020

MAKE

Chevrolet

MODEL

Silverado 1500

COLOR

White

INSURANCE COMPANY

The General

POLICY NUMBER

OH8897521

PARTS OF VEHICLE DAMAGED

Damage to a ladder on a trailer attached to the truck

CONTRIBUTING CIRCUMSTANCES

Stopped under an exit gate

VEHICLE #2

DRIVER #2 – NAME (Last, First, Middle)

PHONE

ADDRESS

CITY

STATE

ZIP

SSN

DATE OF BIRTH

DRIVER'S LICENSE NUMBER

STATE

OWNER #2 – NAME (Last, First, Middle) SAME AS DRIVER #2

PHONE

ADDRESS

CITY

STATE

ZIP

SSN

DATE OF BIRTH

DRIVER'S LICENSE NUMBER

STATE

VEHICLE LICENSE #

STATE

YEAR

MAKE

MODEL

COLOR

INSURANCE COMPANY

POLICY NUMBER

PARTS OF VEHICLE DAMAGED

CONTRIBUTING CIRCUMSTANCES

DESCRIBE WHAT HAPPENED

Unit 1 was exiting the Spare Box storage facility behind another vehicle through an upright exit. The vehicle in front of Unit 1 stopped at Kent Rd. waiting for a break in traffic. This forced Unit 1 to stop behind the other vehicle. The ladder attached to the trailer being towed by Unit 1 was still under the upright exit gate. The exit gate closed onto the ladder. With the gate now resting on the ladder, Unit 1 traveled forward towards Kent Rd. This caused the gate to bend forward, damaging the gate.

Video evidence of the incident was entered into the Digital Media File.

See Reverse Side for Diagram

SUBMITTED BY:

Ofc. Gabel 760

DATE

05/10/2026

APPROVING OFFICER:

Sgt. Ginter, 710

DATE

5-10-26

STOW POLICE DEPARTMENT

FIELD SKETCH (not drawn to scale)

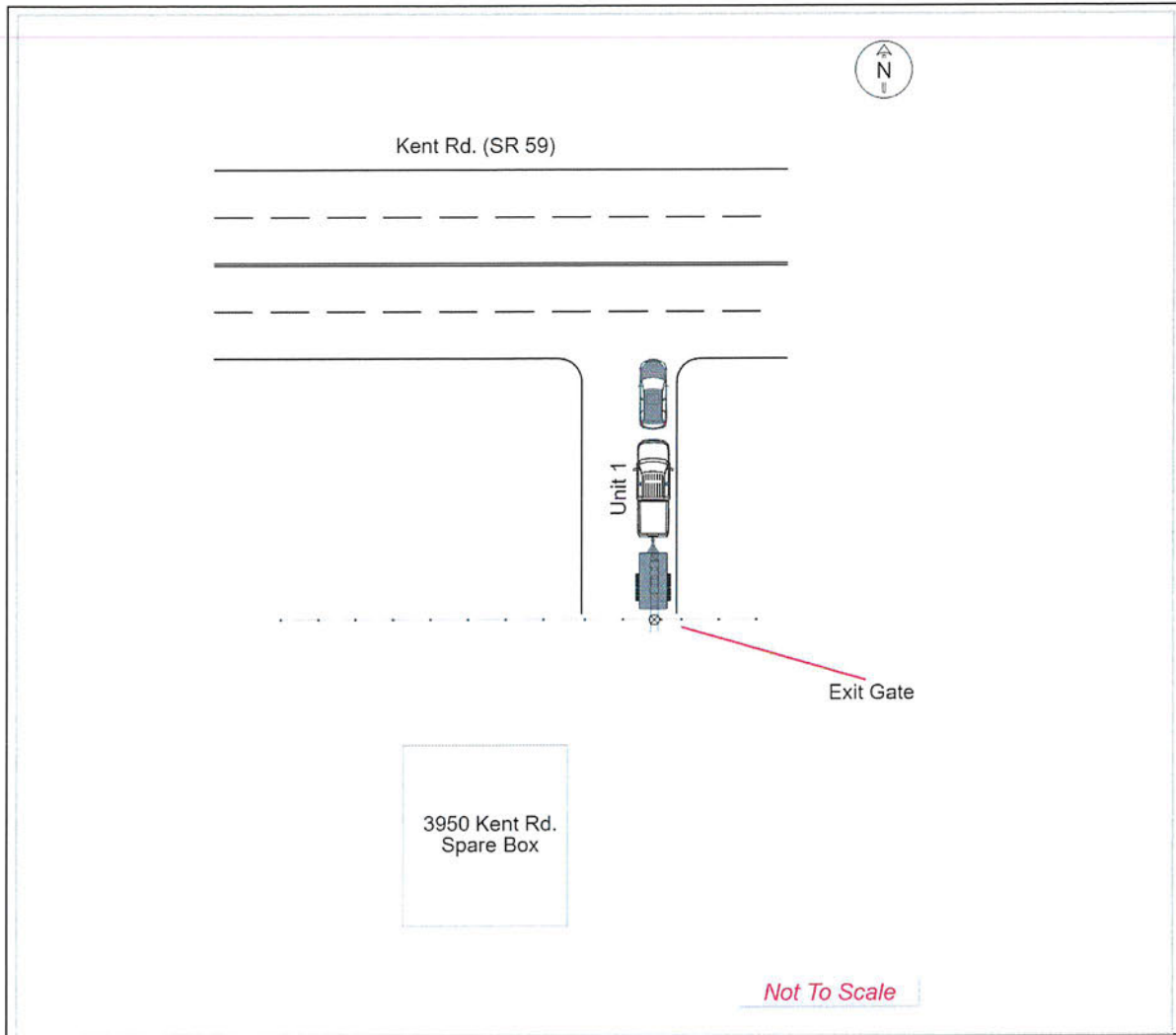

WEATHER

- CLEAR
- RAIN
- SNOW
- FOG
- OTHER

LIGHT

- DAYLIGHT
- DAWN
- DUSK
- DARK – LIGHTED ROAD
- DARK – NOT LIGHTED
- DARK – UNK LIGHTING
- UNKNOWN

SURFACE

- DRY
- WET
- SNOW
- ICE
- OTHER

ROAD

- CONCRETE
- BLACKTOP
- DIRT
- OTHER

LOCAL REPORT NUMBER 26-09366	REPORTING AGENCY STOW POLICE DEPARTMENT	DATE OF CRASH M 5 D 1 Y 2026
IN COUNTY OF SUMMIT	CRASH LOCATION 3950 Kent Rd. Stow, OH 44224 (Spare Box)	

Damaged Property: Automatic exit gate

Property Owner Information:

**Spare Box Storage
3950 Kent Rd.
Stow, OH 44224
330-355-9758**

OFFICER'S SIGNATURE X	BADGE NUMBER 760
---------------------------------	----------------------------