



STOW POLICE DEPARTMENT

PRIVATE PROPERTY ACCIDENT REPORT/MINOR TRAFFIC ACCIDENT REPORT

INCIDENT NUMBER: 26-09031
 DATE: 5/1/26
 TIME: 1258

Private Property Private Property - Hit/Skip Minor Traffic Accident

LOCATION - ADDRESS: Childtime 3101 Graham Rd Stow OH 44224

VEHICLE #1

DRIVER #1 - NAME (Last, First, Middle): Unoccupied
 PHONE: _____
 ADDRESS: _____ CITY: _____ STATE: _____ ZIP: _____
 SSN: _____ DATE OF BIRTH: _____ DRIVER'S LICENSE NUMBER: _____ STATE: _____

OWNER #1 - NAME (Last, First, Middle) SAME AS DRIVER #1: Amazon Logistics Inc
 PHONE: 216-245-9813
 ADDRESS: 24800 Miles Rd CITY: Warrensville Heights STATE: OH ZIP: 44128
 SSN: - DATE OF BIRTH: - DRIVER'S LICENSE NUMBER: - STATE: -

VEHICLE LICENSE # PLY8243 STATE OH YEAR 2023 MAKE Rivian MODEL EDV COLOR BLU
 INSURANCE COMPANY Old Republic POLICY NUMBER ALA 2015-78-26

PARTS OF VEHICLE DAMAGED: Front bumper CONTRIBUTING CIRCUMSTANCES: None

VEHICLE #2

DRIVER #2 - NAME (Last, First, Middle): Wier, Taryn J
 PHONE: 330-978-1790
 ADDRESS: 201 Columbine Ave CITY: Akron STATE: OH ZIP: 44312
 SSN: [REDACTED] DATE OF BIRTH: 11/15/01 DRIVER'S LICENSE NUMBER: [REDACTED] STATE: OH

OWNER #2 - NAME (Last, First, Middle) SAME AS DRIVER #2: Sullivan, Rachel L
 PHONE: 234-368-8461
 ADDRESS: 3342 Lodwick Dr NW Apt 2 CITY: Warren STATE: OH ZIP: 44485
 SSN: [REDACTED] DATE OF BIRTH: 9/22/78 DRIVER'S LICENSE NUMBER: [REDACTED] STATE: OH

VEHICLE LICENSE # KPG927A STATE OH YEAR 2014 MAKE Buick MODEL Encore COLOR SIL
 INSURANCE COMPANY Allstate POLICY NUMBER 926 677 687

PARTS OF VEHICLE DAMAGED: Rear bumper CONTRIBUTING CIRCUMSTANCES: Improper backing

DESCRIBE WHAT HAPPENED
 Veh#1, an Amazon delivery van, was parked facing north along the east edge of the parking lot at 3101 Graham Rd and it was unoccupied. Veh#2 was parked facing north in a parking spot to the north of Veh#1. Veh#2, not seeing Veh#1, backed out of their parking space. The rear of Veh#2 struck the front of Veh#1.

See Reverse Side for Diagram

SUBMITTED BY: P. Bl... #736 DATE: 5/1/26

APPROVING OFFICER: [Signature] DATE: 5/2/26

STOW POLICE DEPARTMENT

FIELD SKETCH (not drawn to scale)

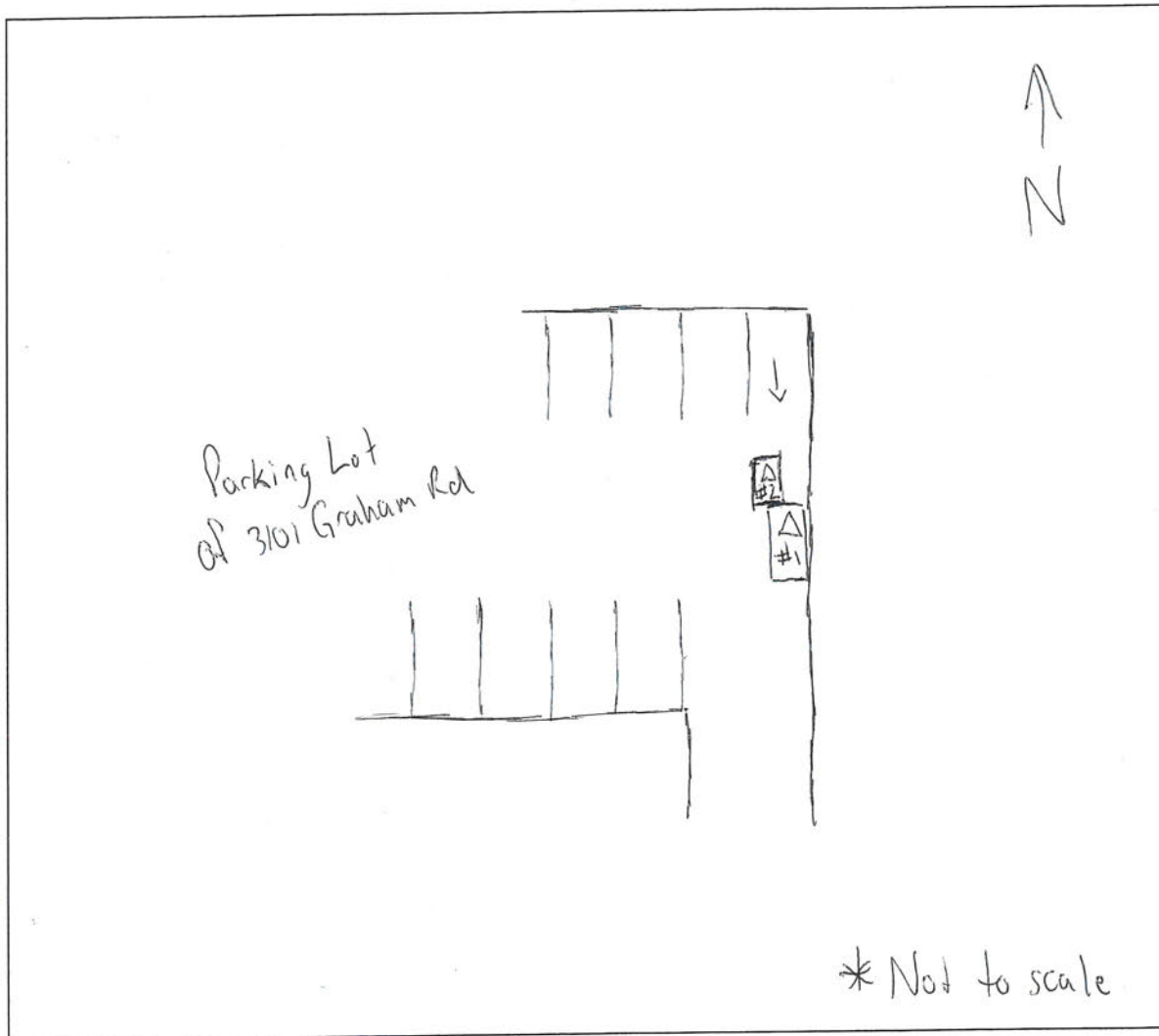

WEATHER

- CLEAR
- RAIN
- SNOW
- FOG
- OTHER

LIGHT

- DAYLIGHT
- DAWN
- DUSK
- DARK - LIGHTED ROAD
- DARK - NOT LIGHTED
- DARK - UNK LIGHTING
- UNKNOWN

SURFACE

- DRY
- WET
- SNOW
- ICE
- OTHER

ROAD

- CONCRETE
- BLACKTOP
- DIRT
- OTHER