



STOW POLICE DEPARTMENT

PRIVATE PROPERTY ACCIDENT REPORT/MINOR
TRAFFIC ACCIDENT REPORT

INCIDENT NUMBER
26-2621

DATE
02/10/2026

TIME
1416

Private Property Private Property - Hit/Skip Minor Traffic

LOCATION - ADDRESS
4332 KENT RD

VEHICLE #1

DRIVER #1 - NAME (Last, First, Middle) PARKED CAR				PHONE --			
ADDRESS --			CITY --		STATE --		ZIP --
SSN --		DATE OF BIRTH --		DRIVER'S LICENSE NUMBER --			STATE --
OWNER #1 - NAME (Last, First, Middle) <input type="checkbox"/> SAME AS DRIVER #1 TYMCHENKO, CAROL, ANN				PHONE			
ADDRESS 1970 THORNDALE AVE			CITY STOW		STATE OH		ZIP 44224
SSN [REDACTED]		DATE OF BIRTH 10/17/1968		DRIVER'S LICENSE NUMBER [REDACTED]			STATE OH
VEHICLE LICENSE# HSM1848		STATE OH	YEAR 2018	MAKE JEEP		MODEL RENEGADE	COLOR GREEN
INSURANCE COMPANY ALLSTATE			POLICY NUMBER 880 011 470				

PARTS OF VEHICLE DAMAGED: FRONT LEFT BUMPER CONTRIBUTING CIRCUMSTANCES: NONE

VEHICLE #2

DRIVER #2 - NAME (Last, First, Middle) SMEDI, OLIVIA, THERESA				PHONE 330-647-3432			
ADDRESS 3652 EDGEWOOD DR			CITY STOW		STATE OH		ZIP 44224
SSN [REDACTED]		DATE OF BIRTH 12/15/1989		DRIVER'S LICENSE NUMBER [REDACTED]			STATE OH
OWNER #2 - NAME (Last, First, Middle) <input checked="" type="checkbox"/> SAME AS DRIVER #2				PHONE --			
ADDRESS --			CITY --		STATE --		ZIP --
SSN --		DATE OF BIRTH --		DRIVER'S LICENSE NUMBER --			STATE --
VEHICLE LICENSE # JYY7492		STATE OH	YEAR 2019	MAKE CHEVY		MODEL SILVERADO	
INSURANCE COMPANY ERIE			POLICY NUMBER Q017406717				

PARTS OF VEHICLE DAMAGED: RIGHT REAR OF TRUCK BED CONTRIBUTING CIRCUMSTANCES: IMPROPER TURN

DESCRIBE WHAT HAPPENED
UNIT 1 WAS PARKED FACING EAST. UNIT 2 WAS PARKED TO THE NORTH OF UNIT 1, FACING THE SAME DIRECTION. UNIT 2 PULLED OUT OF THE PARKING SPACE, TURNING SOUTH AND TOOK THE TURN TOO SHARPLY, STRIKING UNIT 1.

See Reverse Side for Diagram

SUBMITTED BY:
PTL C MUSARRA 756

DATE
02/10/2026

APPROVING OFFICER:
SGT GINTHER, 715

DATE
02/10/2026

STOW POLICE DEPARTMENT

FIELD SKETCH (not drawn to scale)

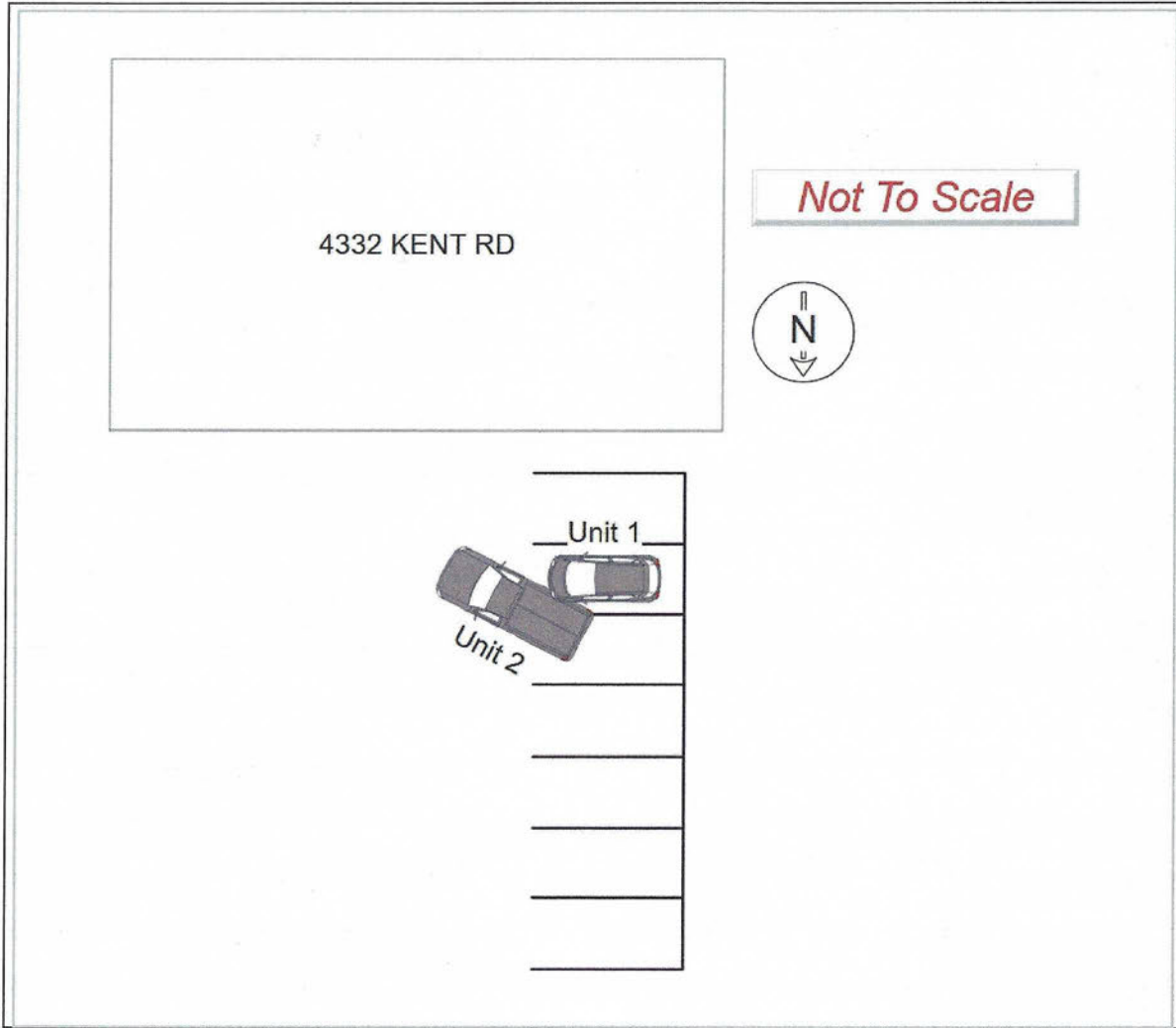

WEATHER

- CLEAR
- RAIN
- SNOW
- FOG
- OTHER

LIGHT

- DAYLIGHT
- DAWN
- DUSK
- DARK - LIGHTED ROAD
- DARK - NOT LIGHTED
- DARK - UNK LIGHTING
- UNKNOWN

SURFACE

- DRY
- WET
- SNOW
- ICE
- OTHER

ROAD

- CONCRETE
- BLACKTOP
- DIRT
- OTHER