



# STOW POLICE DEPARTMENT

## PRIVATE PROPERTY ACCIDENT REPORT/MINOR TRAFFIC ACCIDENT REPORT

INCIDENT NUMBER  
**21-01659**

DATE  
**2-7-21**

TIME  
**1426**

Private Property    Private Property - Hit/Skip    Minor Traffic Accident

LOCATION - ADDRESS  
**4338 Kent Road**

VEHICLE #1

DRIVER #1 - NAME (Last, First, Middle) **MESSENGER, MARY, GAY** PHONE [REDACTED]

ADDRESS **2506 INCOME DRIVE** CITY **Akron** STATE **OHIO** ZIP **44305**

SSN [REDACTED] DATE OF BIRTH **2-01-62** DRIVER'S LICENSE NUMBER [REDACTED] STATE **OHIO**

OWNER #1 - NAME (Last, First, Middle)  SAME AS DRIVER #1 PHONE [REDACTED]

ADDRESS [REDACTED] CITY [REDACTED] STATE [REDACTED] ZIP [REDACTED]

SSN [REDACTED] DATE OF BIRTH [REDACTED] DRIVER'S LICENSE NUMBER [REDACTED] STATE [REDACTED]

VEHICLE LICENSE# **ERR 1281** STATE **OH** YEAR **2013** MAKE **CHRY** MODEL **200** COLOR **Blue**

INSURANCE COMPANY **Allstate** POLICY NUMBER **826037975**

PARTS OF VEHICLE DAMAGED **PASS. front** CONTRIBUTING CIRCUMSTANCES **none**

VEHICLE #2

DRIVER #2 - NAME (Last, First, Middle) **Kunkle, Kelli, M** PHONE [REDACTED]

ADDRESS **467 CLEVELAND AVE.** CITY **Mogadore** STATE **OHIO** ZIP **44260**

SSN [REDACTED] DATE OF BIRTH **10/20/83** DRIVER'S LICENSE NUMBER [REDACTED] STATE **OHIO**

OWNER #2 - NAME (Last, First, Middle)  SAME AS DRIVER #2 PHONE [REDACTED]

ADDRESS [REDACTED] CITY [REDACTED] STATE [REDACTED] ZIP [REDACTED]

SSN [REDACTED] DATE OF BIRTH [REDACTED] DRIVER'S LICENSE NUMBER [REDACTED] STATE [REDACTED]

VEHICLE LICENSE # **FKK 6609** STATE **OH** YEAR **2016** MAKE **Ford** MODEL **Explorer** COLOR **White**

INSURANCE COMPANY **Allstate** POLICY NUMBER **826080416**

PARTS OF VEHICLE DAMAGED **REAR PASS.** CONTRIBUTING CIRCUMSTANCES **struck Unit #1**

DESCRIBE WHAT HAPPENED

**Unit #1 and Unit #2 were in the parking lot of 4338 Kent Road. Unit #2 was backing out of a parking spot and struck Unit #1.**

See Reverse Side for Diagram

SUBMITTED BY: **Tpt. R. Frisina #742** DATE **2-7-21**

APPROVING OFFICER: **Sgt. [Signature] 710** DATE **2/7/21**

# STOW POLICE DEPARTMENT

FIELD SKETCH (not drawn to scale)

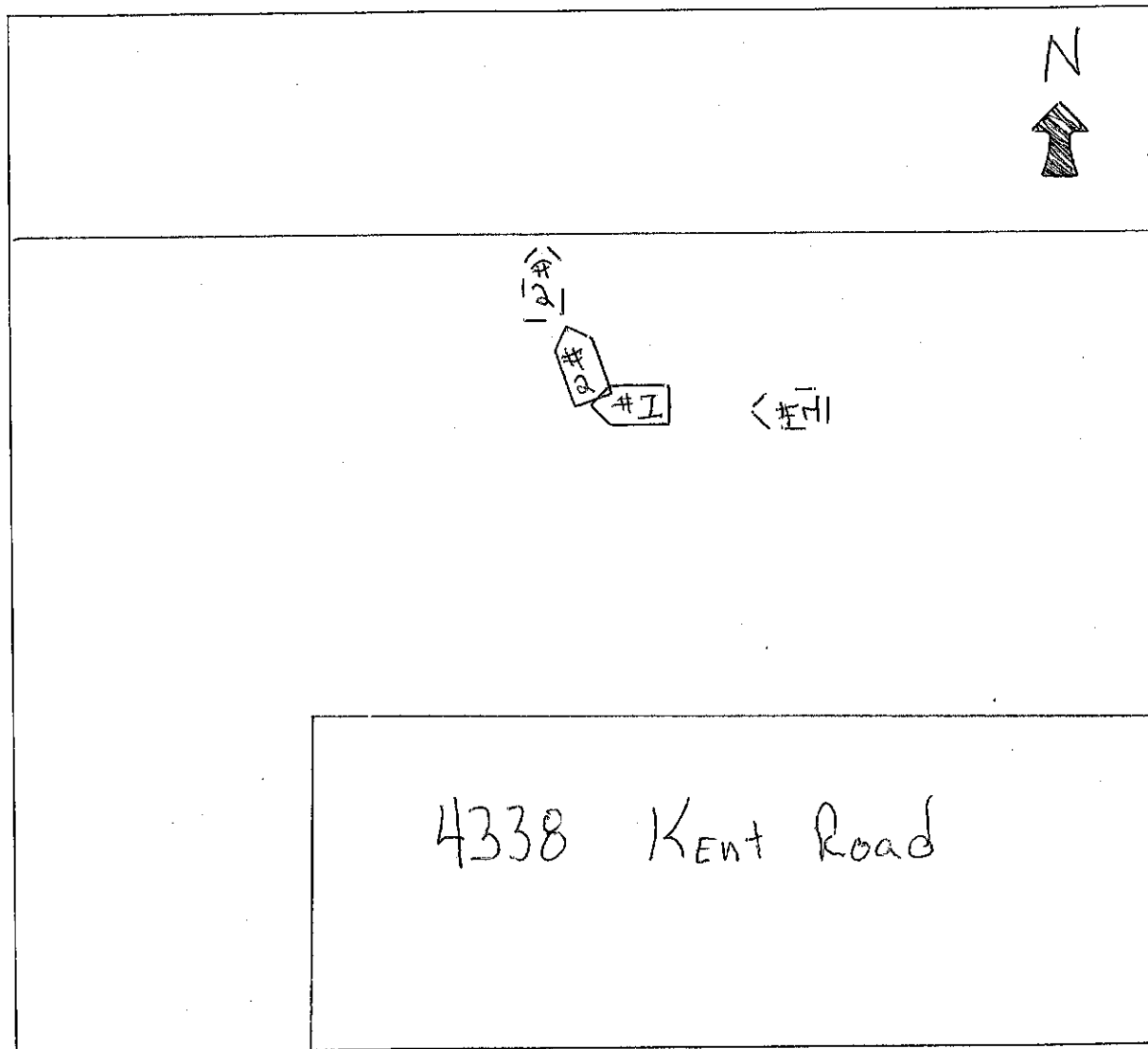

## WEATHER

- CLEAR
- RAIN
- SNOW
- FOG
- OTHER

## LIGHT

- DAYLIGHT
- DAWN
- DUSK
- DARK - LIGHTED ROAD
- DARK - NOT LIGHTED
- DARK - UNK LIGHTING
- UNKNOWN

## SURFACE

- DRY
- WET
- SNOW
- ICE
- OTHER

## ROAD

- CONCRETE
- BLACKTOP
- DIRT
- OTHER