



STOW POLICE DEPARTMENT

PRIVATE PROPERTY ACCIDENT REPORT/MINOR
TRAFFIC ACCIDENT REPORT

INCIDENT NUMBER

25-19125

DATE

11/7/25

TIME

1216

 Private Property
 Private Property - Hit/Skip
 Minor Traffic Accident

LOCATION - ADDRESS

3700 ENGLEWOOD DR

DRIVER #1 - NAME (Last, First, Middle)

DARVILLE, TREVOR C.

PHONE

216-618-5623

ADDRESS

7264 GLENSHIRE RD.

CITY

GARWOOD VILLAGE

STATE

OH

ZIP

44146

SSN

DATE OF BIRTH

2-5-1974

DRIVER'S LICENSE NUMBER

STATE

OH

VEHICLE #1

OWNER #1 - NAME (Last, First, Middle) SAME AS DRIVER #1

MEDICAL SERVICE CO.

PHONE

440-232-3000

ADDRESS

24000 BROADWAY AVE.

CITY

CLEVELAND

STATE

OH

ZIP

44146

SSN

DATE OF BIRTH

DRIVER'S LICENSE NUMBER

STATE

VEHICLE LICENSE#

U238605

STATE

GR

YEAR

2025

MAKE

FORD

MODEL

COMM. VAN

COLOR

WHT

INSURANCE COMPANY

TRUMBACE INS. CO.

POLICY NUMBER

81VENBR1PWL

PARTS OF VEHICLE DAMAGED

ROOF

CONTRIBUTING CIRCUMSTANCES

CLEARANCE

VEHICLE #2

DRIVER #2 - NAME (Last, First, Middle)

PHONE

ADDRESS

CITY

STATE

ZIP

SSN

DATE OF BIRTH

DRIVER'S LICENSE NUMBER

STATE

OWNER #2 - NAME (Last, First, Middle) SAME AS DRIVER #2

PHONE

ADDRESS

CITY

STATE

ZIP

SSN

DATE OF BIRTH

DRIVER'S LICENSE NUMBER

STATE

VEHICLE LICENSE #

STATE

YEAR

MAKE

MODEL

COLOR

INSURANCE COMPANY

POLICY NUMBER

PARTS OF VEHICLE DAMAGED

CONTRIBUTING CIRCUMSTANCES

DESCRIBE WHAT HAPPENED

UNIT # 1 WESTBOUND THROUGH PARKING LOT.

UNIT # 1 DROVE BENEATH OVERHANG AND LIGHTLY
SCRAPPED FROM LACK OF CLEARANCE.NOTE: NEWLY ERECTED OVERHANG, NO SIGNAGE POSTED
INDICATING MAX HEIGHT FOR CLEARANCE.

See Reverse Side for Diagram

SUBMITTED BY:

OPC [Signature]

DATE

11/7/25

APPROVING OFFICER:

[Signature]

DATE

11-08-25

STOW POLICE DEPARTMENT

FIELD SKETCH (not drawn to scale)

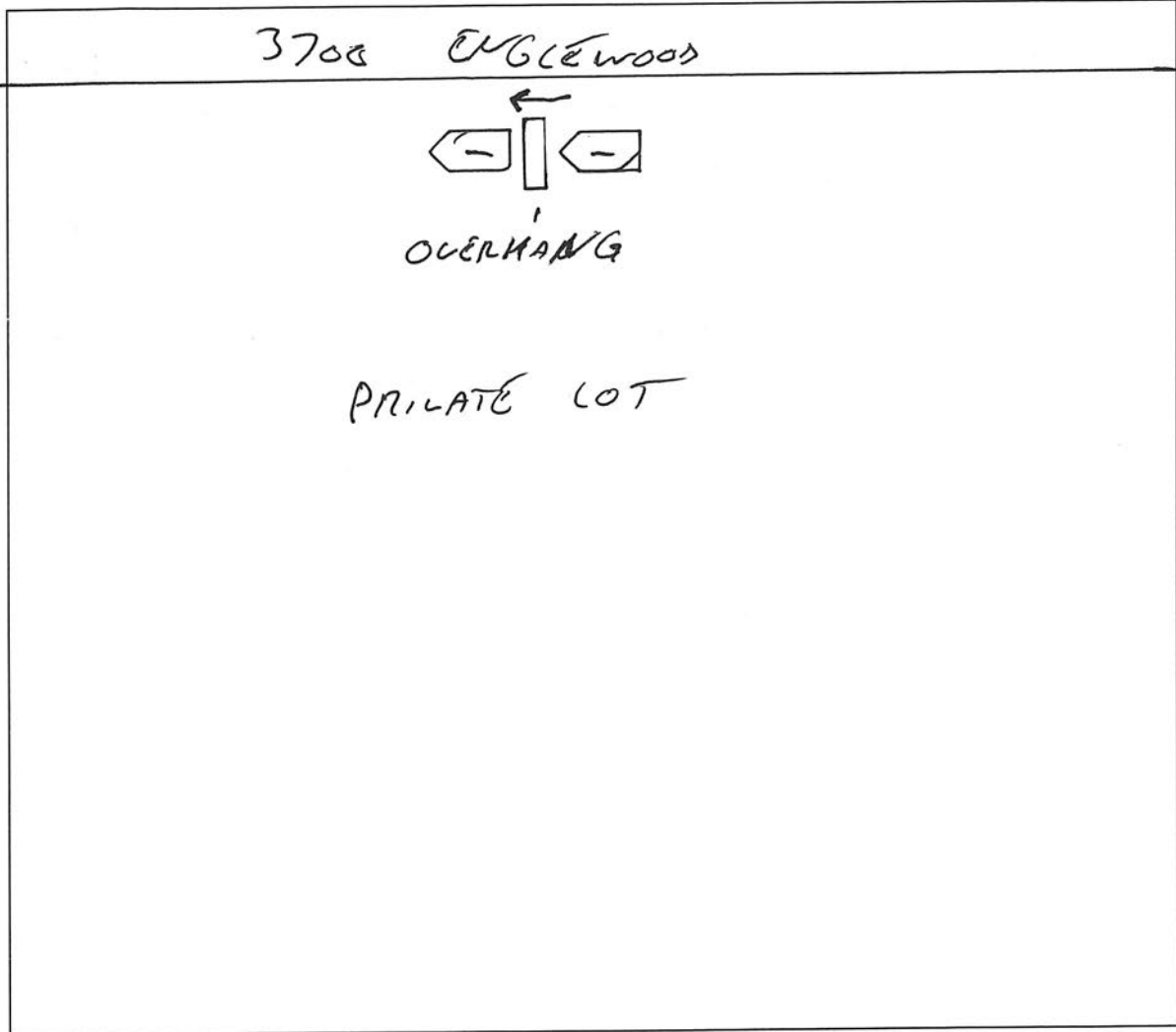

WEATHER

- CLEAR
- RAIN
- SNOW
- FOG
- OTHER

LIGHT

- DAYLIGHT
- DAWN
- DUSK
- DARK - LIGHTED ROAD
- DARK - NOT LIGHTED
- DARK - UNK LIGHTING
- UNKNOWN

SURFACE

- DRY
- WET
- SNOW
- ICE
- OTHER

ROAD

- CONCRETE
- BLACKTOP
- DIRT
- OTHER