



# STOW POLICE DEPARTMENT

PRIVATE PROPERTY ACCIDENT REPORT/MINOR  
TRAFFIC ACCIDENT REPORT

INCIDENT NUMBER  
**25-17514**

DATE  
**10-13-25**

TIME  
**1528**

Private Property    Private Property - Hit/Skip    Minor Traffic Accident

LOCATION - ADDRESS  
**4290 KENT RD**

VEHICLE #1

DRIVER #1 - NAME (Last, First, Middle) **McCLINTOCK, DEBRA** PHONE **440-364-8796**

ADDRESS **987 Northeast Ave** CITY **TALLMADGE** STATE **OH** ZIP **44278**

SSN [REDACTED] DATE OF BIRTH **11-10-67** DRIVER'S LICENSE NUMBER [REDACTED] STATE **OH**

OWNER #1 - NAME (Last, First, Middle)  SAME AS DRIVER #1 **McCLINTOCK, CHARLES** PHONE **"**

ADDRESS **"** CITY **"** STATE **"** ZIP **"**

SSN [REDACTED] DATE OF BIRTH **12-30-66** DRIVER'S LICENSE NUMBER [REDACTED] STATE **OH**

VEHICLE LICENSE# **ATWOLV** STATE **OH** YEAR **2014** MAKE **SUBARU** MODEL **Outback** COLOR **White**

INSURANCE COMPANY **Sonnenberg Mutual Ins** POLICY NUMBER **SSV 3402526998**

PARTS OF VEHICLE DAMAGED **FRONT P/S BUMPER** CONTRIBUTING CIRCUMSTANCES **N/A**

VEHICLE #2

DRIVER #2 - NAME (Last, First, Middle) **SPALDING, RYAN** PHONE **216-777-9598**

ADDRESS **2483 Eaton Rd.** CITY **University Hts** STATE **OH** ZIP **44118**

SSN [REDACTED] DATE OF BIRTH **2-13-05** DRIVER'S LICENSE NUMBER [REDACTED] STATE **OH**

OWNER #2 - NAME (Last, First, Middle)  SAME AS DRIVER #2 **KERR, BETSY** PHONE **216-333-3008**

ADDRESS **2195 Cranston Rd.** CITY **University Hts** STATE **OH** ZIP **44118**

SSN [REDACTED] DATE OF BIRTH **2-20-70** DRIVER'S LICENSE NUMBER [REDACTED] STATE **OH**

VEHICLE LICENSE # **KGM1151** STATE **OH** YEAR **2018** MAKE **CHEV** MODEL **CRUZE** COLOR **LT. BLUE**

INSURANCE COMPANY **NATIONWIDE** POLICY NUMBER **92345078417**

PARTS OF VEHICLE DAMAGED **FRONT D/S BUMPER** CONTRIBUTING CIRCUMSTANCES **FTY**

DESCRIBE WHAT HAPPENED

**- UNIT 1 NORTHBOUND THROUGH PARKING AISLE**  
**UNIT 2 FAILED TO YIELD EXITING FROM A SPACE**  
**AND WAS STRUCK BY UNIT 1.**

See Reverse Side for Diagram

SUBMITTED BY: **[Signature]** DATE **10-13-25**

APPROVING OFFICER: **Sgt. Olesinski #713** DATE **10/13/25**

# STOW POLICE DEPARTMENT

FIELD SKETCH (not drawn to scale)

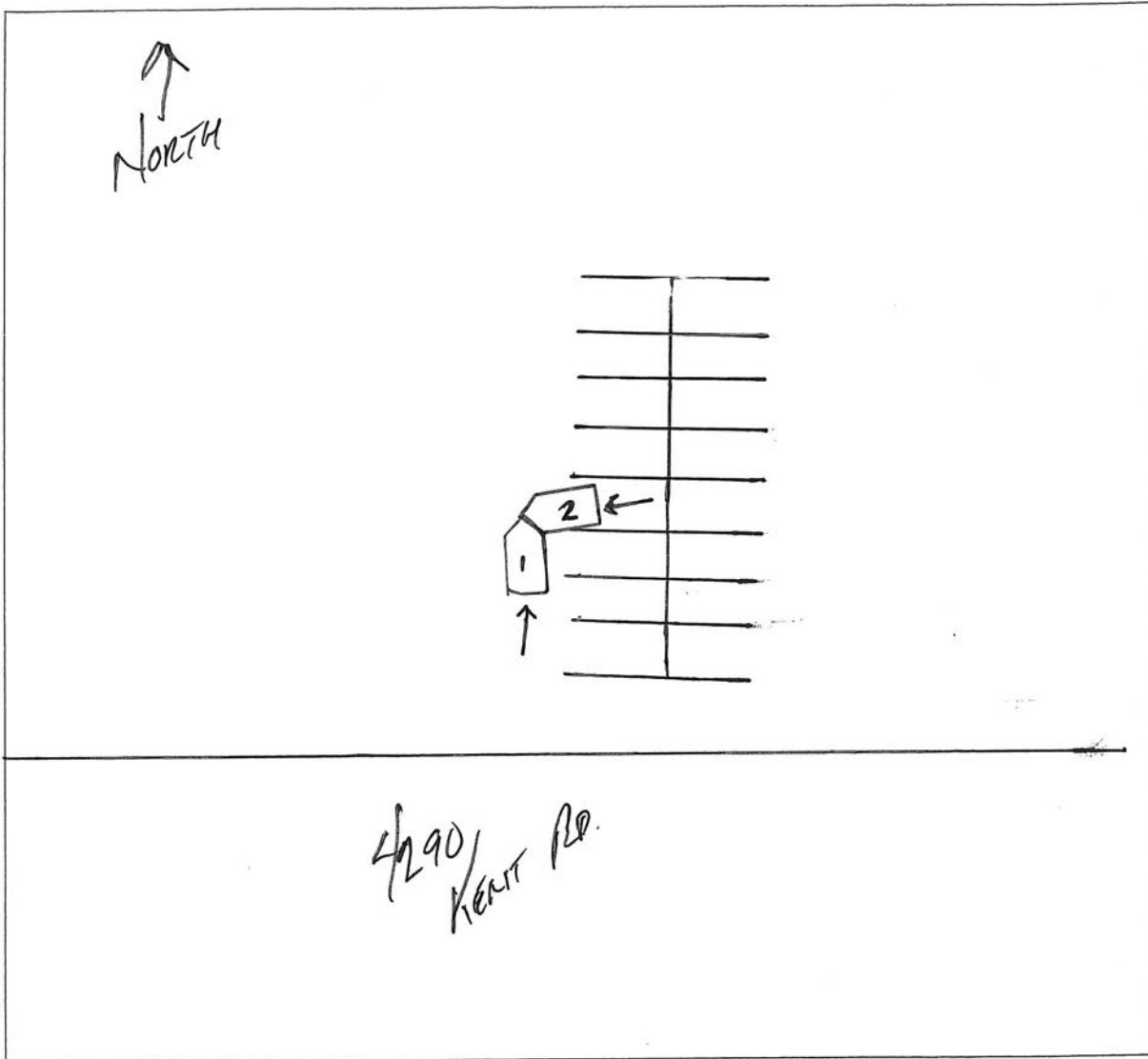

## WEATHER

- CLEAR
- RAIN
- SNOW
- FOG
- OTHER

## LIGHT

- DAYLIGHT
- DAWN
- DUSK
- DARK - LIGHTED ROAD
- DARK - NOT LIGHTED
- DARK - UNK LIGHTING
- UNKNOWN

## SURFACE

- DRY
- WET
- SNOW
- ICE
- OTHER

## ROAD

- CONCRETE
- BLACKTOP
- DIRT
- OTHER