



# STOW POLICE DEPARTMENT

PRIVATE PROPERTY ACCIDENT REPORT/MINOR  
TRAFFIC ACCIDENT REPORT

INCIDENT NUMBER  
**20-06347**

DATE  
**4-26-20**

TIME  
**1351**

Private Property    Private Property - Hit/Skip    Minor Traffic Accident

LOCATION - ADDRESS  
**4802 LAWSON DR.**

VEHICLE #1

DRIVER #1 - NAME (Last, First, Middle) **KARMAN, SAMUEL** PHONE [REDACTED]

ADDRESS: **29 FOX TRACE LN.** CITY **HUDSON** STATE **OH** ZIP **44236**

SSN [REDACTED] DATE OF BIRTH **3/19/2000** DRIVER'S LICENSE NUMBER [REDACTED] STATE **OH**

OWNER #1 - NAME (Last, First, Middle)  SAME AS DRIVER #1 **KARMAN, CHRISTOPHER J.** PHONE [REDACTED]

ADDRESS **29 FOX TRACE LN.** CITY **HUDSON** STATE **OH** ZIP **44236**

SSN [REDACTED] DATE OF BIRTH **12/23/68** DRIVER'S LICENSE NUMBER [REDACTED] STATE **OH**

VEHICLE LICENSE # **GIND9080** STATE **OH** YEAR **2012** MAKE **FORD** MODEL **ESCAPE** COLOR **WHITE**

INSURANCE COMPANY **WESTFIELD INS. CO.** POLICY NUMBER **WNE 5245745**

PARTS OF VEHICLE DAMAGED **FRONT BUMPER** CONTRIBUTING CIRCUMSTANCES **VEHICLE NOT PUT IN PARK.**

VEHICLE #2

DRIVER #2 - NAME (Last, First, Middle) [REDACTED] PHONE [REDACTED]

ADDRESS [REDACTED] CITY [REDACTED] STATE [REDACTED] ZIP [REDACTED]

SSN [REDACTED] DATE OF BIRTH [REDACTED] DRIVER'S LICENSE NUMBER [REDACTED] STATE [REDACTED]

OWNER #2 - NAME (Last, First, Middle)  SAME AS DRIVER #2 [REDACTED] PHONE [REDACTED]

ADDRESS [REDACTED] CITY [REDACTED] STATE [REDACTED] ZIP [REDACTED]

SSN [REDACTED] DATE OF BIRTH [REDACTED] DRIVER'S LICENSE NUMBER [REDACTED] STATE [REDACTED]

VEHICLE LICENSE # [REDACTED] STATE [REDACTED] YEAR [REDACTED] MAKE [REDACTED] MODEL [REDACTED] COLOR [REDACTED]

INSURANCE COMPANY [REDACTED] POLICY NUMBER [REDACTED]

PARTS OF VEHICLE DAMAGED [REDACTED] CONTRIBUTING CIRCUMSTANCES [REDACTED]

DESCRIBE WHAT HAPPENED

**UNIT 1, WHILE MAKING A DOORDASH DELIVERY, PULLED IN THE DRIVEWAY OF 4802 LAWSON. DRIVER DID NOT PUT VEHICLE IN PARK WHEN THEY EXITED. VEHICLE ROLLED INTO THE CLOSED GARAGE DOOR OF THAT RESIDENCE.**

**PROPERTY OWNER: ALEX POPOVICH**

[REDACTED]

See Reverse Side for Diagram

SUBMITTED BY: **Det. Myers #747** DATE **4/26/20**

APPROVING OFFICER: **Det. SW. Miller #73** DATE **04/26/20**

# STOW POLICE DEPARTMENT

## FIELD SKETCH (not drawn to scale)

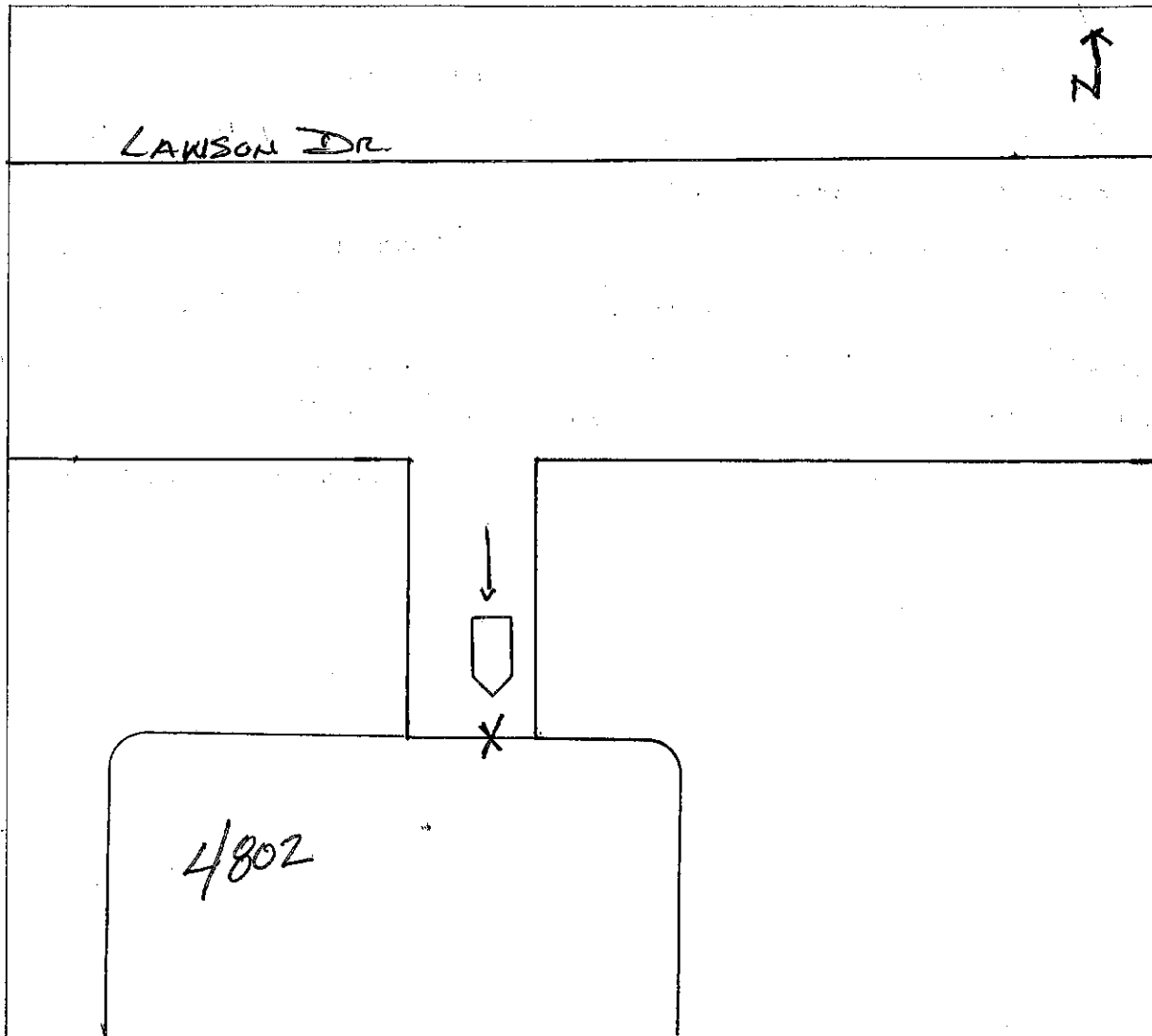

### WEATHER

- CLEAR
- RAIN
- SNOW
- FOG
- OTHER

### LIGHT

- DAYLIGHT
- DAWN
- DUSK
- DARK - LIGHTED ROAD
- DARK - NOT LIGHTED
- DARK - UNK LIGHTING
- UNKNOWN

### SURFACE

- DRY
- WET
- SNOW
- ICE
- OTHER

### ROAD

- CONCRETE
- BLACKTOP
- DIRT
- OTHER